

Vertical Contact Bun Toaster



Intertek
5009704



Intertek
5009704

CONFORMS TO UL STD. 197
CONFORMS TO NSF/ANSI STD. 4

Model: 184BT18A, 184BT18AXL, 184BT18H, 184BT18HXL

10/2022

Please read and keep these instructions. Indoor use only.

Table of Contents

Safety.....	3
Installation	4
Operating Instructions.....	6
Conveyor Adjustment	7
Cleaning and Maintenance	7
Dimensions	8
Troubleshooting	9

Safety

When using electrical appliances, basic safety precautions should always be followed, including the following:

1. Read all instructions carefully and completely.
2. For commercial use only.
3. DO NOT touch hot surfaces.
4. Protect against electrical shock by keeping all cords, plugs, and other electrical components away from water or other liquids.
5. Unplug this unit when not in use and before cleaning.
6. Allow the unit to cool before putting on or taking off parts.
7. DO NOT operate this or any appliance with a damaged electrical cord or plug.
8. DO NOT operate this or any appliance after it has malfunctioned or has been damaged in any way.
9. DO NOT use outdoors.
10. DO NOT place on or near a hot gas or electric burner.
11. Attach plug to appliance first, then plug electrical cord into the wall outlet.
12. Disconnect the unit by removing the electrical plug from the wall outlet.
13. DO NOT use appliance for any application other than intended use.
14. DO NOT insert metal utensils or oversized foods into this unit, as they may cause a fire and heighten the risk of electrical shock.
15. DO NOT store any item on top of this unit when in operation.
16. DO NOT allow this toaster to touch or to be covered by flammable material, such as curtains, draperies, walls, etc., when in operation.
17. DO NOT clean with metal scouring pads, as pieces can break off and touch electrical components, heightening the risk of electrical shock.
18. Never place materials such as paper, cardboard, plastic, etc. in this toaster.
19. DO NOT cover interior of this unit with metal foil, as it may cause the toaster to overheat.
20. Avoid scratching the surface or nicking the edges of this unit. If the toaster is damaged or broken, contact customer service before use.
21. Turn off the appliance by removing the plug from the wall outlet.
22. Note that the use of accessories not recommended by the manufacturer may result in injury.
23. Children should be supervised to ensure that they DO NOT play with the toaster.
24. This appliance is not intended for use by persons (including children) with reduced physical sensory or mental capabilities, or lack of experience and knowledge, unless a person responsible for their safety has given them supervision or instruction concerning use of the appliance.
25. When using the appliance in shops, snack bars, hotels, etc., check the voltage and outlet to make sure the appliance is correctly connected with power.
26. Place unit on a flat surface that is well ventilated. The appliance must be supervised during operation. DO NOT leave appliance without powering off.

NOTE: Save these instructions for future reference.

Examine carton for damage. The freight carrier has assumed responsibility for its safe transit and delivery. If equipment is received damaged, either apparent or concealed, a claim must be made with delivering carrier.

- A. Apparent damage or loss must be noted on the freight bill at the time of delivery. The carrier representative (Driver) must sign the freight bill. If this is not done, the carrier may refuse the claim. The carrier can supply the necessary forms.
- B. Concealed damage or loss if not apparent until after the toaster is removed from the carton, a request for inspection must be made to the carrier within 15 days. The carrier should arrange an inspection. Be sure to save all contents and packaging material.

Installation

Assembly and Conveyor Installation

The feed tray, adjustable feet, and the conveyor cassette are packed separately in the box and need to be assembled to the unit as per the instructions below.

1. Lay the unit on its side and screw the adjustable feet into position using the threaded holes provided. Hand tighten the legs by gripping the steel shank and turning until it is seated firmly against the bottom of the toaster. Set the toaster upright on a flat and level surface. The unit can then be levelled using the adjustable part of the leg.

NOTE: THE UNIT MUST NOT BE USED WITHOUT THE FEET BEING IN POSITION.

2. Remove the butter roller (2a) by pushing the shaft to the right to disengage from the drive socket.
3. Remove the butter pan (3a) by lifting off the locating pins.
4. Remove the top panel (1a) using the two black knobs provided to lift up and slightly **backwards**.
See diagram A.
5. The bottom panel (4a) can now be removed. Hold the top edge with one hand and pull straight back. Hold the bottom with the other hand and lift up and towards the front. Slide the panel down and out below the butter roller bushes.
6. Install the cleaned conveyor cassette (8a). Refer to specific cleaning instructions (page 7) as follows. Grasp the conveyor cassette by the handles provided and place the locating pins into the adjustable hanger brackets. Push the conveyor cassette forwards **gently to engage the drive gear. See diagram B. The cassette assembly height bolt is preset from the factory. If the cassette gear does not make adequate contact, or is binding with the drive gear, tighten or loosen the height bolt to ensure proper contact.**

NOTE: CARE MUST BE TAKEN IN FITTING THE CONVEYOR CASSETTE. THE CASSETTE IS HEAVY AND IT IS IMPORTANT THAT IT IS NOT DROPPED INTO PLACE TO AVOID POTENTIAL DAMAGE TO THE DRIVE GEARS.

7. Replace the bottom panel (4a), the top panel (1a), the butter pan (3a) and the butter roller (2a) in **that order**.
8. Install the bun feeder chute by feeding the slots on each side onto the back panel studs.

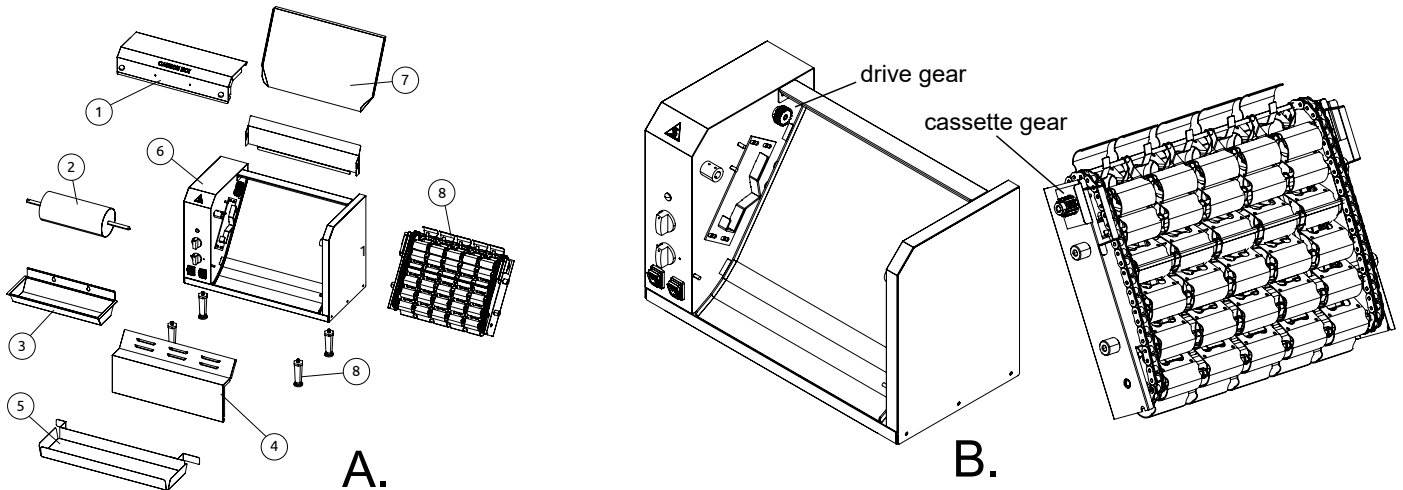

Installation of Non-stick Sheet

NOTE: IT IS HIGHLY RECOMMENDED THAT YOU INSTALL THE NON-STICK SHEET FOR BEST PERFORMANCE. EVERY UNIT IS SHIPPED WITH (10) NON-STICK SHEETS. PLEASE CONTACT CUSTOMER SERVICE IF YOU DID NOT RECEIVE THESE UNITS. IF YOU DO NOT INSTALL THE NON-STICK SHEET, THERE IS A RISK THAT BUNS WILL STICK TO THE PLATE AND BURN. BY NOT USING THE NON-STICK SHEET, YOU MAY VOID THE WARRANTY.

1. Lay the non-stick sheet on a flat surface and measure approximately 2" from the end of the sheet. Notch the corners at 45 degrees as needed (note: some non-stick sheets may already have notched corners) and fold a flap 2" long. Carefully crease the flap at the 2" fold.
2. Remove the bun feeder chute (7a). From the rear of the non-stick sheet retainer bracket (1c), slip the 2" fold under the bracket. Bring the balance of the sheet forwards and smooth the sheet down against the grill plate. See Diagram C.
3. Reinstall the feeder shoot.

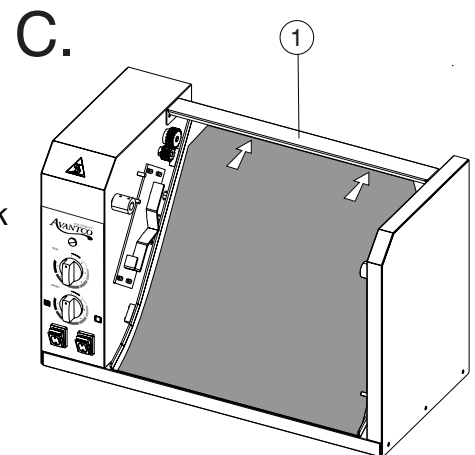

NOTE: THE NON-STICK SHEET SHOULD BE INSTALLED PRIOR TO FITTING THE CONVEYOR CASSETTE AS DESCRIBED ABOVE. IT IS RECOMMENDED THAT A LIGHT COATING OF EDIBLE OIL IS APPLIED TO THE GRILL PLATE PRIOR TO FITTING THE NON-STICK SHEET

Operating Instructions

1. Thoroughly clean the unit as described in the cleaning section of this manual.
2. Turn on the main switch. The conveyor will now run.
3. Set the temperature to approx. 400°F, which is between 6 and 7 on the scale. If using the optional non-stick sheet, it is advisable to increase the temperature setting to approx. 450°F, which equates to 6.5 on the scale (1-85°F, 2-140°F, 3-200°F, 4-285°F, 5-350, 6-410°F, 7-480°F).
4. Set the conveyor speed between 4 and 6 to start. The color of the bun is affected by the speed of the conveyor. The faster the conveyor, the lighter the color; the slower the conveyor, the darker the color. See diagram D.
5. Any high-quality edible oil can be used with this bun toaster. It is preferable to use oil specifically suited for use in toasters.

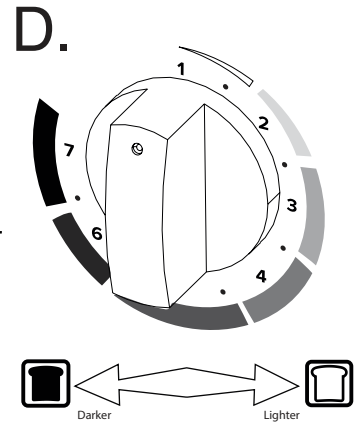

NOTE: USING TOO LITTLE OIL WILL CAUSE THE BUN SURFACE TO BE COOL AND UNEVEN IN COLOR. IT WILL ALSO CAUSE THE BUN TO STICK TO THE GRILL. USING TOO MUCH OIL WILL GIVE THE BUN A YELLOW UN-TOASTED LOOK.

6. The pilot cycle works with the heating element and indicates when the heater is on. It is preferable to wait until the unit has reached operating temperature and the light has cycled on and off twice. Heat up time is about 15-20 minutes for 208/240V, and about 20-30 minutes for 120V models.

NOTE: TRY SEVERAL BUNS TO DETERMINE THE CORRECT PRESSURE, TEMPERATURE, AND TIME TO ACHIEVE THE DESIRED BROWNING OF BUN.

7. Heat the toaster oil to melting point and carefully fill the butter tray 2/3 full. Turn on the butter roller using the switch provided.
8. Hold the bun half in the palm of the hand and in one motion slide the sliced side of the bun onto the butter roller. Drop the bun with the sliced surface towards the grill plate using the feeder chute provided. See diagram E.
9. The toasted bun will drop out into the receiving tray at the bottom of the unit.



NOTE: THE TOASTED COLOUR OF THE BUN CAN BE ADJUSTED LIGHTER OR DARKER BY USING THE TEMPERATURE CONTROL OR THE SPEED CONTROL OR A COMBINATION OF BOTH. WHEN OPTIMAL BUN COLOUR AND SPEED HAVE BEEN ACHIEVED IT IS RECOMMENDED A NOTE IS TAKEN OF THE SETTINGS FOR FUTURE REFERENCE.

NOTE: SHOULD THE TEMPERATURE SETTING BE CHANGED, ALLOW SEVERAL CYCLES FOR THE PLATE TO ADJUST.

Conveyor Adjustment

If optimal bun grilling is not achieved using the speed and temperature settings, it is possible to adjust the position of the conveyor system relative to the grill plate. Moving the conveyor closer to the grill plate will apply more pressure to the bun and result in more effective toasting.

1. Switch off the unit and allow to cool down.
2. Remove the butter roller and tray and feed chute.
3. Remove the top panel and the bottom panel.
4. Remove the conveyor cassette carefully by lifting up and pulling towards the front

NOTE: THE CONVEYOR IS HEAVY AND MUST BE HANDLED CAREFULLY.

5. The hanger adjustment brackets will now be exposed. Loosen the brackets and move them EQUALLY towards the grill plate in increments of 1/8". See diagram F.
6. Retighten the bracket screws.
7. Adjust the drive gear engagement as needed with the bolts at the bottom of the hanger plate. Ensure that the lock nuts are retightened.

Cleaning and Maintenance

NOTE: THE UNIT MUST BE DISCONNECTED FROM THE POWER SOURCE AND ALLOWED TO COOL DOWN BEFORE CLEANING TAKES PLACE.

1. All of the removable panels can be cleaned either in a sink with hot water and detergent or placed in a dishwasher.
2. It is recommended the conveyor cassette is only cleaned in a sink with regular detergent. Make sure the chains are lubricated after cleaning with a suitable toaster oil.
3. The grill plate can be cleaned with a suitable grill plate scourer. After drying, a light film of toaster oil should be applied.

NOTE: IT IS RECOMMENDED THAT THIS NON-STICK SHEET IS THEN REPLACED EVERY 30 DAYS, OR WHEN BUNS START STICKING, WHICHEVER COMES FIRST

NOTE: THE CONVEYOR MUST STAY CLEAN TO OPTIMIZE SPEED AND BUN TEMPERATURE

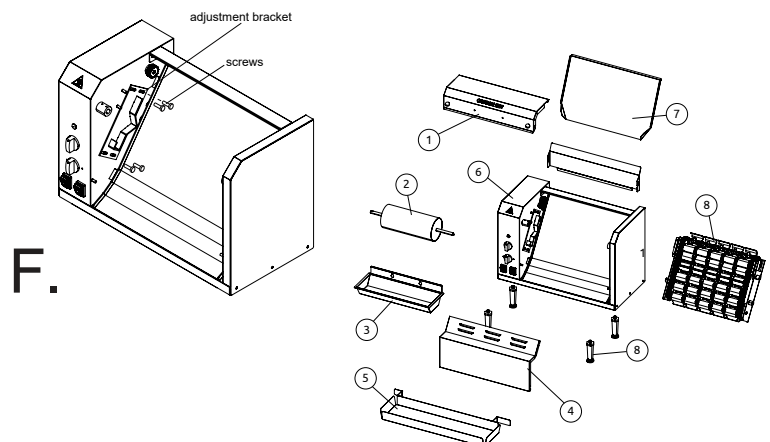

Dimensions

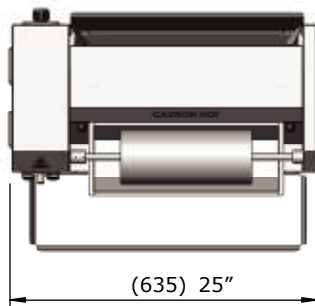
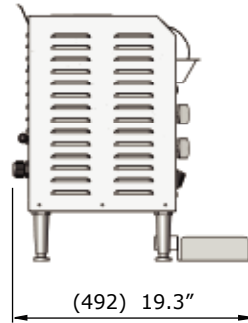
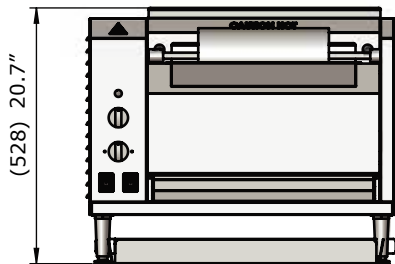

MODEL:
184BT18A
184BT18H

Dimensions with Extended Feeder Tray

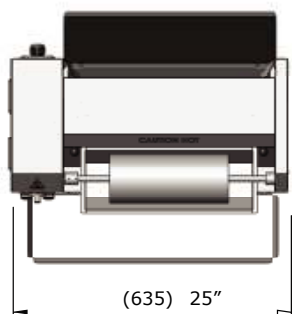
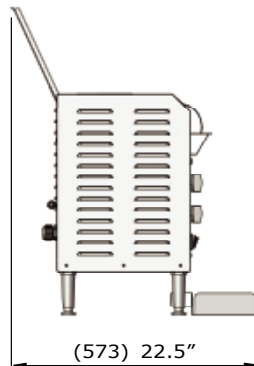
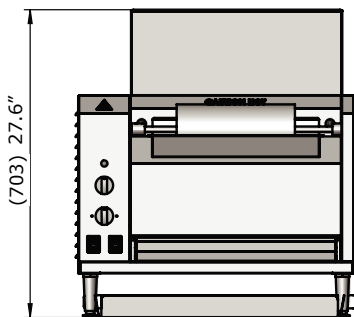

MODEL:
184BT18AXL
184BT18HXL

Troubleshooting

Problem	Possible Cause	Potential Solution
UNIT DEAD NO POWER	<ol style="list-style-type: none"> 1. No power at wall receptable 2. Plug disconnected 3. Main switch 4. Supply circuit breaker 	<ol style="list-style-type: none"> 1. Check supply circuit breaker 2. Check plug 3. Check switch is on 4. Check and reset
NO HEAT	<ol style="list-style-type: none"> 1. Faulty thermostat 2. Faulty element 3. Loose connections 4. Main switch off 	<ol style="list-style-type: none"> 1. Replace thermostat 2. Replace element 3. Check wiring connections 4. Check switch is on
CONVEYOR AND BUTTER ROLLER NOT WORKING	<ol style="list-style-type: none"> 1. Loose connections 2. Faulty main switch 3. Faulty butter roller switch 	<ol style="list-style-type: none"> 1. See section 3 2. Check roller is properly engaged into drive socket 3. Check and replace motor
BUTTER ROLLER NOT TURNING	<ol style="list-style-type: none"> 1. As points in section 3 above 2. Roller shaft incorrectly inserted into drive socket 3. Motor faulty 	<ol style="list-style-type: none"> 1. See section 3 2. Check roller is properly engaged into drive socket 3. Check and replace motor
MAIN CONVEYOR STATIONARY	<ol style="list-style-type: none"> 1. As points in section 3 above. 2. Drive gears not engaging 3. Conveyor linkage binding 4. Speed control faulty 5. Motor faulty 	<ol style="list-style-type: none"> 1. See section 3 2. Reinstall conveyor as per instructions 3. Check conveyor for bent of faulty links 4. Replace speed control 5. Replace conveyor cassette
BUNS TOAST UNEVENLY	<ol style="list-style-type: none"> 1. Insufficient conveyor pressure 2. Poor application of oil or butter 3. Poorly sliced buns 	<ol style="list-style-type: none"> 1. Adjust conveyor as in instructions 2. Ensure even coating when using the butter roller 3. Ensure bread is cut correctly
BUNS TEND TO STICK TO GRILL PLATE	<ol style="list-style-type: none"> 1. Wrong oil used 2. Grill plate has baked on oil residue 3. Doughy buns or excess sugar can cause sticking 4. Buns not properly defrosted 	<ol style="list-style-type: none"> 1. Install and use included non-stick sheet 2. Ideally use toaster oil or coconut oil 3. Clean grill surface as instructed 4. Consider using day old buns or increasing the grill temperature 5. Defrost buns correctly