

# AUTO-MATE LITHIUM ION Cordless Hand Vac

---

USER GUIDE  
2284W

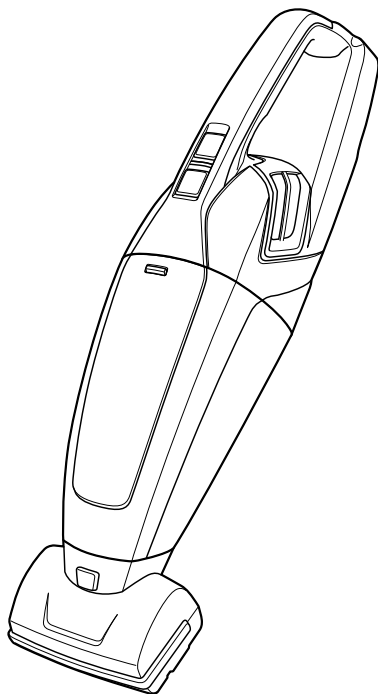

# IMPORTANT SAFETY INSTRUCTIONS

## READ ALL INSTRUCTIONS BEFORE USING YOUR HAND VACUUM.

Always connect to outlet for charging. Unplug from outlet when not in use and before conducting maintenance. When using an electrical appliance, basic precautions should be observed, including the following:

### **WARNING**

#### **TO REDUCE THE RISK OF FIRE, ELECTRIC SHOCK, OR INJURY:**

- » Do not use outdoors or on wet surfaces.
- » Do not allow to be used as a toy. Close attention is necessary when used by or near children.
- » Do not use for any purpose other than described in this User's Guide. Use only manufacturer's recommended attachments.
- » Do not use with damaged cord or plug. If appliance is not working as it should, has been dropped, damaged, left outdoors, or dropped into water, have it repaired at an authorized service center.
- » Do not put any object into opening.
- » Do not use with any opening blocked.
- » Do not unplug by pulling on cord. To unplug, grasp the plug, not the cord.
- » Do not handle charger, including charger plug and charger terminal with wet hands.
- » Do not charge the unit outdoors.
- » Use only the charger supplied by the manufacturer to recharge.
- » Do not incinerate the appliance even if it severely damaged. The batteries can explode in a fire.
- » Keep openings free of dust, lint, hair and anything that may reduce airflow.
- » Keep hair, loose clothing, fingers, and all parts of body away from openings and moving parts.
- » Use extra care when cleaning stairs.

- » Do not use to pick up flammable or combustible materials (lighter fluid, gasoline, kerosene, etc.) or use in areas where they may be present.
- » Do not pick up toxic material (chlorine bleach, ammonia, drain cleaner, etc.).
- » Do not use vacuum cleaner in an enclosed space filled with vapors given off by oil base paint, paint thinner, some moth proofing substances, flammable dust, or other explosive or toxic vapors.
- » Do not pick up hard or sharp objects such as glass, nails, screws, coins, etc.
- » Do not pick up anything that is burning or smoking, such as cigarettes, matches, or hot ashes.
- » Do not use without dust cup or filters in place.
- » Use only on dry, indoor surfaces.
- » Always turn off this appliance before connecting or disconnecting the motorized nozzle.
- » Do not pull or carry charger by the cord, use cord as a handle, close a door on cord, or pull cord around sharp edges or corners. Do not run appliance over cord.
- » Prevent unintentional starting. Ensure the switch is in the off-position before picking up or carrying the appliance. Carrying the appliance with your finger on the switch or energizing appliance that have the switch on invites accidents.
- » Under abusive conditions, liquid may be ejected from the battery; avoid contact. If contact accidentally occurs, flush with water. If liquid contacts eyes,

additionally seek medical help. Liquid ejected from the battery may cause irritation or burns.

- » Do not use appliance that is damaged or modified. Damaged or modified batteries may exhibit unpredictable behavior resulting in fire, explosion or risk of injury.
- » Do not expose appliance to fire or excessive temperature. Exposure to fire or temperature above 130°C/265°F may cause explosion.
- » Follow all charging instructions and do not charge the appliance outside of the temperature range specified in the instructions. Charging improperly or at temperatures outside of the specified range may damage the battery and increase the risk of fire.
- » Have servicing performed by a qualified repair person using only identical replacement parts. This will ensure that the safety of the product is maintained.
- » Do not modify or attempt to repair the appliance except as indicated in the instructions for use and care.
- » Keep the temperature range of between 40-104°F when charging battery, storing unit or during use.
- » Use only with E-TEK charger, Model ZD5F230030US.
- » Recharge only with the charger specified by the manufacturer. A charger that is suitable for one type of battery pack may create a risk of fire when used with another battery pack.

## SAVE THESE INSTRUCTIONS FOR FUTURE USE

This model is for household use only.

## Thanks for buying a BISSELL vacuum!

We love to clean and we're excited to share one of our innovative products with you. We want to make sure your vacuum works as well in two years as it does today, so this guide has tips on using (page 6-7), maintaining (pages 7-10), and if there is a problem, troubleshooting (page 11).

In just a few simple assembly steps, you'll be ready to vacuum. Flip to page 5 and let's get started!

## What's In The Box?

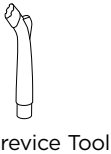
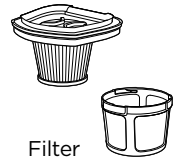
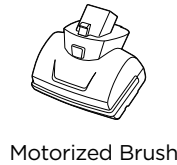
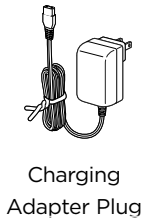
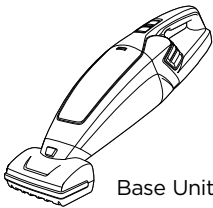

**NOTE:** Standard accessories may vary by model. To identify what should be included with your purchase, please refer to the "Carton Contents" list located on the carton top flap.

Safety Instructions . . . . . 2

Maintenance & Care . . . . . 7-10

Product View . . . . . 4

Troubleshooting . . . . . 11

Assembly . . . . . 5

Guarantee . . . . . 12

Operations . . . . . 6-7

Service . . . . . 12

# Product View

- 1 Dirt Cup
- 2 Filter
- 3 Washable Filter Cup
- 4 Charging Light
- 5 Dirt Cup Release
- 6 Power Button

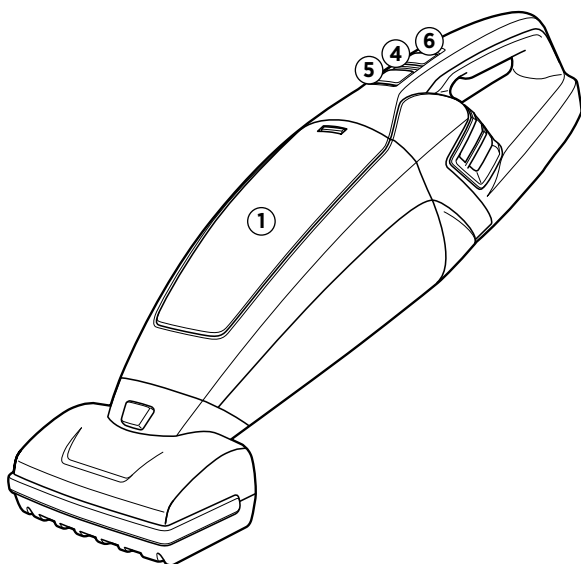
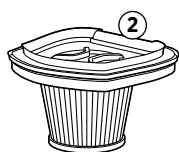

## **WARNING**

Plastic film can be dangerous. To avoid danger of suffocation, keep away from babies and children.

## **WARNING**

Do not plug in your hard floor cleaner until you are familiar with all instructions and operating procedures.

## **WARNING**

To reduce the risk of electric shock, turn power switch off and disconnect plug from electrical outlet before performing maintenance or troubleshooting checks.

# Assembly

## **WARNING**

Do not plug in your vacuum until you are familiar with all instructions and operating procedures.

### **IMPORTANT: ALWAYS TURN UNIT OFF PRIOR TO CHARGING\***

\*failing to do so may result in battery not fully charging

**1**

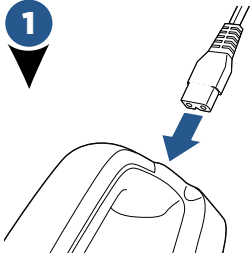

Insert charging adapter plug into the charging port on back of the unit.

**2**

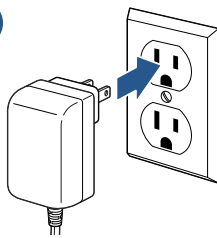

Plug the adapter into the wall outlet. The power LED lights will illuminate when charging.

**3**



Charge the unit completely for 8 hours prior to first use.

**NOTE:** The LED light will blink RED when charging and turn GREEN once fully charged. After 10 minutes of being fully charged, the GREEN light will flash once per minute. The adaptor may become warm during charging - this is normal.

## LED Light Display Status

BATTERY STATUS	LIGHT STATUS
<b>IN USE</b>	
In Use	Solid green light
Low Power	Blinking red light (.5 seconds)
No Power	Solid red light (3 seconds)
Brush Stall	Solid red light, then unit shuts off
<b>CHARGING</b>	
Charging	Blinking red light (1 second)
Fully Charged	Green light (on 10 minutes, then blinks every 1 minute)
Charger/Battery Error	Red and green blinking light, contact Consumer Care
Battery/Motor Issue	Red and green blinking light, contact Consumer Care

## Using Your Hand Vacuum

1

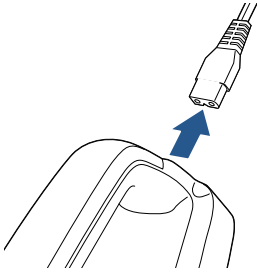

Unplug the machine from the charging adapter.

2

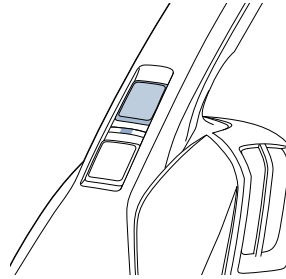

The Power Button is located on top of the handle. Push to the ON position.

**NOTE:** The LED light will shine GREEN while in use. When the battery level gets low, the LED light will blink RED. When the battery is fully discharged, the LED light will shut off completely.

## Using the Motorized Brush

1

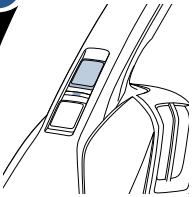

To attach the motorized brush, make sure the unit is powered OFF.

2

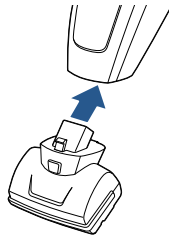

Firmly insert the motorized brush into the nozzle of the hand vac until it snaps into place.

3

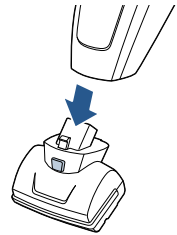

To detach, turn the machine OFF, then press the button on top of the motorized brush and pull out.

**NOTE:** The motorized brush can be used to vacuum stairs, upholstery and other hard to reach areas.

## Using the Accessories

1

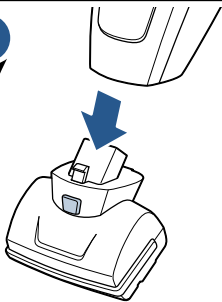

Remove the motorized brush as directed in the "Using the motorized brush" section.

2

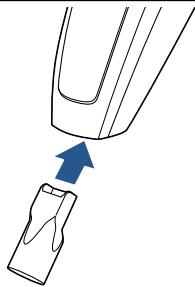

Insert Specialty Tool Adaptor into the end of the hand vacuum to attach LED or flexible crevice tool.

3

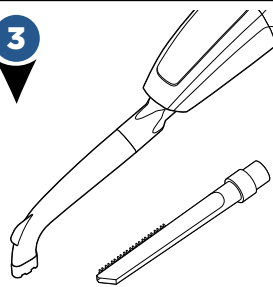

Attach desired tool. LED crevice tool will stay illuminated while inserted into the Specialty crevice tool adaptor.

## LED Lighted Crevice Tool

1

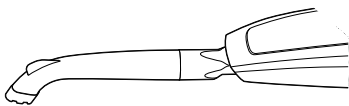

Pull tabs out of battery door area before use to activate. Connect to handle, wand or hose and the LED Light will automatically come on.

2

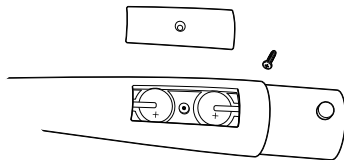

To replace LED battery, unscrew the small screw with a Phillips head screw driver. Pull cover off to reveal two batteries (CR1632 3V). Slide and pull out each battery and replace with new. Be sure the "+" sign on battery is facing out. Dispose of used battery promptly. Keep away from children. Do not disassemble and do not dispose of in fire.

**NOTE:** When the small tab on the connection point of Crevice tool comes into contact with the handle, wand, or hose; that triggers the LED light to come on. When using with the Wand, be sure it does not pop through the opening at the end of the Wand.

## Parts & Supplies

For Parts and Supplies, go to [www.BISSELL.com](http://www.BISSELL.com) and enter your model number in the search field.

# Empty the Dirt Collection Tank

## **⚠️ WARNING**

To reduce the risk of electrical shock, turn power switch off and disconnect polarized plug from electrical outlet before performing maintenance or troubleshooting checks.

**1**

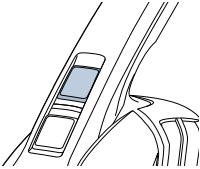

The dirt collection tank should be emptied before debris reaches the FULL line. Turn power OFF.

**2**

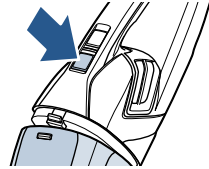

Hold the hand vacuum vertically and depress release button on the front to release the dirt collection tank.

**3**

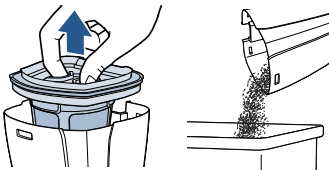

Grasp filter tabs and pull vertically to remove filter cup and empty dirt into waste container.

**4**

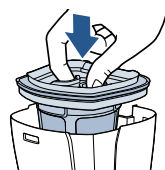

Replace filter back into the dirt cup and attach dirt cup to hand vacuum until it snaps securely into place.

# Cleaning or Replacing the Brush Roll

**1**

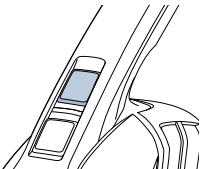

Turn power OFF and detach motorized brush if attached OR turn unit over to access the brush roll.

**2**

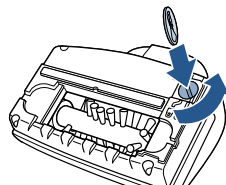

Use a coin to remove the brush roll, turning counter clockwise to unlock.

**3**

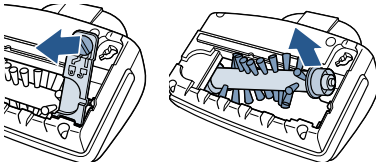

Then simply lift the brush out of the foot and clean off hair or other debris from brush roll.

**4**

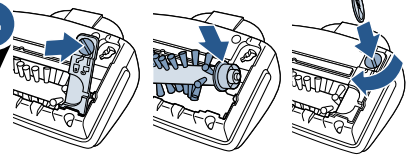

Place the cleaned brush roll back into the foot of unit and use coin to turn lock clockwise to lock into place.

# Cleaning or Replacing the Filter

## **WARNING**

Do not operate vacuum with damp or wet filters or without all filters in place.

1

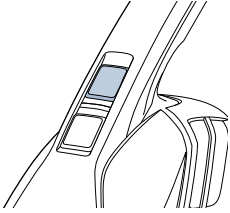

Turn power OFF and remove the dirt cup as directed in “Empty the dirt cup” section.

2

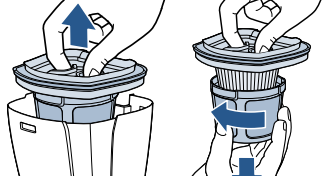

Grasp filter tabs and lift up to remove the washable filter cup from the dirt cup. Grip the filter cup and turn counterclockwise and lift down to remove filter from filter cup.

3

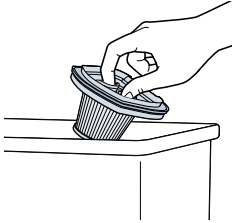

Tap firmly against the inside of a waste container, removing any visible dirt.

4

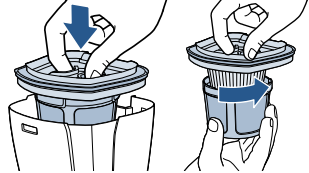

Replace filter back into the filter cup then turn clockwise to lock into place. Attach filter cup back into the dirt cup and attach to hand vacuum until it snaps securely in place.

**NOTE:** After heavy usage, you may clean the filter and filter cup by washing it gently by hand in warm water and mild dish detergent. Rinse thoroughly and make certain it is completely dry before replacing it.

# Disposal of Batteries

## **WARNING**

This product contains Lithium Ion rechargeable batteries. According to Federal and State regulations, removal and proper disposal of Lithium Ion batteries is required. For removal of the batteries in your Pet Hair Eraser Lithium Ion, see instructions on this page.



**NOTICE:** Disconnecting the battery will destroy the appliance and invalidate the warranty.

Before proceeding, ensure that:

- the unit is disconnected from the charger
- the dirt collection tank and motorized brush have been removed from unit (see removal instructions on pages 8-9)
- you have a flat head and Phillips screwdriver, required for disassembly

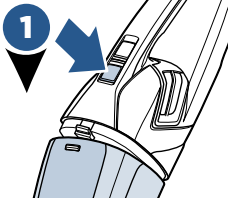

1 Unplug charger and remove the dirt collection tank.

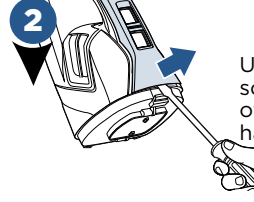

2 Using a flathead screwdriver, pry off top cover of handle.

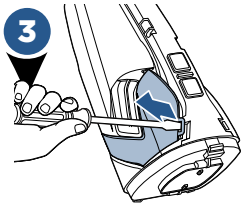

3 Using a flathead screwdriver, pry off left and right panels from hand vacuum.

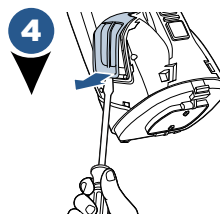

4 Using a flathead screwdriver, remove the plastic vent cover.

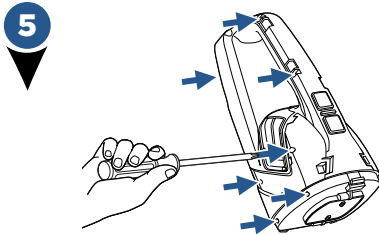

5 Using a Phillips screwdriver, remove (7) seven screws in the locations referenced in the image.

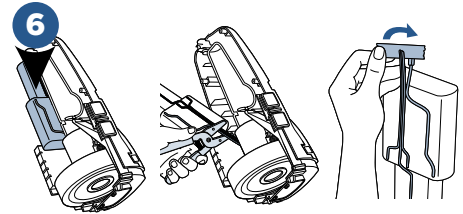

6 Disconnect and remove entire battery assembly by cutting wires from PCB and wrapping wire ends with insulation tape. Discard remainder of product.

**NOTE:** Keep Battery Pack together – DO NOT separate individual batteries. For specific disposal instructions of batteries, please contact the RBRC (Rechargeable Battery Recycling Corporation) at 1-800-822-8837 or visit [www.Call2Recycle.org](http://www.Call2Recycle.org).

# Troubleshooting

## **WARNING**

To reduce the risk of electric shock, turn power switch off and disconnect plug from electrical outlet before performing maintenance or troubleshooting checks.

<b>Problem</b>	<b>Possible causes</b>	<b>Remedies</b>
<b>Vacuum won't turn on</b>	Battery is fully discharged	Charge battery. Follow charging battery instructions on page 5.
<b>Vacuum cleaner has low suction</b>	Dirt container is full	Empty dirt container.
	Dirt container is not installed properly	Position container correctly and snap firmly into place.
	Filters need cleaning	Follow filter instructions on page 9
	Filters need replacing	Visit <a href="http://www.bissell.com">www.bissell.com</a> or call 1-800-237-7691 to order replacement filters.
	Battery needs charging	Charge battery. Follow charging battery instructions on page 5.
	Clog in tool	Remove tool and remove any debris or hair in either opening of the tool.
<b>Visible dirt escaping from vacuum</b>	Dirt container is full of debris	Empty dirt container.
	Filter is missing or installed incorrectly	Check filter for correct installation.
<b>Hand vacuum won't charge</b>	Machine is in the ON position	Set the hand vacuum in the OFF position.
	Not the correct charger	Use only the charger that comes with the machine. Correct charger model # is listed on the white warning label on the hand vac.

### **Please do not return this product to the store.**

Other maintenance or service not included in the manual should be performed by an authorized service representative.

For any questions or concerns, BISSELL is happy to be of service. Contact us directly at 1-800-237-7691.

# Warranty

This warranty gives you specific legal rights, and you may also have other rights which may vary from state to state. If you need additional instruction regarding this warranty or have questions regarding what it may cover, please contact BISSELL Consumer Care by E-mail or telephone as described below.

## Limited One-Year Warranty

Subject to the \*EXCEPTIONS AND EXCLUSIONS identified below, upon receipt of the product BISSELL will repair or replace (with new, refurbished, lightly used, or remanufactured components or products), at BISSELL's option, free of charge from the date of purchase by the original purchaser, for one year any defective or malfunctioning part.

See information below on "If your BISSELL product should require service".

This warranty applies to product used for personal, and not commercial or rental, service. This warranty does not apply to fans or routine maintenance components such as filters, belts, or brushes. Damage or malfunction caused by negligence, abuse, neglect, unauthorized repair, or any other use not in accordance with the User's Guide is not covered. This warranty will only be valid if the product is used in the same country in which it was sold.

BISSELL IS NOT LIABLE FOR INCIDENTAL OR CONSEQUENTIAL DAMAGES OF ANY NATURE ASSOCIATED WITH THE USE OF THIS PRODUCT. BISSELL'S LIABILITY WILL NOT EXCEED THE PURCHASE PRICE OF THE PRODUCT.

**Some states do not allow the exclusion or limitation of incidental or consequential damages, so the above limitation or exclusion may not apply to you.**

## \*EXCEPTIONS AND EXCLUSIONS FROM THE TERMS OF THE LIMITED WARRANTY

THIS WARRANTY IS EXCLUSIVE AND IN LIEU OF ANY OTHER WARRANTIES EITHER ORAL OR WRITTEN. ANY IMPLIED WARRANTIES WHICH MAY ARISE BY OPERATION OF LAW, INCLUDING THE IMPLIED WARRANTIES OF MERCHANTABILITY AND FITNESS FOR A PARTICULAR PURPOSE, ARE LIMITED TO THE ONE YEAR DURATION FROM THE DATE OF PURCHASE AS DESCRIBED ABOVE.

Some states do not allow limitations on how long an implied warranty lasts, so the above limitation may not apply to you.

**NOTE:** Please keep your original sales receipt. It provides proof of date of purchase in the event of a warranty claim.

# Service

## If your BISSELL product should require service:

Contact BISSELL Consumer Care to locate a BISSELL Authorized Service Center in your area.

If you need information about repairs or replacement parts, or if you have questions about your warranty, contact BISSELL Consumer Care.

### Website:

[www.BISSELL.com/service-centers](http://www.BISSELL.com/service-centers)

### E-mail:

[www.BISSELL.com/email-us](mailto:www.BISSELL.com/email-us)

### Call:

BISSELL Consumer Care

1-800-237-7691

Monday - Friday 8am - 10pm ET

Saturday 9am - 8pm ET

Sunday 10am - 7pm ET



©2018 BISSELL Homecare, Inc  
Grand Rapids, Michigan  
All rights reserved. Printed in China  
Part Number 161-4859 02/18 RevA  
Visit our website at: [www.BISSELL.com](http://www.BISSELL.com)