

# BMW 3 Series Pedal Cover Set – Installation Manual

Product: Stainless Steel Pedal Cover Set

Compatibility: BMW 3 Series 2013–2019 (F30 / F31 / F34 / F35)

Package Options: 2 PCS (Brake + Accelerator) or 3 PCS (Brake + Accelerator + Footrest)

Material: Stainless Steel + Anti-Slip Rubber

Features: Anti-slip design, corrosion resistant, easy non-destructive installation.

13-19 3 series

F30、 F31  
F34、 F35

3pcs

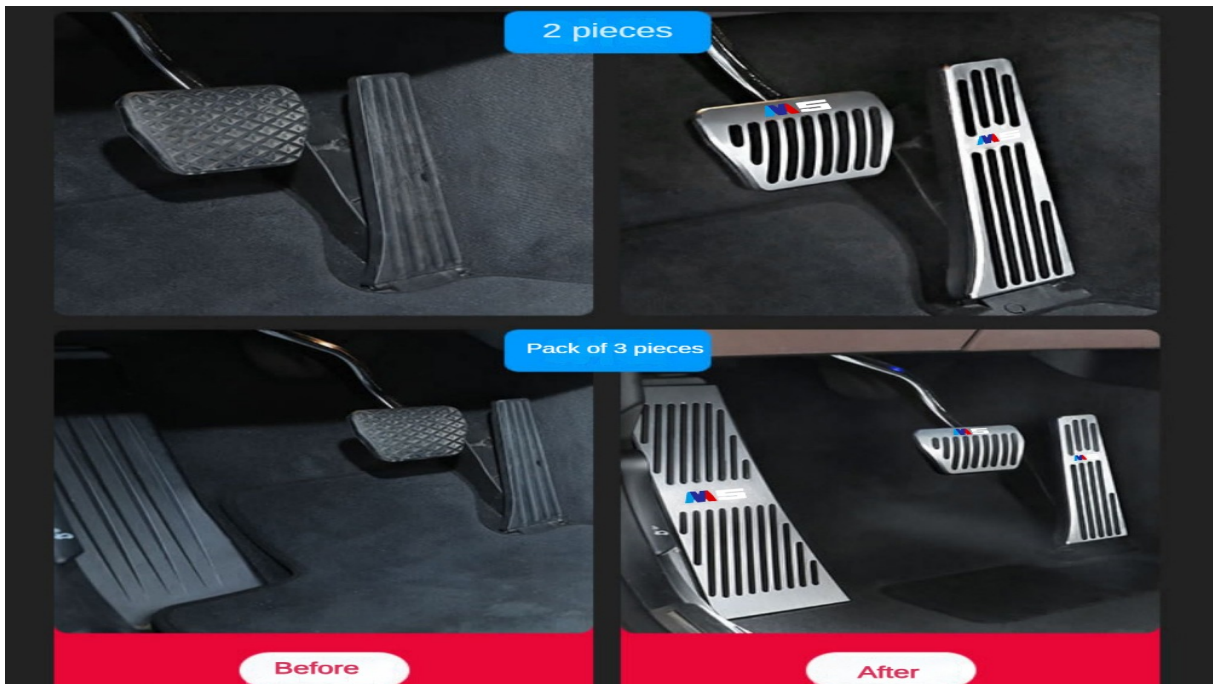
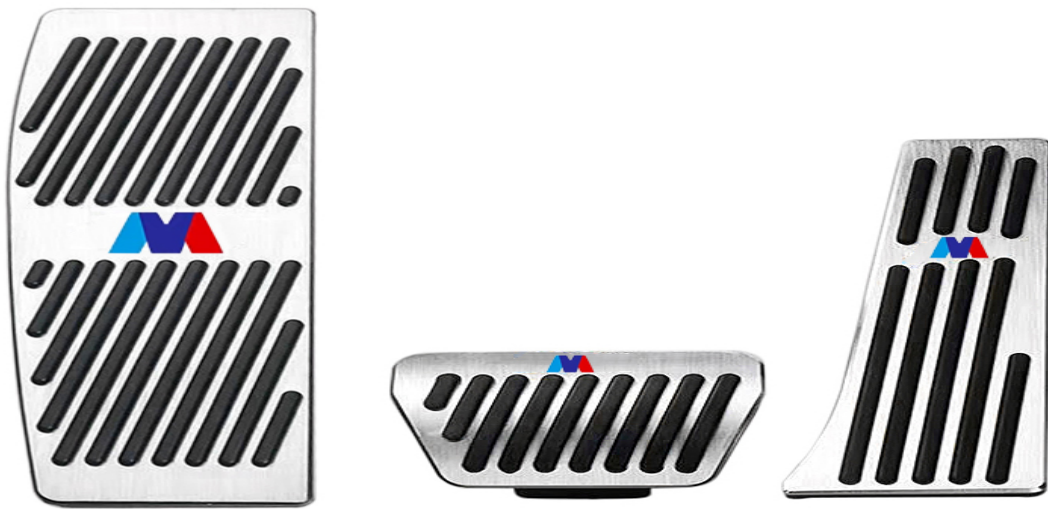

STAINLESS STEEL MATERIAL



多方位安全设计

## Replace the nested installation

Replacement type installation, directly set in, non-destructive installation, stable and not falling off

The material is hard, not easy to deform fracture and rust



## Installation Steps

1. Clean the original pedal surface and remove dust or oil.
2. Align the pedal cover with the original pedal.
3. Press the cover firmly until it fits securely.
4. For the brake pedal, stretch the rubber edge and press around the pedal.
5. Check stability before driving.

Safety Notes:

- Ensure the pedal cover is firmly installed before driving.
- Check the pedal surface regularly for proper fit.
- Do not install while the vehicle is running.
- Professional installation is recommended if unsure.

## Multilingual Quick Guide

Language	Installation (Short Guide)
English	Clean pedal → Align cover → Press firmly → Check stability.
Español	Limpiar el pedal → Alinear la cubierta → Presionar firmemente → Verificar estabilidad.
Français	Nettoyer la pédale → Aligner le couvercle → Appuyer fermement → Vérifier la stabilité.
Deutsch	Pedal reinigen → Abdeckung ausrichten → Fest drücken → Stabilität prüfen.
Português	Limpar o pedal → Alinhar a capa → Pressionar firmemente → Verificar estabilidade.
Italiano	Pulire il pedale → Allineare la copertura → Premere con forza → Controllare la stabilità.