The Bose logo is displayed in a white, italicized, sans-serif font against a dark gray rectangular background.

Wireless Mic/Line Transmitter
Wireless Instrument Transmitter

Trådløs Mic/Line-sender
Trådløs instrumentsender

Mikrofon/Line-Drahtlossender
Instrumenten-Drahtlossender

Draadloze mic/line-zender
Draadloze instrumentzender

Transmisor inalámbrico de micrófono/línea
Transmisor inalámbrico de instrumentos

Langaton mikrofon-/linjalähetin
Langaton instrumenttilähetin

Émetteur-récepteur micro/ligne sans fil
Émetteur-récepteur instrument sans fil

Trasmittitore wireless microfono/linea
Trasmittitore wireless strumento

Vezeték nélküli mikrofonos/vonalszintű jeladó
Vezeték nélküli hangszeres jeladó

Trådløs mikrofon-/linjesender
Trådløs instrumentsender

Bezprzewodowy nadajnik mikrofonowy/liniowy
Bezprzewodowy nadajnik do instrumentów

Transmissor de microfone/linha sem fio
Transmissor de instrumento sem fio

Trådlös mikrofon-/linjesändare
Trådlös instrumentsändare

①

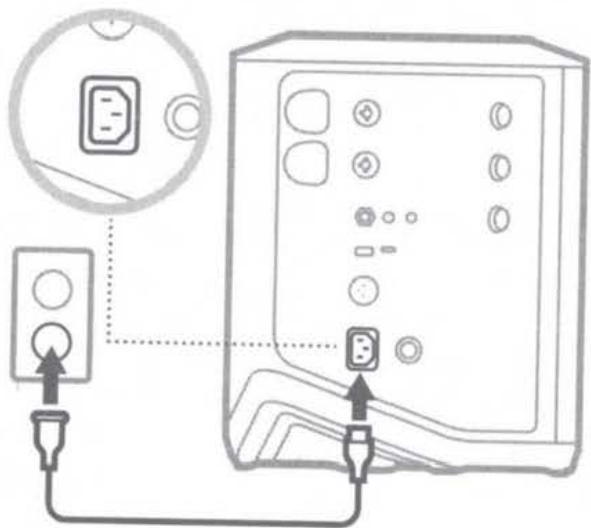

②

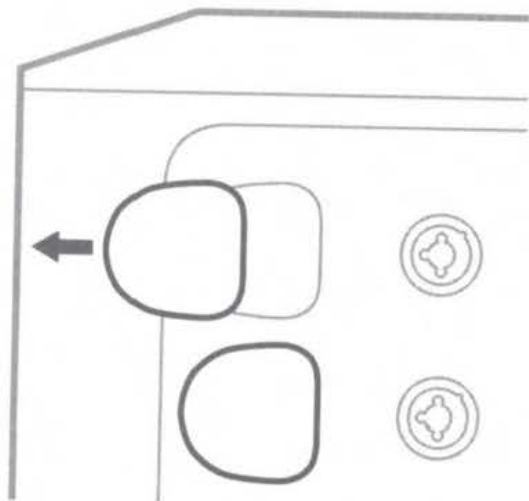

③

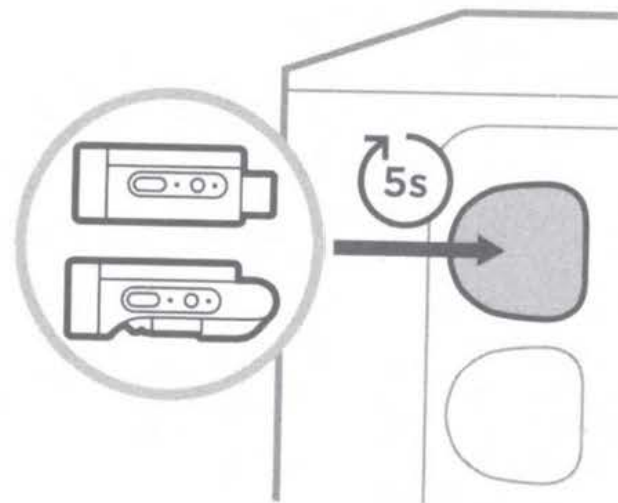

④

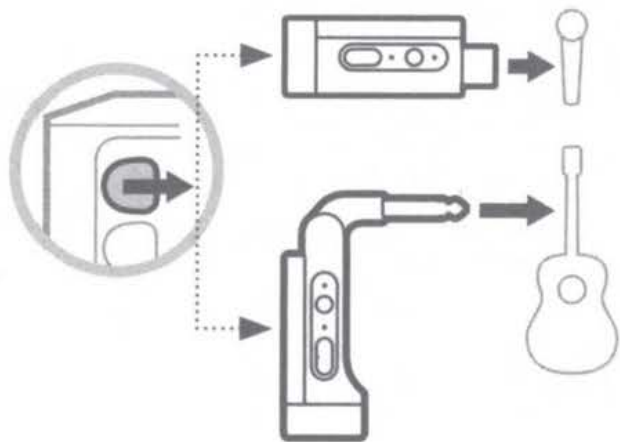

⑤

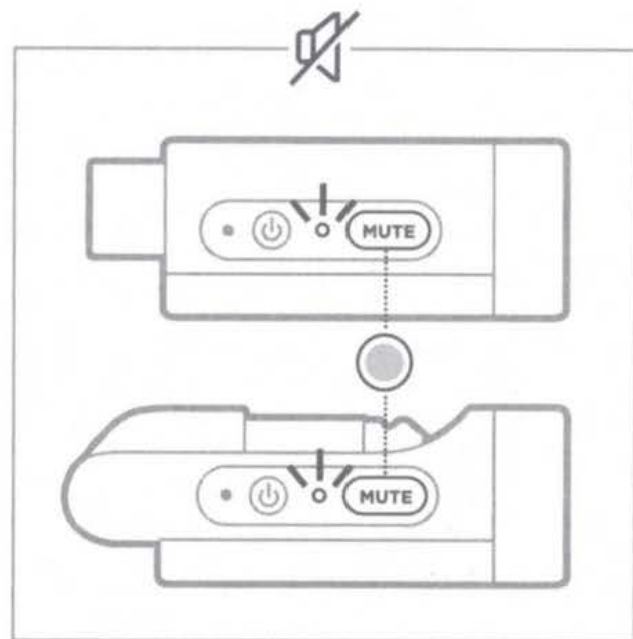
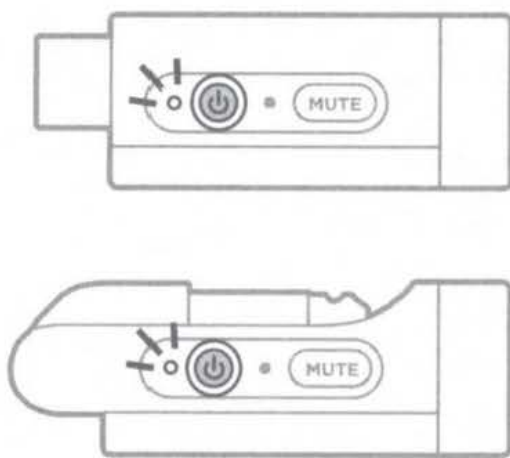

ENGLISH

Please read and keep all safety, security, and use instructions.

Refer to the owner's guide for more information about your Bose Wireless Mic/Line Transmitter or Bose Wireless Instrument Transmitter (including accessories and replacement parts) at support.Bose.com/WirelessTransmitter or contact Bose customer service for a printed copy.



Bose Corporation hereby declares that this product is in compliance with the essential requirements and other relevant provisions of Directive 2014/53/EU and all other applicable EU directive requirements. The complete declaration of conformity can be found at: www.Bose.com/compliance



This product conforms to all applicable Electromagnetic Compatibility Regulations 2016 and all other applicable UK regulations. The complete declaration of conformity can be found at: www.Bose.com/compliance

Bose Corporation hereby declares that this product is in compliance with the essential requirements per Radio Equipment Regulations 2017 and all other applicable UK regulations. The complete declaration of conformity can be found at: www.Bose.com/compliance

Important Safety Instructions

Do not use this apparatus near water.

Clean only with a dry cloth.

Refer all servicing to qualified personnel. Servicing is required when the apparatus has been damaged in any way, such as power-supply cord or plug is damaged, liquid has been spilled or objects have fallen into the apparatus, the apparatus has been exposed to rain or moisture, does not operate normally, or has been dropped.

WARNINGS/CAUTIONS

- Keep the product away from fire and heat sources. Do NOT place naked flame sources, such as lighted candles, on or near the product.

- Do NOT make unauthorized alterations to this product.
- Use this product only with the Bose S1 Pro + Wireless PA System or an agency-approved LPS power supply that meets local regulatory requirements (e.g., UL, CSA, VDE, CCC).
- The battery provided with this product may present a risk of fire, explosion or chemical burn if mishandled, incorrectly replaced or replaced with an incorrect type.
- Do not expose products containing batteries to excessive heat (e.g. from storage in direct sunlight, fire or the like).

Regulatory and Legal Information

NOTE: This equipment has been tested and found to comply with the limits for a Class B digital device, pursuant to Part 15 of the FCC Rules. These limits are designed to provide reasonable protection against harmful interference in a residential installation. This equipment generates, uses, and can radiate radio frequency energy and, if not installed and used in accordance with the instructions, may cause harmful interference to radio communications. However, there

is no guarantee that interference will not occur in a particular installation. If this equipment does cause harmful interference to radio or television reception, which can be determined by turning the equipment off and on, the user is encouraged to try to correct the interference by one or more of the following measures:

- Reorient or relocate the receiving product or antenna.
- Increase the separation between the equipment and receiver.
- Connect the equipment into an outlet on a circuit different from that to which the receiver is connected.
- Consult the dealer or an experienced radio/TV technician for help.

Changes or modifications not expressly approved by Bose Corporation could void the user's authority to operate this equipment.

This device complies with part 15 of the FCC Rules and with ISED Canada's license-exempt RSS standard(s). Operation is subject to the following two conditions: (1) This device may not cause harmful interference, and (2) this device must accept any interference received, including interference that may cause undesired operation.

This device complies with FCC and ISED Canada radiation exposure limits set forth for general population. This transmitter must not be co-located or operating in conjunction with any other antenna or transmitter.

For Europe:

Frequency band of operation 2402 to 2482 MHz.

Maximum transmit power less than 10 dBm (10mW) EIRP.

Maximum transmit power is below regulatory limits such that SAR testing is not necessary and exempt per applicable regulations.



This symbol means the product must not be discarded as household waste, and should be delivered to an appropriate collection facility for recycling. Proper disposal and recycling helps protect natural resources, human health and the environment. For more information on

disposal and recycling of this product, contact your local municipality, disposal service, or the shop where you bought this product.

**Low-power Radio-frequency Devices
Technical Regulations**

Without permission granted by the NCC, any company, enterprise, or user is not allowed to change frequency, enhance transmitting power or alter original characteristic as well as performance to an approved low power radio-frequency devices. The low power radio-frequency devices shall not influence aircraft security and interfere legal communications; If found, the user shall cease operating immediately until no interference is achieved. The said legal communications means radio communications is operated in compliance with the Telecommunications Management Act. The low

power radio-frequency devices must be susceptible with the interference from legal communications or ISM radio wave radiated devices.

DON'T attempt to remove the rechargeable lithium-ion battery from this product. Contact your local Bose retailer or other qualified professional for removal.



Please dispose of used batteries properly, following local regulations.
Do not incinerate.

廢電池請回收



Li-ion

NOM



Date of Manufacture: The eighth digit in the serial number indicates the year of manufacture; "3" is 2023 or 2013.

China Importer: Bose Electronics (Shanghai) Company Limited, Level 6, Tower D, No. 2337 Gudai Rd. Minhang District, Shanghai 201100

EU Importer: Bose Products B.V., Gorslaan 60, 1441 RG Purmerend, The Netherlands

Mexico Importer: Bose de México S. de R.L. de C.V., Avenida Prado Sur #150, Piso 2, Interior 222 y 223, Colonia Lomas de Chapultepec V Sección, Miguel Hidalgo, Ciudad de México, C.P. 11000
Phone Number: +5255 (5202) 3545

Taiwan Importer: Bose Limited Taiwan Branch (H.K.), 9F., No. 10, Sec. 3, Minsheng E. Road, Zhongshan Dist. Taipei City 10480, Taiwan Phone Number: +886-2-2514 7676

UK Importer: Bose Limited, Bose House, Quayside Chatham Maritime, Chatham, Kent, ME4 4QZ, United Kingdom

Input Rating: 3.5 – 6.45V \approx 300mA

Battery Capacity: 530mAh

Charging Temperature Range:
32° F – 113° F (0° C – 45° C)

Discharging Temperature Range:

-4° F – 140° F (-20° C – 60° C)

Model: 469M (Mic/Line) / 469G (Instrument). The CMIT ID is located on the back of the transmitter.

The **Bose Privacy Policy** is available at [worldwide.bose.com/privacypolicy](https://www.worldwide.bose.com/privacypolicy)

The **Bose Terms of Use** are available at [worldwide.bose.com/termsofuse](https://www.worldwide.bose.com/termsofuse)

Bose is a trademark of Bose Corporation.

Bose Corporation Headquarters: 1-877-230-5639

©2023 Bose Corporation. No part of this work may be reproduced, modified, distributed, or otherwise used without prior written permission.

Warranty Information

This product is covered by a limited warranty from Bose. For warranty details, visit [worldwide.Bose.com/Warranty](https://www.worldwide.Bose.com/Warranty)



License Disclosures

The following license disclosures apply to certain third-party software packages used as components in the product.

Packages: STM32 LL - STM32 Low Layer API

Copyright 2017 STMicroelectronics. All rights reserved.

The above is/are subject to the license terms reprinted below:

3-Clause BSD License

3-Clause BSD License

(Also called "New BSD License" or "Modified BSD License")

Redistribution and use in source and binary forms, with or without modification, are permitted provided that the following conditions are met:

- Redistributions of source code must retain the above copyright notice, this list of conditions and the following disclaimer.
- Redistributions in binary form must reproduce the above copyright notice, this list of conditions and the following disclaimer in the documentation and/or

other materials provided with the distribution.

- Neither the name of the <organization> nor the names of its contributors may be used to endorse or promote products derived from this software without specific prior written permission.

THIS SOFTWARE IS PROVIDED BY THE COPYRIGHT HOLDERS AND CONTRIBUTORS "AS IS" AND ANY EXPRESS OR IMPLIED WARRANTIES, INCLUDING, BUT NOT LIMITED TO, THE IMPLIED WARRANTIES OF MERCHANTABILITY AND FITNESS FOR A PARTICULAR PURPOSE ARE DISCLAIMED. IN NO EVENT SHALL <COPYRIGHT HOLDER> BE LIABLE FOR ANY DIRECT, INDIRECT, INCIDENTAL, SPECIAL, EXEMPLARY, OR CONSEQUENTIAL DAMAGES (INCLUDING, BUT NOT LIMITED TO, PROCUREMENT OF SUBSTITUTE GOODS OR SERVICES; LOSS OF USE, DATA, OR PROFITS; OR BUSINESS INTERRUPTION) HOWEVER CAUSED AND ON ANY THEORY OF LIABILITY, WHETHER IN CONTRACT, STRICT LIABILITY, OR TORT (INCLUDING NEGLIGENCE OR OTHERWISE) ARISING IN ANY WAY OUT OF THE USE OF THIS SOFTWARE, EVEN IF ADVISED OF THE POSSIBILITY OF SUCH DAMAGE.



support.Bose.com/WirelessTransmitter



worldwide.Bose.com/Warranty



872242-0020