

# CORDLESS HEAT GUN USER MANUAL

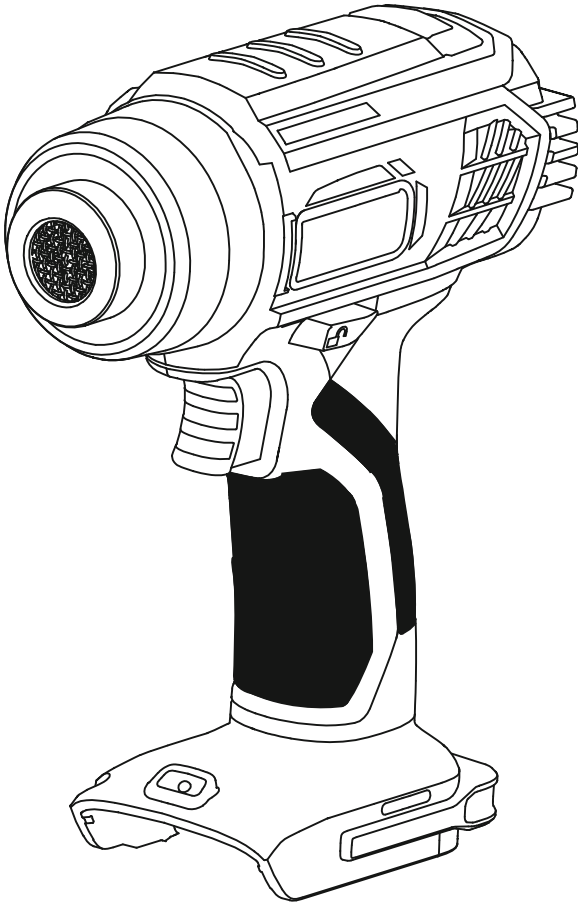

# Table Of Contents

Product Introduction-----	01
Operation-----	02
General Safety Warnings-----	02
Heat Gun Safety Warnings-----	04
Symbols-----	07
Features-----	08
Maintenance-----	09
Disposal-----	10



## **WARNING**

To reduce the risk of injury, the user must read and understand the operator's manual before using this product.

# Product Introduction

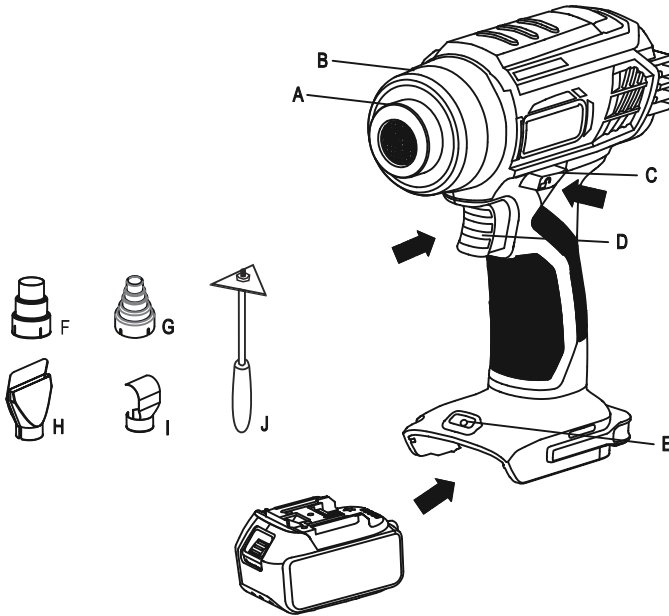

**A-Heat gun nozzle**

**B-Nose cone**

**C-Child Lock**

**D-Switch Trigger**

**E-LED light**

**F-20mm Concentrator nozzle**

**G-12mm Concentrator nozzle**

**H-Deflector Nozzle**

**I-Reflector nozzle**

**J-Triangular Scraper**

## Operating The Heat Gun

**Mode 1:**Lightly presses the child lock and then press the switch trigger-Turn on the heat gun; Release the switch trigger and turn off the heat gun.

**Mode 2:**Lightly press the child lock, then press the power trigger-Turn on the heat gun, and Press again the child lock to the end keeping the heat gun open always. Press the power switch of the heat gun, and heat gun off.

**NOTE:** You can depress the lock-off button from either the left or right side.

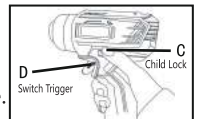
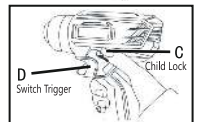
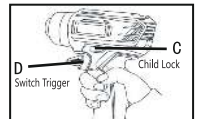

# Operation

## Attachment Installation

Attachments are included with the heat gun to expand its capabilities. Attachments are installed simply by placing them on the end of the heat gun's nozzle.

**NOTE:** Install or remove attachments only when both the heat gun nozzle and the attachment nozzle are cool.

## Lock-Off Button

The lock-off button reduces the possibility of accidental starting. The lock-off button is located on the handle above the switch trigger. The lock-off button must be depressed before you pull the switch trigger. The lock resets each time the trigger is released.

**NOTE:** You can depress the lock-off button from either the left or right side.

## Turning The Heat Gun ON/OFF

The heat gun has a lock-off button, located on the handle above the switch trigger, reduces the possibility of accidental starting.

■ **To turn the heat gun on:** Depress the lock-off button and press the switch trigger.

■ **To turn the heat gun off:** Release the switch trigger.

## Led Light

The LED light, located on the front end of the host base, will turn on when powered on and the switch is pressed down. When powered off, the LED light will not turn off immediately.

The software system has set that the LED will continue to turn on for a few seconds and then turn off.

# General Safety Warnings



## WARNING

**Read all safety warnings, instructions, illustrations and specifications provided with this power tool.**

Failure to follow all instructions listed below may result in electric shock, fire and/or serious injury.

**Save all warnings and instructions for future reference.**

The term "power tool" in the warnings refers to your mainsoperated (corded) power tool or battery-operated (cordless) power tool.

## **Work Area Safety**

- Keep work area clean and well lit. Cluttered or dark areas invite accidents.
- Do not operate power tools in explosive atmospheres, such as in the presence of flammable liquids, gases or dust. Power tools create sparks which may ignite the dust or fumes.
- Keep children and bystanders away while operating a power tool. Distractions can cause you to lose control.

## **Electrical Safety**

- Always stand and balance correctly. This allows for better control of power tools in unexpected situations.

## **Personal Safety**

- Stay alert, watch what you are doing and use common sense when operating a power tool. Do not use a power tool while you are tired or under the influence of drugs, alcohol or medication. A moment of inattention while operating power tools may result in serious personal injury,
- Use personal protective equipment. Always wear eye protection. Protective equipment such as dust mask, nonskid safety shoes, hard hat, or hearing protection used for appropriate conditions will reduce personal injuries.
- Prevent unintentional starting. Ensure the switch is in the off-position before connecting to power source and/or battery pack(not include) , picking up or carrying the tool. Carrying power tools with your finger on the switch or energizing power tools that have the switch on invites accidents.
- Always stand and balance correctly. This allows for better control of power tools in unexpected situations.
- Dress properly. Do not wear loose clothing or jewelry. Keep your hair, clothing and gloves away from moving parts. Loose clothes, jewelry or long hair can be caught in moving parts.
- Do not let familiarity gained from frequent use of tools allow you to become complacent and ignore tool safety principles. A careless action can cause severe injury within a fraction of a second.

## **Operating The Heat Gun**

- Install the battery pack(not include).
- Turn the heat gun on.
- Hold heat gun with one hand.
- Do not wear loose clothing or jewelry.
- Do not use it on a ladder or unstable stand, which can better control the power tool without accidents.

## **Power Tool Use And Care**

- Do not force the power tool. Use the correct power tool for your application. The correct power tool will do the job better and safer at the rate for which it was designed.
- Do not use the power tool if the switch does not turn it on and off. Any power tool that cannot be controlled with the switch is dangerous and must be repaired.

- Store idle power tools out of the reach of children and do not allow persons unfamiliar with the power tool or these instructions to operate the power tool. Power tools are dangerous in the hands of untrained users.
- Maintain power tools and accessories. Check for misalignment or binding of moving parts, breakage of parts and any other condition that may affect the power tool's operation. If damaged, have the power tool repaired before use. Many accidents are caused by poorly maintained power tools.
- Use the power tool, accessories and tool bits etc. in accordance with these instructions, taking into account the working conditions and the work to be performed. Use of the power tool for operations different from those intended could result in a hazardous situation.
- Keep handles and grasping surfaces dry, clean and free from oil and grease. Slippery handles and grasping surfaces do not allow for safe handling and control of the tool in unexpected situations.

## Heat Gun Safety Warnings

- When battery pack(not include) is not in use, keep it away from other metal objects, like paper clips, coins, keys, nails, screws or other small metal objects, that can make a connection from one terminal to another. Shorting the battery terminals together may cause burns or a fire.
- Under abusive conditions, liquid may be ejected from the battery; avoid contact. If contact accidentally occurs, flush with water. If liquid contacts eyes, additionally seek medical help. Liquid ejected from the battery may cause irritation or burns.
- Do not use a battery pack(not include) or tool that is damaged or modified. Damaged or modified batteries may exhibit unpredictable behavior resulting in fire, explosion, or risk of injury.
- Do not expose a battery pack(not include) or tool to fire or excessive temperature. Exposure to fire or temperature above 265°F may cause explosion.

### Service

- Have your power tool serviced by a qualified repair person using only identical replacement parts. This will ensure that the safety of the power tool is maintained.
- Never service damaged battery pack(not include). Service of battery pack(not include) should only be performed by the manufacturer or authorized service provider.

## Heat Gun Safety Warnings

When using heat guns, basic safety precautions should always be followed:

### Read All Instructions

- The nozzle of the heat gun becomes very hot during operation and should not be touched until the tool has cooled. Always hold the tool by the insulated gripping surface to reduce the risk of serious personal injury.
- Heat guns produce very high temperatures and must be used with caution to prevent combustible material from igniting. Keep tool in constant motion; do not stop or dwell in one spot. Following this rule will reduce the risk of fire or serious personal injury.

- Excessive heat can generate fumes which may be dangerous when inhaled. Wear a dust respirator mask or dual filter respirator mask when using the heat gun. Following this rule will reduce the risk of serious personal injury.
- Keep a fully charged fire extinguisher close at hand for emergency use. Following this rule will reduce the risk of fire or serious injury.
- Do not leave the heat gun unattended while running or cooling down. Always set tool on a flat, level surface so nozzle tip is directed upwards, away from supporting surface, while running or cooling down. Following this rule will reduce the risk of fire or serious injury.
- Know your power tool. Read operator's manual carefully. Learn its applications and limitations, as well as the specific potential hazards related to this tool. Following this rule will reduce the risk of electric shock, fire, or serious injury.
- Always wear eye protection marked to comply with ANSI Z87.1. Following this rule will reduce the risk of serious personal injury.
- Before using, check all parts for proper function and damage to component parts.
- Do not use this torch to heat, mold or bend plastic sheets, molding or tubing.



## WARNING

This heat gun generates extremely high temperatures. Hidden areas such as behind walls, ceilings, floors, soft boards and other panels may contain flammable materials that could be ignited by the heat gun when working in these locations. The ignition of these materials may not be readily apparent and could result in property damage and injury to persons. When working in these locations, keep the torch moving in a back-and-forth motion. Linger or pausing in one spot could ignite the panel or the material behind it.

## Heat Gun Safety Warnings



## WARNING

Extreme care should be taken when stripping paint. The peelings, residue and vapors of paint may contain lead, which is poisonous. Any pre-1977 paint may contain lead and paint applied to homes prior to 1950 is likely to contain lead. Once deposited on surfaces, hand to mouth contact can result in the ingestion of lead. Exposure to even low levels of lead can cause irreversible brain and nervous system damage; young and unborn children are particularly vulnerable. Before beginning any paint removal process you should determine whether the paint you are removing contains lead. This can be done by your local health department or by a professional who uses a paint analyzer to check the lead content of the paint to be removed. **LEAD-BASED PAINT SHOULD ONLY BE REMOVED BY A PROFESSIONAL AND SHOULD NOT BE REMOVED USING A TORCH.**



## **WARNING**



DO not direct hot tip or nozzle toward clothing, hands, or other body parts. Intense heat from tip or nozzle can cause serious burns or cause clothing to ignite.

### **Persons Removing Paint Should Follow These Guidelines:**







- Move the work piece outdoors. If this is not possible, keep the work area well ventilated. Open the windows and put an exhaust fan in one of them. Be sure the fan is moving the air from inside to outside.
- Please remove any carpets, blankets, furniture, clothing, cooking utensils from the work piece and keep it ventilated.
- Place drop cloths in the work area to catch any paint chips or peelings, Wear protective clothing such as extra work shirts, overalls and hats.
- Work in one room at a time. Furniture should be removed or placed in the centre of the room and covered. The work area should be sealed off from the rest of the home by sealing the doorway with a rag.
- Children, pregnant or potentially pregnant women and nursing mothers should not be present in the work area until the work is done and all clean up is complete.
- Wear a dust respirator mask or a dual filter (dust and fume) respirator mask which has been approved by the Occupational Safety and Health Administration (OSHA, the National Institute of Safety and Health (NIOSH), or the United States Bureau of Mines. These masks and replaceable filters are readily available at major hardware stores. Be sure the mask fits. Beards and facial hair may keep masks from sealing properly. Change filters often. DISPOSABLE PAPER MASKS ARE NOT ADEQUATE.
- Use caution when operating the heat gun. Keep the heat gun moving, as excessive heat will generate fumes, which can be inhaled by the operator.
- Keep food and drink out of the work area. Wash hands, arms and face and rinse mouth before eating or drinking. Do not smoke or chew gum or tobacco in the work area.
- Clean up all removed paint and dust by wet mopping the floors. Use a wet cloth to clean all walls, and other surfaces where paint or dust is clinging. DO NOT SWEEP, DRY DUST OR VACUUM. Use a high phosphate detergent or trisodium phosphate (TSP) to wash and mop areas
- At the end of each work session put the paint chips and debris in a double plastic bag. close it with tape or twist ties and dispose of properly
- Remove protective clothing and work shoes in the work area to avoid carrying dust into the rest of the dwelling. Wash work clothes separately. Wipe shoes off with a wet rag that is then washed with the work clothes. Wash hair and body thoroughly with soap and water.

# Symbols

The following signal words and meanings are intended to explain the levels of risk associated with this product.

<b>SYMBOL</b>	<b>SIGNAL</b>	<b>MEANING</b>
	<b>DANGER:</b>	Indicates a hazardous situation which, if not avoided, will result in death or serious injury.
	<b>WARNING:</b>	Indicates a hazardous situation which, if not avoided, will result in death or serious injury.
	<b>CAUTION:</b>	Indicates a hazardous situation that, if not avoided, may result in minor or moderate injury.
	<b>NOTICE:</b>	Without Safety Alert Symbol) Indicates information considered important, but not related to a potential injury (e.g. messages relating to property damage).

Some of the following symbols may be used on this product. Please study them and learn their meaning. Proper interpretation of these symbols will allow you to operate the product better and safer.

<b>SYMBOL</b>	<b>NAME</b>	<b>DESIGNATION/EXPLANATION</b>
	Safety Alert	Indicates a potential personal injury hazard.
	Read Operator's Manual	To reduce the risk of injury, user must read and understand operator's manual before using this product.
	Eye Protection	Always wear eye protection with side shields marked to comply with ANSI Z87.1.
	Wet Conditions Alert	Do not expose to rain or use in damp locations.
	Hot Surface	To reduce the risk of injury or damage, avoid contact with any hot surface.
	Recycle Symbol	This product uses Lithium-ion (Li-ion) batteries. Local, state or federal laws may prohibit disposal of batteries in ordinary trash. Consult your local waste authority for information regarding available recycling and/or disposal options.
<b>V</b>	Volts	Voltage
<b>min</b>	minute	Time
	Direct Current	Type or a characteristic of current
<b>.../min</b>	Per Minute	Revolutions, strokes, surface speed, orbits etc., per minute

# Features

## Product Specifications

Maximum Temperature.....990°F (532°C)  
Power Source.....20V Battery Pack(not include)

### **WARNING**

Do not use this product if it is not completely assembled or if any parts appear to be missing or damaged. Use of a product that is not properly and completely assembled or with damaged or missing parts could result in serious personal injury.

### **WARNING**

Do not attempt to modify this product or create accessories or attachments not recommended for use with this product. Any such alteration or modification is misuse and could result in a hazardous condition leading to possible serious personal injury.

### **WARNING**

Do not allow familiarity with this product to make you careless. Remember that a careless fraction of a second is sufficient to inflict serious injury.

### **WARNING**

Always remove battery pack(not include) from the tool when you are assembling parts, making adjustments, cleaning, or when not in use. Removing battery pack(not include) will prevent accidental starting that could cause serious personal injury.

### **WARNING**

Always wear eye protection with side shields marked to completely with ANSI Z87.1. Failure to do so could result in objects being thrown into your eyes and other possible serious injuries.

### **WARNING**

Do not use any attachments or accessories not recommended by the manufacturer of this product. The use of attachments or accessories not recommended can result in serious personal injury.

## Applications

You may use this product for the purposes listed below;

- Soften paint, caulking and putty for easier removal
- Soften adhesives to help remove stickers, floor tiles, wallpaper, etc.
- Shrink tubing for electrical work
- Shrink plastic film for wrapping or weatherproofing



## WARNING

Do not place second hand on top of tool or near nozzle at any time. Holding the tool on or near the nozzle can cause serious personal injury.

- Move the heat gun until the nozzle is close to the area being heated.

**NOTE:** Experiment with scrap materials to determine the proper amount of heat, distance and time for your project.



## WARNING

During heating, move the tool back-and-forth. Avoid lingering or pausing in one spot as this could overheat or potentially ignite the material being heated.

- Allow the heat gun and heating surface to cool completely before storing the tool.

## Maintenance



## WARNING

When servicing, use only identical replacement parts. Use of any other parts could create a hazard or cause product damage.



## WARNING

Before inspecting, cleaning, or servicing the unit, stop the heat gun, wait for the heat gun to cool, and remove the battery pack(not include). Failure to follow these instructions can result in serious personal injury or property damage.

### General Maintenance

Avoid using solvents when cleaning plastic parts. Most plastics are susceptible to damage from various types of commercial solvents and may be damaged by their use. Use clean cloths to remove dirt, dust, oil, grease, etc.

### Cleaning The Heat Gun

The heat gun should be kept clean, dry, and free of oil or grease. Only a mild soap and damp cloth should be used to clean the heat gun. Do not allow liquid to enter the tool.

The high temperatures of the heat gun will cause the nozzle to turn dark over time. This is normal and will not affect its performance or life.

Ventilation openings must be kept clean and free of foreign matter. The most effective method of cleaning the vents is with compressed air. Do not attempt to clean by inserting pointed objects through the openings.

## Storage

Always allow the heat gun to cool to room temperature before storing. Store the heat gun out of reach of children and untrained individuals .



### WARNING

The nozzle of the heat gun will stay hot for several minutes after use. Always allow heat gun to cool before storage.

Following this rule will reduce the risk of serious personal injury or property damage.

## Disposal

### Disposal Of The Product



Under no circumstances should you dispose of this product in normal domestic waste.

Dispose of this product via an approved disposal company or your municipal waste facility. Please observe currently applicable regulations.

Please contact your waste disposal center if you need any further information.



This product's packaging is made from environmentally friendly material and can be disposed of at your local recycling plant.

### Disclaimer

Unless specifically agreed to in writing:

A. We makes no warranty as to the accuracy, sufficiency or suitability of any technical or other information provided in its manuals or other documentation.

B. We assumes no responsibility or liability for loss or damage, whether direct, indirect, consequential or incidental, which might arise out of the use of such information. The use of any such information will be entirely at the user's risk.



Made in China