

FANATEC®

ClubSport

Magnetic Paddle Module



Manual

EN



www.fanatec.com

Thank you for choosing

FANATEC[®]

To get the most out of your ClubSport Magnetic Paddle Module, please read this manual before use. It contains important health and safety information and should be retained for future reference.

INDEX

1. General	3
2. Package Contents	4
3. Compatibility	5
4. Module basic assembly	6
4.1 Setup for large diameter steering wheels	6
4.2 Setup for small diameter steering wheels	6
5. Attachment to ClubSport Steering Wheel Formula V2	7-8
6. Attachment to ClubSport Steering Wheel Universal Hub for Xbox One	9-10
7. Attachment to Podium Hub	11-12
8. Serial Number	13
9. Cleaning	13
10. Trademarks	13
11. End of Life Product Recycling	14
12. FCC Compliance	15
13. CE compliance	15
14. Warranty	16-17

 **WARNING!** Musculoskeletal disorders

Use of game controllers, keyboards, mice, or other electronic input devices may be linked to serious injuries or disorders. When playing video games, as with many activities, you may experience occasional discomfort in your hands, arms, shoulders, neck, or other parts of your body. However, if you experience symptoms such as persistent or recurring discomfort, pain, throbbing, aching, tingling, numbness, burning sensation, or stiffness, **DO NOT IGNORE THESE WARNING SIGNS. PROMPTLY SEE A QUALIFIED HEALTH PROFESSIONAL**, even if symptoms occur when you are not playing a video game. Symptoms such as these can be associated with painful and sometimes permanently disabling injuries or disorders of the nerves, muscles, tendons, blood vessels, and other parts of the body. These musculoskeletal disorders (MSDs) include carpal tunnel syndrome, tendonitis, tenosynovitis, vibration syndromes, and other conditions.

While researchers are not yet able to answer many questions about MSDs, there is general agreement that many factors may be linked to their occurrence, including medical and physical conditions, stress and how one copes with it, overall health, and how a person positions and uses their body during work and other activities (including playing a video game). Some studies suggest that the amount of time a person performs an activity may also be a factor. If you have questions about how your own lifestyle, activities, or medical or physical condition may be related to MSDs, see a qualified health professional.

1

GENERAL **ATTENTION**

- The device must not be exposed to rain or humidity in order to avoid risk of fire and/or electric shock.
- Operating room temperature: 15°C – 35°C room temperature
- The recommended operation time of the wheel with continuous force feedback activity is 1 hour.
- Excessive use may cause health risks. We recommend to take a break of 5 minutes every 20 minutes, and do not drive for more than 2 hours per day.
- Not intended for children under the age of 6 years old. Contains small pieces which pose a choking hazard!
- This device contains components that cannot be repaired by the user, unauthorized disassembly or modification will void the warranty.

 **WARNING!** Electrical Safety

- The ClubSport Magnetic Paddle Module must be connected to a compatible steering wheel and never to any other power source besides that!
- To avoid damage, do not expose your ClubSport Magnetic Paddle Module to sources of heat.
- Use the ClubSport Magnetic Paddle Module only with compatible FANATEC® steering wheels.
- If the ClubSport Magnetic Paddle Module becomes damaged in any way, stop using it immediately and contact Technical Customer Support at www.fanatec.com/support/faq.

 **GENERAL NOTES**

- For use of the ClubSport Magnetic Paddle Module please make sure that you have installed the most recent firmware of your Fanatec wheel base and steering wheel. The ClubSport Magnetic Paddle Module does not have a firmware itself. You can obtain the driver package including firmware from the Media / Downloads section of www.fanatec.com. A Windows PC is required to update your firmware.
- All specifications in this document are subject to change. The ClubSport Magnetic Paddle Module, firmware, and / or PC driver may be updated to implement new features or general improvements.
- This manual mentions Fanatec steering wheels and/or other products which are not included within the ClubSport Magnetic Paddle Module package and sold separately. You can obtain them from the Fanatec webshop: www.fanatec.com
- This manual discusses assembly, connections, and functions related to Fanatec® steering wheels and other additional devices. This is not a replacement manual for the other corresponding products! Read the quick guides or user manuals for the other products as well!
- The warranty does not include defects that are due to commercial use of the product. See chapter “Warranty” at the end of this user manual as well as the Terms & Conditions at www.fanatec.com for more details.

2 PACKAGE CONTENTS

Order	Item	Quantity
A	ClubSport MPM core units	2
B	GT paddles	2
C	Formula paddles	2
D	Paddle plate spacers	2
E	4	
F	M3x7 mm bolts	8
G	M3x12 mm bolts	4
H	M5x12 mm bolts	4
I	4 mm Allen key	1
J	2 mm Allen key	1

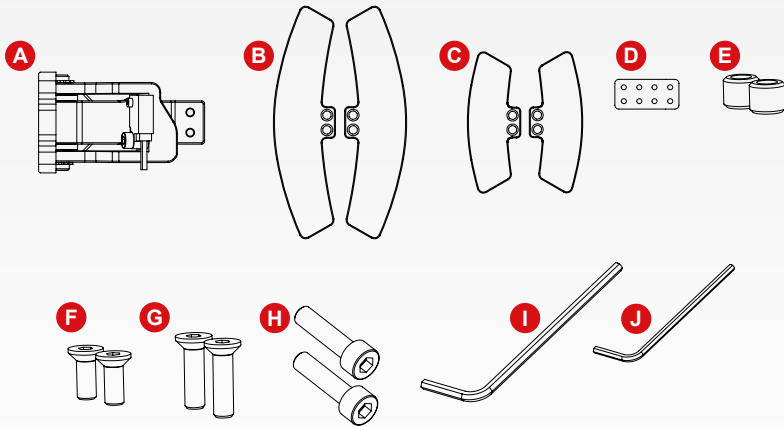

IMPORTANT: Avoid dropping objects on or rubbing objects against the magnets to prevent scratches.

3

COMPATIBILITY

The ClubSport Magnetic Paddle Module can be used with several Fanatec products, including the ClubSport Steering Wheel Formula V2 (including limited edition F1® 20xx wheels and F1® PS4 wheel from the Podium Racing Wheel F1® package), the ClubSport Universal Hub for Xbox One, and the Podium Hub. Please check the compatibility section of the ClubSport Magnetic Paddle Module product page on our webshop for detailed compatibility information: www.fanatec.com

The ClubSport Magnetic Paddle Module is compatible with PC and other systems, depending on the compatibility of your wheel base and / or your steering wheel. For example you need an Xbox One licensed Fanatec steering wheel attached on any Fanatec wheel base to use the ClubSport Magnetic Paddle Module on Xbox One or the new-generation Xbox.

Please check the compatibility information of your wheel base and steering wheel.

 **IMPORTANT:** Please make sure you have installed the latest firmware on your wheel base and steering wheel. A Windows PC is required to update your firmware.

4

MODULE BASIC ASSEMBLY

! **IMPORTANT:** For compatibility information and additional assembly instructions please refer to the manual of the selected steering wheel.

4.1 Setup for steering wheels with a diameter larger than 28 cm (GT):

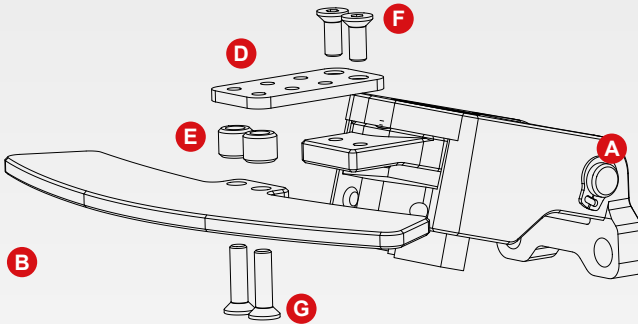

4.2 Setup for steering wheels with a diameter smaller than 28 cm (Formula):

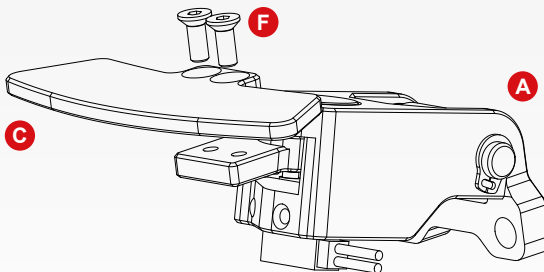

NOTE: Both the GT and Formula paddles as well as the ClubSport MPM core units are symmetrical and can be used as left or right shifter paddles respectively.

5 ATTACHMENT TO CLUBSPORT STEERING WHEEL FORMULA V2

- 1** Loosen the two bolts highlighted in red using the 2 mm Allen key (J).

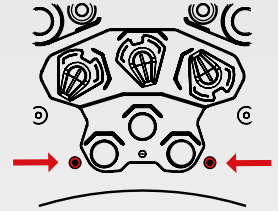

- 2** Remove the rear cover.

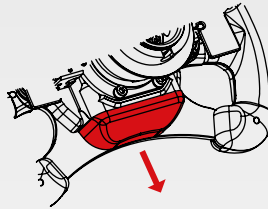

- 3** Disconnect the standard shifter paddle cables.

NOTE: Carefully pull on the plastic connectors and not the cables of the standard shifter paddle modules.

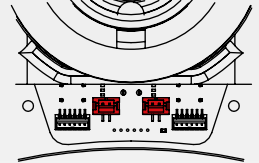

- 4** Loosen the shifter paddle bolts marked in red using a 2.5 mm Allen key (not included) for clearance to the mounting bolts of the standard paddle modules.

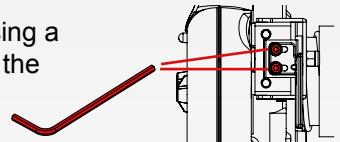

- 5** Loosen the mounting bolts marked in red using a 4 mm Allen key (I) to detach the standard paddle modules.

NOTE: Store the mounting bolts with the standard shifter paddles for later use.

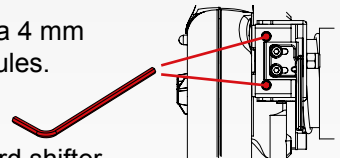

- 6** Insert the cables of the ClubSport Magnetic Paddle Module before attaching the modules. Once the cables are completely pushed through, attach the modules using the included M5x12 mm bolts (H) and tighten them.

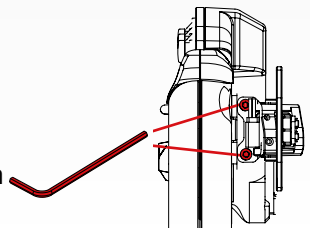

- 7 Connect each of the ClubSport Magnetic Paddle Module connectors to the highlighted sockets and arrange the cables neatly.

IMPORTANT: The connector plugs have only one correct orientation. Position the cables carefully inside the housing before reattaching the rear cover to avoid damage.

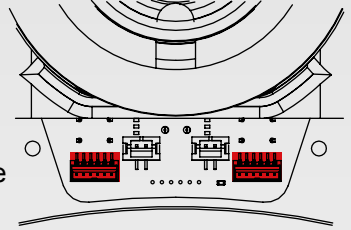

- 8 Reattach the rear cover, insert and tighten the two bolts using the 2 mm Allen key (J) as in the first step.

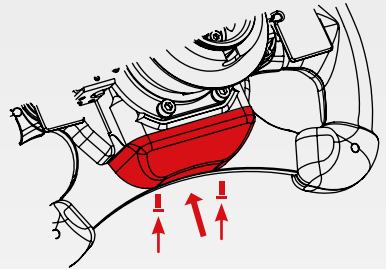

6 ATTACHMENT TO CLUBSPORT STEERING WHEEL UNIVERSAL HUB FOR XBOX ONE

- 1 Loosen and remove the four bolts on the back of the Universal Hub main body using a 3 mm Allen key (not included). Detach the front cover to open the housing, allowing access to the connectors inside.

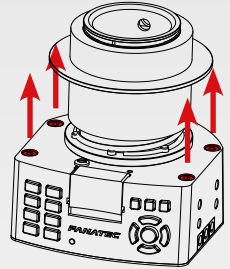

- 2 Disconnect the standard shifter paddle cables.

NOTE: Carefully pull on the plastic connectors and not the cables of the standard shifter paddle modules.

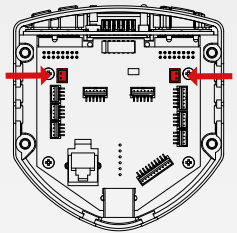

- 3 Loosen the mounting bolts marked in red using a 4 mm Allen key (l) to detach the standard paddle modules.

NOTE: Store the mounting bolts with the standard shifter paddles for later use.

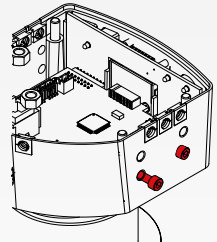

NOTE: There are two mounting positions on the sides of the Universal Hub depending on the selected steering wheel.

Example: Use “Position 1” for dished steering wheels and “Position 2” for flat steering wheels.

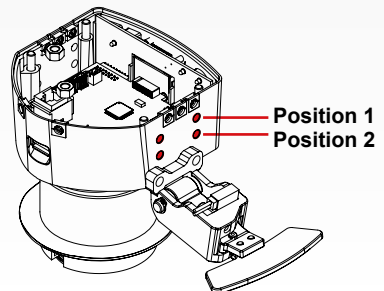

- 4 Attach the ClubSport Magnetic Paddle Module using the included M5x12 mm bolts (H) and tighten them using a 4 mm Allen key (I).

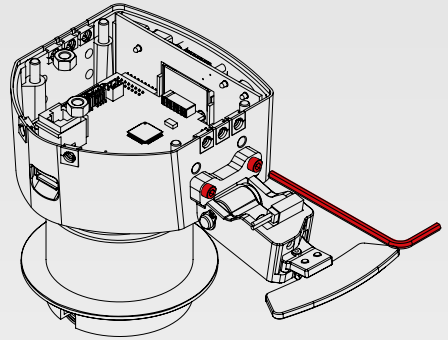

- 5 Connect the ClubSport Magnetic Paddle Module cables to the highlighted sockets.

IMPORTANT: The connector plugs have only one correct orientation. Position the cables carefully inside the housing before reattaching the front cover to avoid damage.

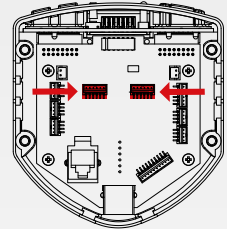

- 6 Insert and tighten the four bolts using a 3 mm Allen key (not included).

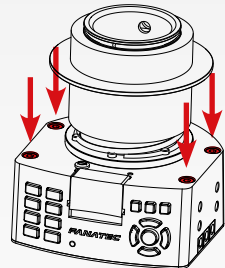

7

**ATTACHMENT TO
PODIUM HUB**

- 1** Loosen the three highlighted bolts on the front cover using a 2 mm Allen key (J).

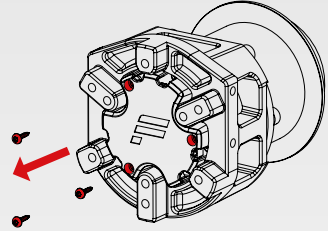

- 2** Remove the front cover.

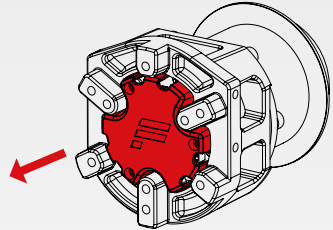

- 3** Attach the ClubSport Magnetic Paddle Module using the M5x12 mm bolts (H) and tighten them using the 4 mm Allen key (I).

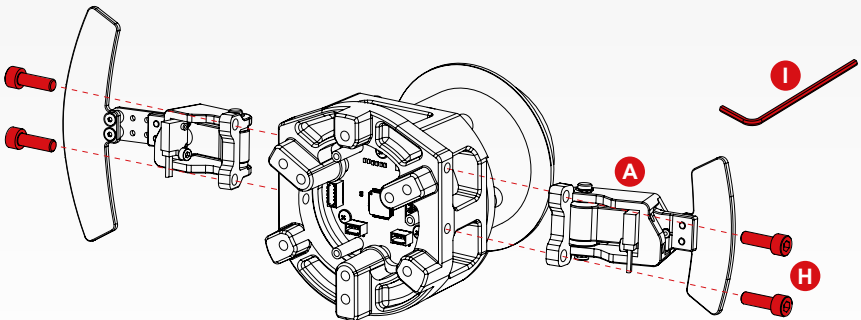

- 4 Connect the ClubSport Magnetic Paddle Module cables to the highlighted sockets.

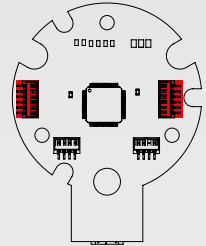

IMPORTANT: The connector plugs have only one correct orientation. Position the cables carefully inside the housing before reattaching the front cover to avoid damage.

- 5 Attach the front cover, insert and tighten the three bolts.

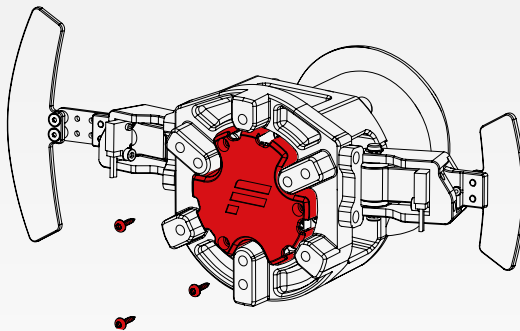

8 SERIAL NUMBER

Before contacting the Technical Customer Support please note the serial number of your ClubSport Magnetic Paddle Module:

- ClubSport Magnetic Paddle Module:

To find your serial number, please check the label of your product box where it reads “S/N:”

The serial number of the ClubSport Magnetic Paddle Module starts with letters ‘SL’ and has additional 8 numbers, for example: **SL12704023**.

9 CLEANING

Clean only with a dry or slightly damp cloth. Using cleaning solutions may damage your ClubSport Magnetic Paddle Module.

10 TRADEMARKS

“FANATEC®” and “Endor®” are registered trademarks of Endor® AG/Germany. All rights reserved.

All other trademarks are the property of their respective owners.

11**END OF LIFE PRODUCT
RECYCLING**

Please follow your local regulations when disposing of this product as e-waste.

In the European Union: At the end of its working life, this product should not be disposed of with standard household waste, but rather dropped off at a collection point for the disposal of Waste Electrical and Electronic Equipment (WEEE) for recycling.

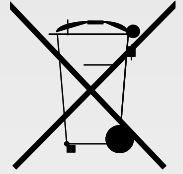

Depending on their characteristics, the materials may be recycled. Through recycling and other forms of processing Waste Electrical and Electronic Equipment, you can make a significant contribution towards helping to protect the environment.



Please contact your local authorities for information on the collection point nearest you.

For all other countries: Please adhere to local recycling laws for electrical and electronic equipment.

Retain this information. Colours and decorations may vary.

In the European Union: The packaging materials can be depolluted for recycling according to the legal regulations depending on the country responsible for the corresponding law.



For all other countries: Please adhere to local recycling laws for packaging materials.

12

FCC COMPLIANCE

This device complies with part 15 of the FCC rules. The operation of this device is subject to the following two conditions:

- This device may not cause harmful interference, and must accept any interference received, including interference that may cause undesired operation.
- This device was not modified different than described explicitly in this user manual.



Note: This device was tested and approved to the limitations for class B of digital devices according to part 15 of the FCC rules. This limitations should ensure an adequate protection against harming interferences in residential areas. However, a warranty for non occurring of interferences is not assumed.

Do not modify the device different than described explicitly in this user manual. Nevertheless, if you do modifications different from the described in this manual you can be determined to stop the operation of the device.

13

CE COMPLIANCE

This device complies with the European product regulations according to CE regulations.

The CE regulations contain basic requirements for safe usage of technical products.



Endor® AG (“Endor”) warrants to the original purchaser that the Fanatec® product, which includes components contained in the retail box with this product will be free from material defects in material and workmanship for a period of one year from the original date of purchase (the “Warranty Period”). This warranty is valid in the country where the product was purchased. **If this product is determined to be materially defective during the warranty period, your sole remedy and Endor’s sole and exclusive liability is limited to the repair or replacement of this product with a factory-recertified product, at Endor’s discretion.** For purposes of this Limited Hardware Warranty and Liability, “factory recertified” means a product that has been returned to its original specifications.

This warranty does not apply if this product

- a) is used with products that are not expressly declared in the product descriptions as compatible with this product;**
- b) is used with peripherals Endor does not license, expressly approve or sell. This includes non-licensed hardware enhancement devices, controllers, adaptors, and power supply devices (“non-licensed/non-approved peripherals”);**
- c) is used for any commercial purpose, including rental or arcade purposes;**
- d) is modified or tampered with contrary to the operating and maintenance instructions;**
- e) is damaged by the acts of God (natural disasters), negligence, accidents, wear and tear, unreasonable use, or by causes unrelated to defective materials or workmanship;**
- f) has the serial number altered, defaced or removed (where applicable);**
- g) has the warranty seal altered, defaced or removed (where applicable).**

This warranty does not cover consumables (such as batteries) or products sold and clearly marked “AS IS” or with faults. Endor may void this warranty if

- 1) Endor reasonably believes that the product has been used in a manner that violates the terms of a separate end user agreement for firmware,**

- system software or game software;
- 2) the product is used with non-licensed/non-approved peripherals. Consumer assume all risks and liabilities associated with use of third-party products.

This warranty is provided to you in lieu of all other express or implied warranties. This includes warranties of merchantability and fitness for a particular purpose for this product, which Endor disclaims under these terms. However, if applicable law requires any of these warranties, then they are limited in duration to the warranty period.

Except as expressly stated above, Endor excludes all liability for loss of data, loss of profit, or any loss or damage suffered by you or any third party, whether those damages are direct, indirect, consequential, special, or incidental and however arising under any theory of law, as a result of using this product. Some states or provinces do not allow limitations on how long an implied warranty lasts and some states do not allow the exclusion or limitations of consequential or incidental damages, so these limitations or exclusions may not apply to you. This warranty gives you specific legal rights. You may also have other rights which vary from state to state or province to province. The warranty offered by Endor on this product is the same whether or not you register your product.

This warranty does not apply to any system software / firmware that is pre-installed in the purchased product, or is subsequently provided via update or upgrade releases. In case of issues apparently related to system software / firmware as well as any other product related issues, Endor recommends checking the FAQ database at www.fanatec.com/support/faq to see if your problem can be solved there.

Manufactured by



Fanatec® is a registered trademark of Endor AG
Designed and developed by Endor AG in Germany

E.ON-Allee 3 - 84036 Landshut - Germany
Telephone: +49 (871) 9221-122 Fax: +49 (871) 9221-221
Email: info.webshop@fanatec.com
Website: www.fanatec.com - www.endor.ag

Designed in Germany
Made in China