

# FANATEC®

## CSL Pedals



**Manual**

**EN**

Rev. 01

**Thank you for choosing**

***FANATEC***<sup>®</sup>

**To get the most out of your CSL Pedals, please read this manual before first use. It contains important health and safety information and should be retained for future reference.**

# INDEX

<b>1. General</b> .....	<b>1</b>
<b>2. Compatibility</b> .....	<b>2</b>
<b>3. Package Contents</b> .....	<b>3</b>
<b>4. Assembly</b> .....	<b>4-12</b>
<b>4.1 Plan Your Setup</b> .....	<b>4</b>
<b>4.2 Pedal Adjustment</b> .....	<b>5-7</b>
<b>4.3 Hard-Mount</b> .....	<b>8</b>
<b>4.4 Connections</b> .....	<b>9</b>
<b>4.5 Recommended Accessories</b> .....	<b>10-12</b>
<b>5. Cleaning</b> .....	<b>13</b>
<b>6. Maintenance</b> .....	<b>13</b>
<b>7. Troubleshooting</b> .....	<b>14</b>
<b>8. Video Guide</b> .....	<b>15</b>
<b>9. Serial number</b> .....	<b>15</b>
<b>10. Trademarks</b> .....	<b>15</b>
<b>11. Product Recycling</b> .....	<b>15</b>
<b>12. Compliance</b> .....	<b>16</b>
<b>13. Warranty</b> .....	<b>17</b>

## **WARNING!** Photosensitive Seizures

A small percentage of people may experience a seizure when exposed to certain visual images, including flashing lights or patterns that may appear in video games. Even people who have no history of seizures or epilepsy may have an undiagnosed condition that can cause these “photosensitive epileptic seizures” while watching video games. These seizures may have a variety of symptoms, including light-headedness, altered vision, eye or face twitching, jerking or shaking of arms or legs, disorientation, confusion, or momentary loss of awareness. Seizures may also cause loss of consciousness or convulsions that can lead to injury from falling down or striking nearby objects. Immediately stop playing and consult a doctor if you experience any of these symptoms. Parents should watch for or ask their children about the above symptoms – children and teenagers are more likely than adults to experience these seizures. The risk of photosensitive epileptic seizures may be reduced by taking the following precautions:

- Sit farther from the TV screen.
- Use a smaller TV screen.
- Play in a well-lit room.
- Do not play when you are drowsy or fatigued.

If you or any of your relatives have a history of seizures or epilepsy, consult a doctor before playing.

## **WARNING!** Musculoskeletal disorders

Use of game controllers, keyboards, mice, or other electronic input devices may be linked to serious injuries or disorders. When playing video games, as with many activities, you may experience occasional discomfort in your hands, arms, shoulders, neck, or other parts of your body. However, if you experience symptoms such as persistent or recurring discomfort, pain, throbbing, aching, tingling, numbness, burning sensation, or stiffness, **DO NOT IGNORE THESE WARNING SIGNS. PROMPTLY SEE A QUALIFIED HEALTH PROFESSIONAL**, even if symptoms occur when you are not playing a video game. Symptoms such as these can be associated with painful and sometimes permanently disabling injuries or disorders of the nerves, muscles, tendons, blood vessels, and other parts of the body. These musculoskeletal disorders (MSDs) include carpal tunnel syndrome, tendonitis, tenosynovitis, vibration syndromes, and other conditions.

While researchers are not yet able to answer many questions about MSDs, there is general agreement that many factors may be linked to their occurrence, including medical and physical conditions, stress and how one copes with it, overall health, and how a person positions and uses their body during work and other activities (including playing a video game). Some studies suggest that the amount of time a person performs an activity may also be a factor. If you have questions about how your own lifestyle, activities, or medical or physical condition may be related to MSDs, see a qualified health professional.

**1 GENERAL****⚠ ATTENTION!**

- The device must not be exposed to rain or humidity in order to avoid risk of fire and / or electric shock.
- Operating room temperature: 15°C - 35°C
- Excessive use may cause health risks. We recommend taking a 5 minute break after every 20 minutes of use. Do not drive for more than 2 hours per day.
- We strongly advise you to not drive a vehicle immediately after using a video game.
- In case of interference with other wireless 2.4 GHz devices, the interfering devices must be removed or switched off.
- Not intended for children under the age of 6 years old. Contains small pieces which pose a choking hazard!
- Do not open the casing of the device.
- This device contains components that cannot be repaired by the user, opening will void the warranty.

**⚠ WARNING! Electrical Safety:**

The CSL Pedals must be connected to the appropriate wheel base port or PC USB port if using the ClubSport USB Adapter:

- If the CSL Pedals becomes damaged in any way, stop usage immediately and contact Fanatec® Customer Support: [Fanatec.com/support/faq](https://www.fanatec.com/support/faq).
- All specifications in this document are subject to change. The PC driver may be updated to implement new features or general improvements.
- This manual discusses assembly, connections, and functions related to Fanatec® devices and other additional devices. This is not a replacement manual for the other corresponding products! Read the quick guides or user manuals for the other products!
- The warranty does not include defects that are due to commercial use of the product. See chapter “Warranty” at the end of this user manual as well as the Terms & Conditions on [Fanatec.com](https://www.fanatec.com) for more details.

## 2

## COMPATIBILITY

The CSL Pedals can be used with all CSL, CSL Elite, ClubSport, and Podium series wheel bases as well as standalone on a PC via the ClubSport USB Adapter.

**IMPORTANT:** CSL Pedals are fully usable out-of-the-box. We always recommend updating your Fanatec® devices to the latest firmware. A Windows PC and PC mode selected on the wheel base is required to perform firmware updates. Download the latest PC driver containing the latest firmwares from [fanatec.com/driver](https://www.fanatec.com/driver)

### 3 PACKAGE CONTENTS

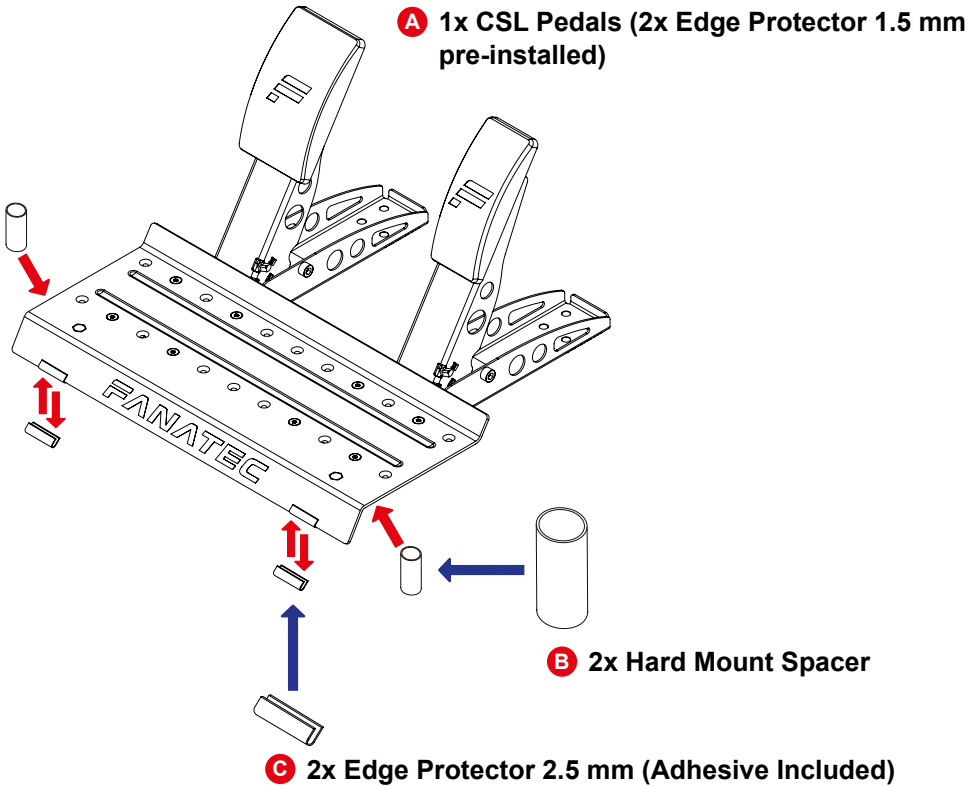

 **D** 8x M4x12 mm Countersunk Mounting Bolts

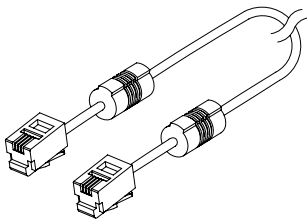

**E** 1x RJ12 Cable



**F** 1x T20 Torx Key

## 4 ASSEMBLY

### 4.1 PLAN YOUR SETUP

To get started with using the CSL Pedals, decide on your preferred pedal lever unit positions, pedal plate positions, and if you will hard-mount to a surface, then connect the CSL Pedals to your wheel base via the included RJ12 cable or to a PC via USB if using the ClubSport USB Adapter (not included). It is important to follow the chapter sequence of this manual for an effective assembly and setup procedure.

**ATTENTION:** See chapter 4.4 “Connections” for which type of add-on peripheral devices must be connected to which port of the CSL Pedals. Only use the included RJ12 cable from your CSL Pedals package contents to avoid damages!

**ATTENTION:** Rest the CSL Pedals box on its side in order to remove the contents without dropping any items and to avoid damages!

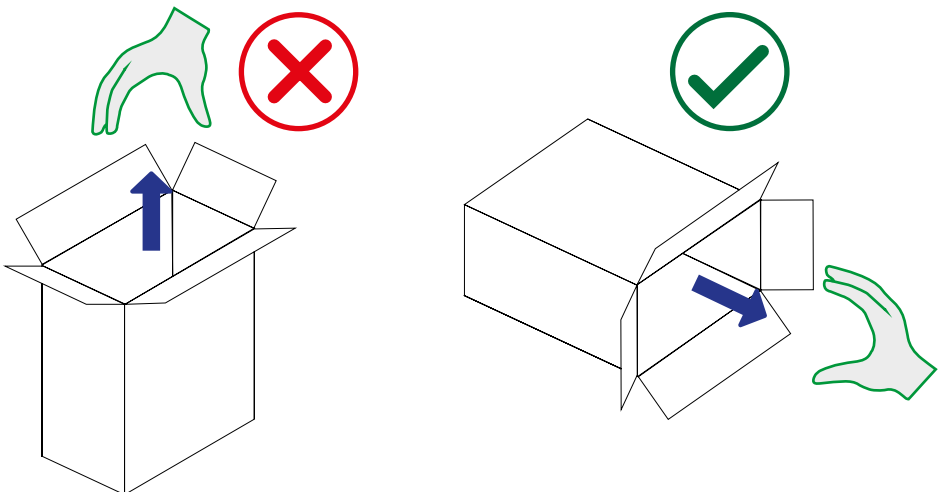

4.2 PEDAL ADJUSTMENT

4.2.1 PEDAL LEVER UNITS

1

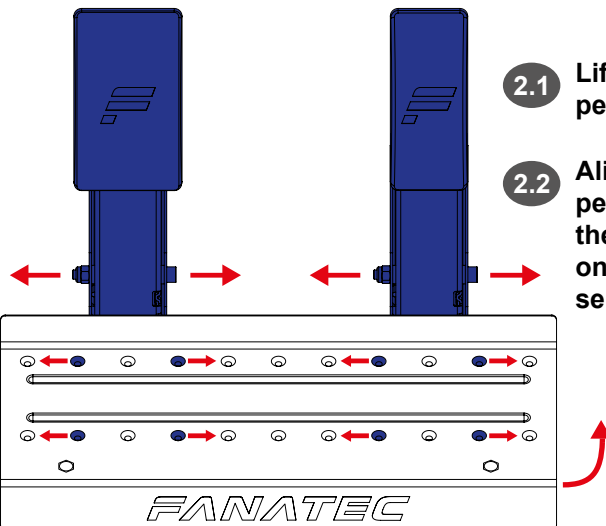

2.1 Lift the heel rest from the pedal units.

2.2 Align the holes of the pedal lever units with the holes of the heel rest once a desired position is selected.

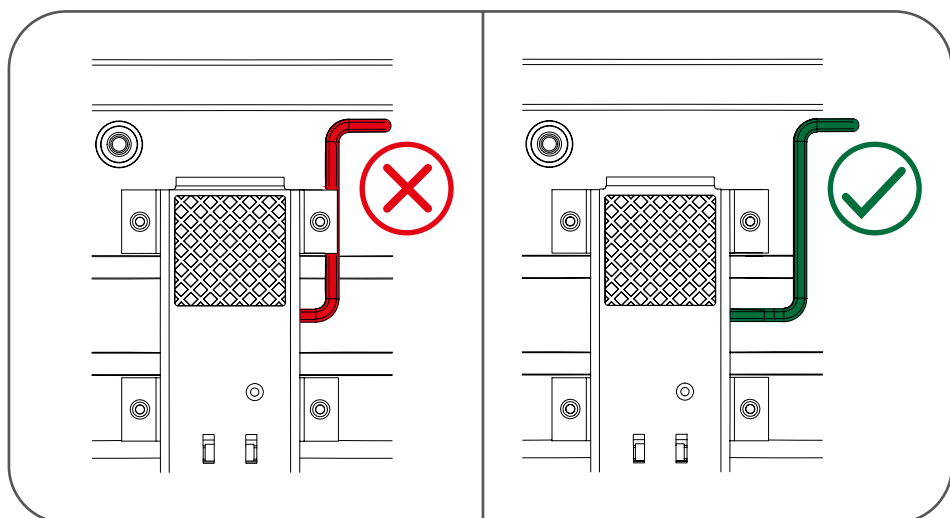

2

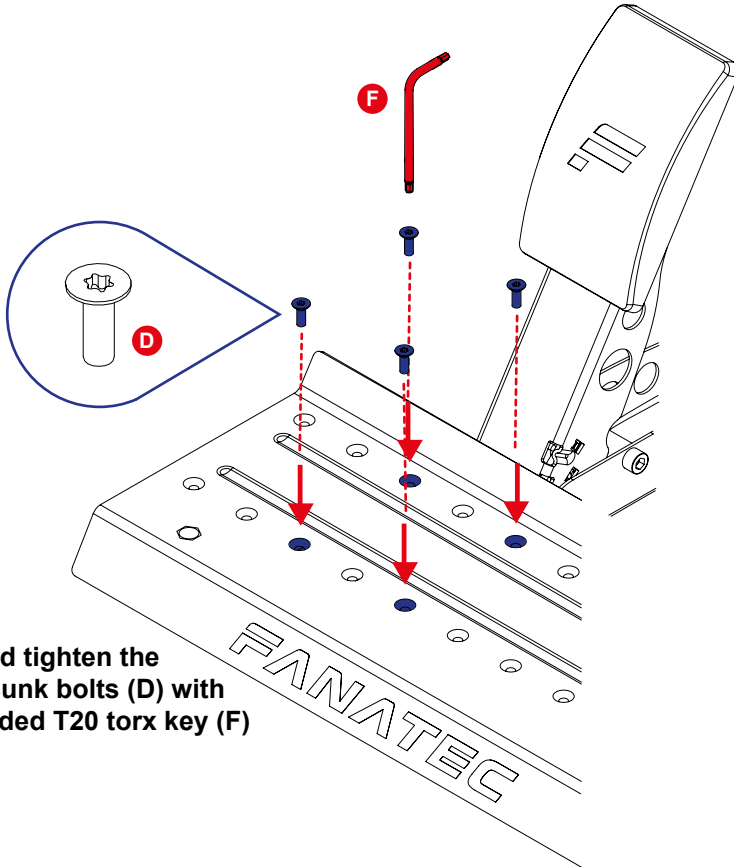

Insert and tighten the countersunk bolts (D) with the included T20 torx key (F)

**NOTE:** Use either the pre-installed 1.5 mm or 2.5 mm edge protectors (C) (including adhesive) when using the pedals on a floor as shown below.

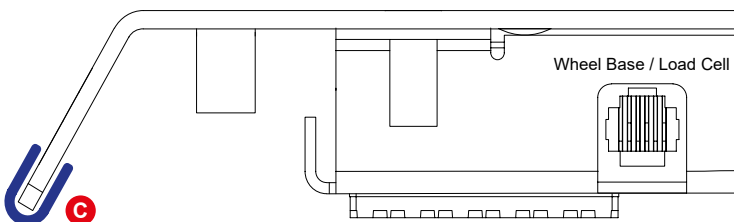

**4.2.2 PEDAL PLATES**

All CSL Pedals pedal lever units feature adjustable pedal plates to suit your pedal plate height preferences. There are 3 height settings that can be adjusted in descending increments of 15 mm. Use the included T20 torx key (F) to loosen the bolts in order to perform the adjustment.

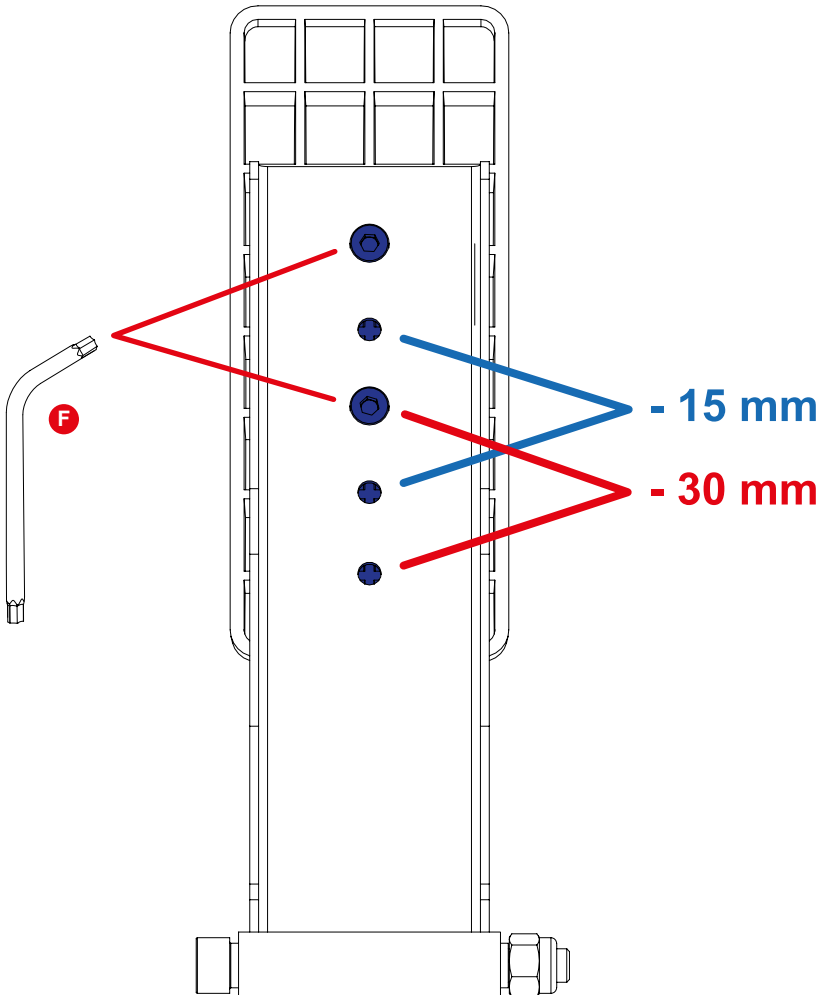

4.3 HARD-MOUNT

Hard-mount using all four mounting holes (bolts are not included). Download the **drilling template** from the product page on **fanatec.com**.

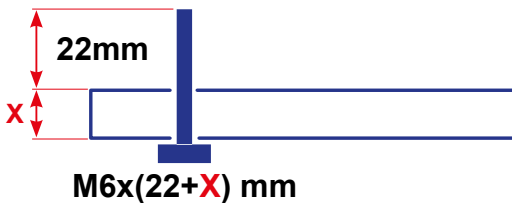
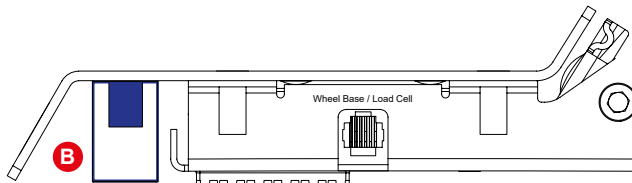
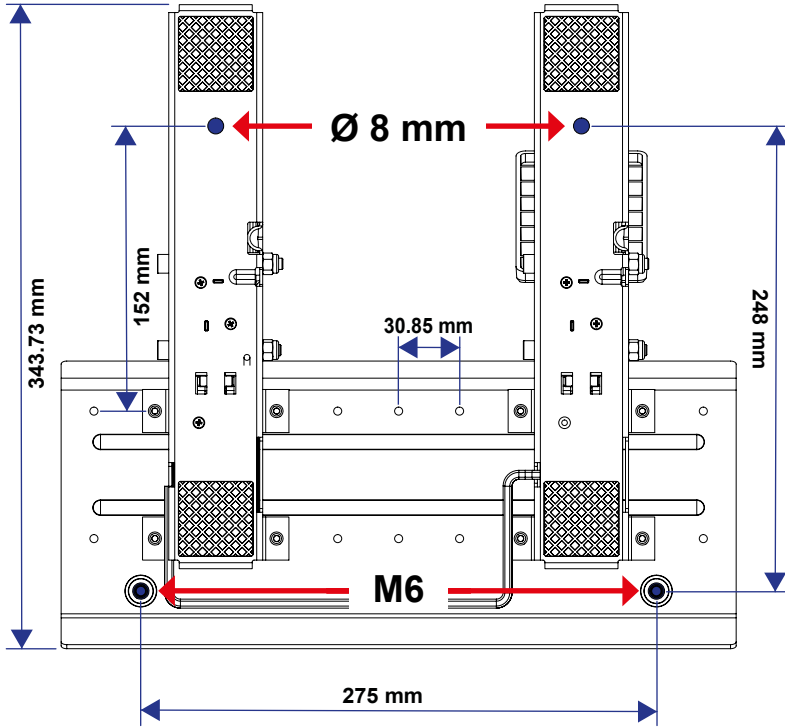

**4.4 CONNECTIONS**

**ATTENTION:** Do not connect any devices via the RJ12 ports found on the gas pedal lever unit which are not appropriate Fanatec® products. Doing so may cause damage to the pedal set and / or connected devices, and is not covered by the warranty.

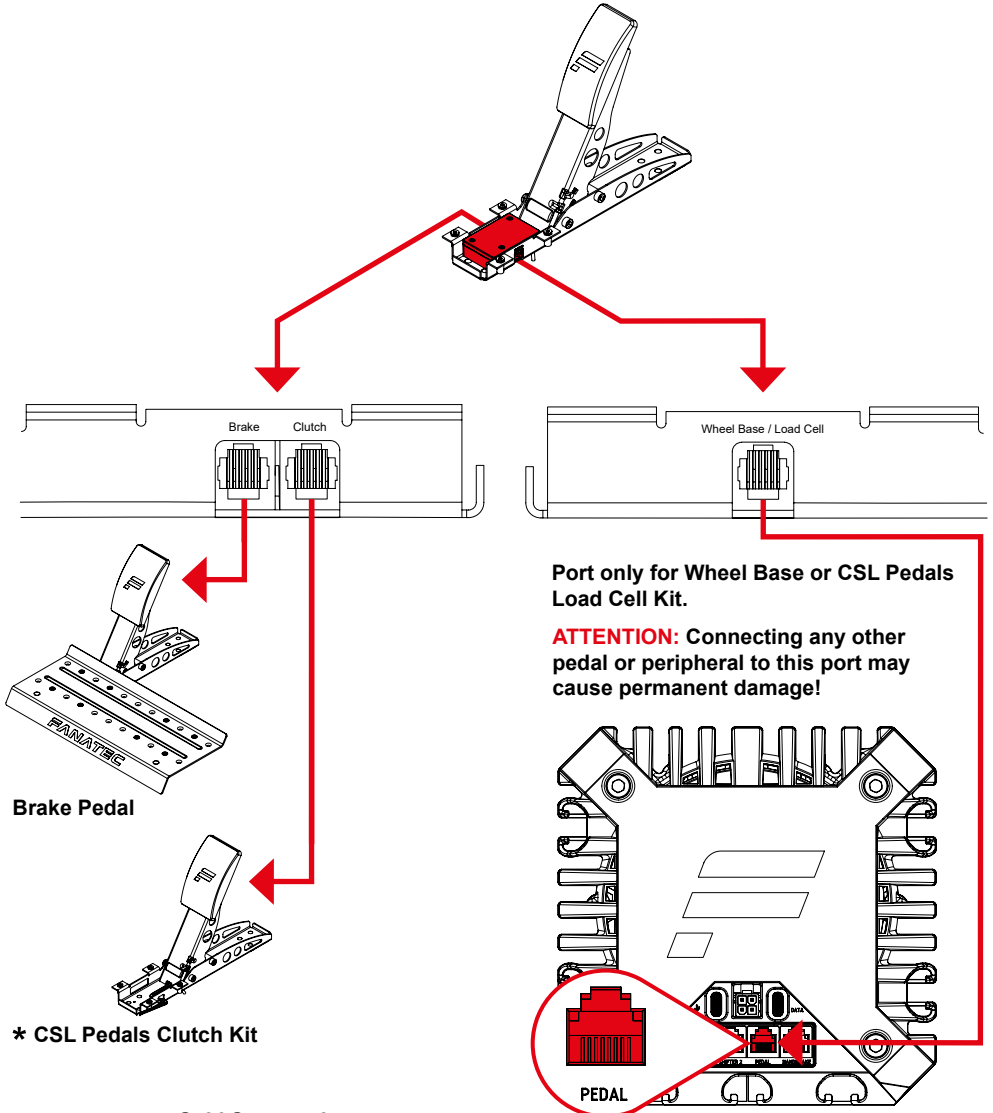

\* Sold Separately

**4.5 RECOMMENDED ACCESSORIES**

We highly recommend the following accessories to upgrade the functionality of your CSL Pedals. Check them out at [fanatec.com](https://fanatec.com).

**NOTE:** Please read the quick guides of the following accessories for assembly instructions and information.

**CSL** Pedals Clutch Kit

Check it out [here](#).

**ClubSport**  
USB Adapter

Check it out [here](#).

**NOTE:** The ClubSport USB Adapter is essential if you want to use the CSL Pedals as a standalone device on PC via USB.

**Firmware installation instructions using the ClubSport USB Adapter**

1

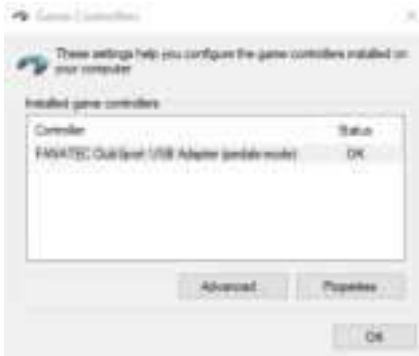

Download the latest PC driver from [fanatec.com/driver](http://fanatec.com/driver) in order to proceed. Follow instructions provided by the **Driver & Firmware Instruction Manual** found on the product page.

Once installed, open the driver window and select 'FANATEC ClubSport USB Adapter (pedals mode)', then click on 'Properties'.

2



From the 'Pedals Picture Shown' drop-down menu, select either 'CSL P (no Clutch)', or 'CSL P (with Clutch)' to accurately represent your CSL Pedals.

**3**

Click on the 'Update' tab in the top left of the window, then click on 'Update USB Adapter Firmware' to proceed to the 'Fanatec CSUA Firmware Updater'.

**4**

Click on 'CSL Pedals' to select the correct firmware, then click 'Start Update' to initiate the firmware update.

**5**

Once completed, the message highlighted in blue will be displayed in the 'Message Logs' information box as shown in the image to the left. Once this message has been displayed you can close the firmware updater window by clicking on the 'X' in the top right corner.

## 5 CLEANING

Clean only with a dry or slightly damp microfibre cloth. Using cleaning solutions may damage your CSL Pedals.

## 6 MAINTENANCE

The appropriate parts of the CSL Pedals are well lubricated with lithium grease out-of-the-box. Should you feel or hear grinding as a result of extensive usage over time, apply lithium grease to the parts highlighted in **BLUE** below.

**ATTENTION:** Do not apply any form of lubricant to the parts highlighted in **RED** below.

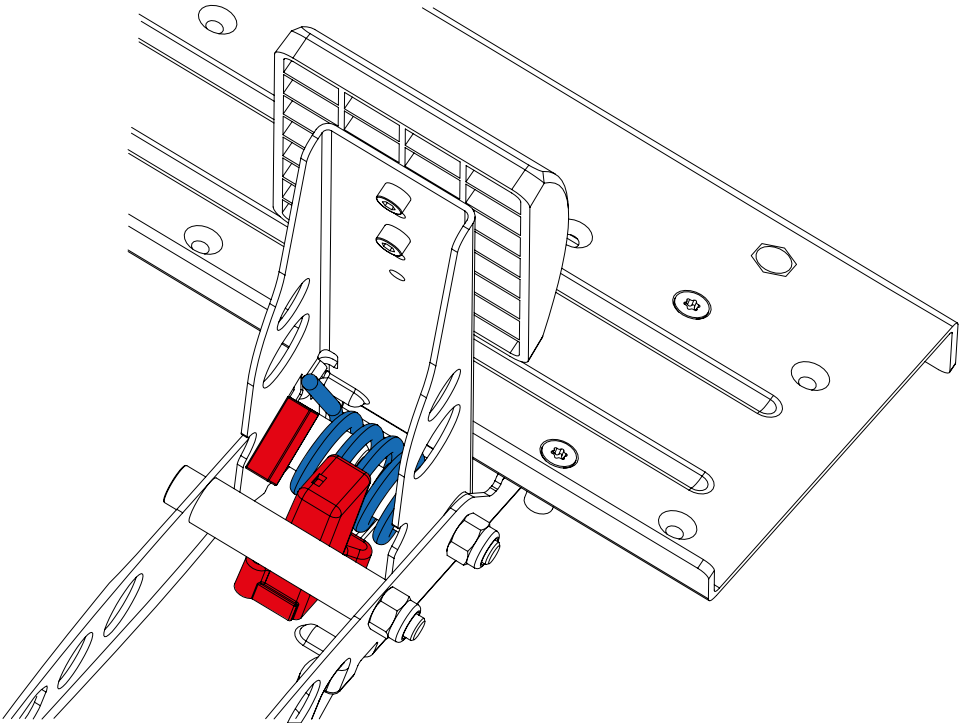

## 7 TROUBLESHOOTING

The CSL Pedals must not be modified in any way, other than what is explicitly described in this manual. Endor® AG expressly prohibits analysis and utilisation of the electronics, hardware, software and firmware contained in this device. In case difficulties occur regarding utilisation of the CSL Pedals, please use the following troubleshooting guide. You will find further details and contact information on [Fanatec.com/support/faq](https://fanatec.com/support/faq).

If the CSL Pedals is not working properly:

Problem description	Solution
The PC driver or the wheel base does not recognise the CSL Pedals.	Make sure that you have updated your wheel base and ClubSport USB Adapter firmware to the latest firmware version contained within the latest PC driver which can be downloaded from <a href="https://fanatec.com/driver">fanatec.com/driver</a> .
	Ensure that you are using the RJ12 cable included with the CSL Pedals package.
	Ensure that the RJ12 cables are plugged in the correct ports of the CSL Pedals located on the gas pedal module and the correct ports of the wheel base and ClubSport USB Adapter. See section 4.4 “Connections”

**8 VIDEO GUIDE**

Watch our video guides:

CSL Pedals: [Fanatec.com/QR/CSL-P](https://www.fanatec.com/QR/CSL-P)

CSL Pedals Clutch Kit: [Fanatec.com/QR/CSL-P-CK](https://www.fanatec.com/QR/CSL-P-CK)

CSL Pedals Tuning Kit: [Fanatec.com/QR/CSL-P-TK](https://www.fanatec.com/QR/CSL-P-TK)

**9 SERIAL NUMBER**

Before contacting Fanatec® Customer Support please note the serial number of your CSL Pedals:

CSL Pedals: .....

The serial number is located at the bottom of the gas pedal unit.

The serial number of the CSL Pedals starts with letters 'GW' and has additional 8 numbers, for example: **GW021000370**.

**10 TRADEMARKS**

“Fanatec®”, “Endor®”, “Podium”, “ClubSport”, and “FluxBarrier” are registered trademarks of Endor AG. Designed and developed by Endor AG in Germany

All other trademarks are the property of their respective owners.

**11 PRODUCT RECYCLING**

Please follow your local regulations when disposing of this product as e-waste.

**12 COMPLIANCE**

**CE COMPLIANCE**



This device complies with the European product regulations according to CE regulations. The CE regulations contain basic requirements for safe usage of technical products.

**FCC COMPLIANCE**



This device complies with part 15 of the FCC rules. The operation of this device is subject to the following two conditions:

- This device may not cause harmful interference, and must accept any interference received, including interference that may cause undesired operation.
- This device was not modified differently than described explicitly in this user manual.

**NOTE:** This device was tested and approved to the limitations for class B of digital devices according to part 15 of the FCC rules. This limitation should ensure an adequate protection against harmful interferences in residential areas. However, a warranty for the non-recurring of interferences is not assumed.

Do not modify the device differently than explicitly described in this user manual. Nevertheless, if you do modify the device differently than explicitly described in the product-related manual, you can be determined to stop the operation of the device.



Contact | Зв'язатися:  
Endor AG  
E.ON-Allee 3 - 84036 Landshut - Germany  
Telephone | Телефон: +49 (871) 9221-122  
Email | Електронна пошта: info.webshop@fanatec.com

This product meets the requirements of the Technical Regulations which limit the use of certain hazardous substances in electrical and electronic equipment.

Цей продукт відповідає вимогам RoHS (Директива ЄС 2011/65 / ЄС).

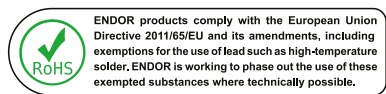

## 13 WARRANTY

Endor® AG (“Endor”) or local subsidiaries warrants to the original purchaser that the Fanatec® product, which includes components contained in the retail box with this product will be free from material defects in material and workmanship for a period of one year from the original date of purchase (the “Warranty Period”). This warranty is valid in the country where the product was purchased. **If this product is determined to be materially defective during the warranty period, your sole remedy and Endor’s sole and exclusive liability is limited to the repair or replacement of this product with a factory-recertified product, at Endor’s option.** For purposes of this Limited Hardware Warranty and Liability, “factory recertified” means a product that has been returned to its original specifications.

### This warranty does not apply if this product

- a) is used with products that are not expressly declared in the product descriptions as compatible with this product;
- b) is used with peripherals Endor does not license, expressly approve or sell. This includes non-licensed hardware enhancement devices, controllers, adaptors, and power supply devices (“non-licensed/non-approved peripherals”);
- c) is used for any commercial purpose, including rental or arcade purposes;
- d) is modified or tampered with contrary to the operating and maintenance instructions;
- e) is damaged by the acts of God (natural disasters), negligence, accidents, wear and tear, unreasonable use, or by causes unrelated to defective materials or workmanship;
- f) has the serial number altered, defaced or removed (where applicable);
- g) has the warranty seal altered, defaced or removed (where applicable).

This warranty does not cover consumables (such as batteries) or products sold and clearly marked “AS IS” or with faults. Endor may void this warranty if

- 1) Endor reasonably believes that the product has been used in a manner that violates the terms of a separate end user agreement for firmware, system software or game software;
- 2) the product is used with non-licensed/non-approved peripherals. Consumer assume all risks and liabilities associated with use of third-party products.

This warranty is provided to you in lieu of all other express or implied warranties. This includes warranties of merchantability and fitness for a particular purpose for this product, which Endor disclaims under these terms. However, if applicable law requires any of these warranties, then they are limited in duration to the warranty period.

Except as expressly stated above, Endor excludes all liability for loss of data, loss of profit, or any loss or damage suffered by you or any third party, whether those damages are direct, indirect, consequential, special, or incidental and however arising under any theory of law, as a result of using this product. Some states or provinces do not allow limitations on how long an implied warranty lasts and some states do not allow the exclusion or limitations of consequential or incidental damages, so these limitations or exclusions may not apply to you. This warranty gives you specific legal rights. You may also have other rights which vary from state to state or province to province. The warranty offered by Endor on this product is the same whether or not you register your product.

This warranty does not apply to any system software / firmware that is pre-installed in the purchased product, or is subsequently provided via update or upgrade releases. In case of issues apparently related to system software / firmware as well as any other product related issues, Endor recommends checking the FAQ database at [fanatec.com/support/faq](http://fanatec.com/support/faq) to see if your problem can be solved there.



Manufactured and distributed by



Fanatec® is a registered trademark of Endor AG  
Designed and developed by Endor AG in Germany

E.ON-Allee 3 - 84036 Landshut - Germany  
Telephone: +49 (871) 9221-122 Fax: +49 (871) 9221-221  
Email: [info.webshop@fanatec.com](mailto:info.webshop@fanatec.com)  
Website: [www.fanatec.com](http://www.fanatec.com) - [www.endor.ag](http://www.endor.ag)  
Made in China