

## WIRELESS CHARGING CAR HOLDER QUICK CHARGE 15W



### User Manual

#### Packing Detail

Wireless charging holder	x 1
Car air vent pedestal	x 1
Type-C charging cable (optional)	x 1
Suction cup holder	x 1
Car charger (optional)	x 1

#### Product Specification

Input	DC5V/2.0A,DC9V/2.0A,DC12V/1.5A(MAX)
Output	DC5V/1.0A,DC9V/1.67A ,DC12V/1.2A (MAX)
Input port	Type-C
Working temperature	-10°C-55°C
Wireless charging distance	6mm Max
Charging conversion rate	65%-75%
Super Capacitor	Can be opened and closed 2 times within 5 minutes of power failure

\*Output 5W/14.4W/15W wireless car holder, should compare with QC3.0 fast charging car charger.

#### Smart Protection

**Smart IC**  
Built-in smart chip intelligently detects device type and delivers the optimal current for safe and efficient charging

#### Voltage Protection

-When the charger input voltage is lower or exceeds the rated voltage, charging will stop and the red light turns on

#### Output Current Protection

-When the output current exceeds the rated current, charging will stop and red light turns on

#### Output over voltage protection

-When the charger output voltage exceeds the rated voltage, charging will stop and red light turns on

#### Foreign Object Detection

-When wireless charger detects a metal foreign object, the red light turns on and the device will stop charging to avoid overheating

#### Function Parts

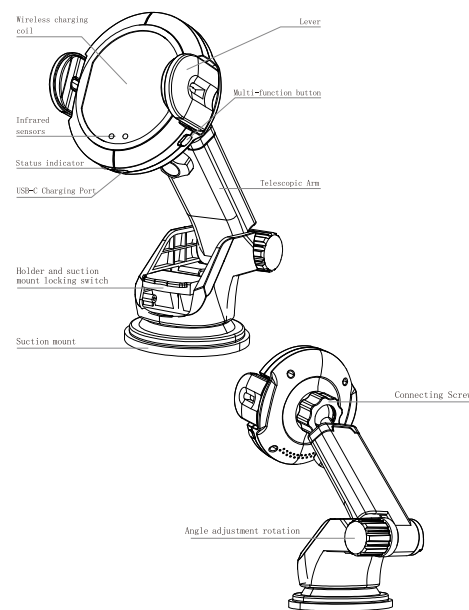

\* Product appearance and parameters may be modified due to functional improvements. Unless otherwise notified, please refer to the actual product.

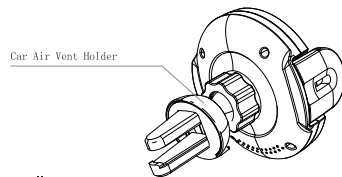

#### Quick Install

##### 1. Assembly of products

Connect the wireless charger to the holder, and you can choose to install the holder with rotary lifting function as required. The suction disc mounting holder, also can choose to install the outlet holder.

##### 2. Fixed products

Fix the assembled product and base holder to the appropriate position. A variety of installation methods can be obtained by adjusting the spherical fitting and two adjusting knobs.

##### 3. Connect power supply

Insert one end of the standard power cord into the input part of the wireless charger. Another end is plugged into a power supply that meets the requirements of this manual.

#### Use Product

##### 1. Full automatic phone clip. (Infrared mode)

① Place the mobile phone: Hold the mobile phone near the infrared sensor; the fixed clip will open automatically, and the mobile phone will be attached to the surface of the charger. The fixed clip will automatically close and tighten the mobile phone.  
② Remove the phone: Grab the phone with your hand and press the function button with your finger. The holder will open automatically and remove the phone (the whole process can be done with one hand).

##### 2. Full automatic phone clip. (FOD mode)

① Placing the mobile phone: The charger holder clip is open when it is powered on. Hold the phone against the surface of the charger. The holder clip will automatically close to fix the phone.  
② Remove the mobile phone: While holding the mobile phone with your hand, press the push-open button with your finger, the holder will automatically open, and you can remove the mobile phone (the whole process can be completed with one hand).

##### 3. Wireless charging.

This product has the wireless charging function, connects the wireless charger to the power supply, and then will support Qi wireless. The mobile phone of the charging protocol is fixed on the wireless charger, and the wireless charging reception area of the mobile phone is right. The charging sensor area of the Qi wireless charger, the mobile phone will start to charge automatically.

##### 4. LED status indicator.

Standby Mode	-	Red light ON
Charging / Charging Completed	-	Blue Light ON
Foreign Object Detected	-	Red and Blue Light ON

#### Compatible Products

IPHONE	SAMSUNG	MI
IPHONE 8 Series	GALAXY S Series	MI 9
IPHONE X Series	GALAXY Note Series	MI 10
IPHONE XS Series	HUAWEI	
IPHONE 11 Series	HUAWEI P Series	
IPHONE 12 Series	HUAWEI Mate Series	

\* Support for almost all devices that are not in the list But it supports Qi wireless charging standard equipment.

#### Safety Cautions

Please read and follow the following instructions when using this product in the car.

- When the mobile phone falls due to user error triggering or strong magnetic or electro static interference, etc. The vehicle should be parked in the safety area of the road to pick up the mobile phone. Please do not pick up the mobile phone while driving.
- Please keep in mind that safe driving is your first duty. Do not operate this product while driving, or do something that will distract you.
- Please do not install this product on the car airbag or airbag after expansion can be reached area. Otherwise, when the airbag inflates, the product may be compressed by the airbag to the occupants person causes harm.
- Please check the firmness of the installation of this product regularly to avoid the loss of control of the vehicle and cause damage to the personnel.

#### Operating environment and maintenance

- Do not use this product near a strong magnetic field.
- Do not use unapproved or incompatible power supplies or chargers as this may cause product failure, fire, explosion or other hazards.
- Please use this product in the temperature range of -10°C~+55°C, and store it in the range of -20°C~+70°C. When the ambient temperature is too high or too low, it can cause product failure, fire or explosion.
- Keep the equipment dry. Rain, moisture and all kinds of moisture can cause circuit damage.
- Stop using the product and disconnect the power to the product before cleaning and maintenance.
- Do not use cleaning products such as detergents or alcohol, but simply wipe with a clean, dry, soft cloth.
- Do not throw, knock, or forcefully pull the product components to avoid product failure.
- Do not disassemble or modify the product without permission, otherwise the product and accessories will not be covered by our warranty.
- In case of product failure, please contact the service center.

#### FCC Warning Statement

Changes or modifications not expressly approved by the party responsible for compliance could void the user's authority to operate the equipment. This equipment has been tested and found to comply with the limits for a Class B digital device, pursuant to Part 15 of the FCC Rules. These limits are designed to provide reasonable protection against harmful interference in a residential installation. This equipment generates uses and can radiate radio frequency energy and, if not installed and used in accordance with the instructions, may cause harmful interference to radio communications. However, there is no guarantee that interference will not occur in a particular installation. If this equipment does cause harmful interference to radio or television reception, which can be determined by turning the equipment off and on, the user is encouraged to try to correct the interference by one or more of the following measures:

- Reorient or relocate the receiving antenna.
- Increase the separation between the equipment and receiver.
- Connect the equipment into an outlet on a circuit different from that to which the receiver is connected.
- Consult the dealer or an experienced radio/TV technician for help.

W5说明书

2折页，风琴折，双面印刷，成型尺寸：105x65 mm，80g双铜