

EASY ASSEMBLY AND OPERATION INSTRUCTIONS

22SV23175 Animated Reindeer



READ AND SAVE THESE INSTRUCTIONS FOR FUTURE REFERENCE

IF ANY PART IS MISSING OR BROKEN, DO NOT ATTEMPT TO ASSEMBLE THE PRODUCT AND CONTACT SVI CUSTOMER SERVICE FROM 8:30 AM TO 5:30 PM PST AT 1-855-428-3921, EMAIL CUSTOMERSERVICE@SVIUS.COM, OR CALL HOME ACCENTS HOLIDAY CUSTOMER SERVICE FROM MON-FRI 8:00 AM TO 7:00 PM AND SAT 9:00 AM TO 6:00 PM EST AT 1-855-HDHOLIDAY (1-855-434-6543).

IMPORTANT TIPS:

- Ensure that the switch on the function control box is on the desired setting.
- Ensure that the floor or surface that the item sits on is flat and level.
- Be sure nothing is blocking the sensor.

- If the item still does not work, contact SVI Customer Service from 8:30 am to 5:30 pm PST at 1-855-428-3921, email customerservice@svius.com, or call Home Accents Holiday Customer Service from Mon-Fri 8:00 am to 7:00 pm and Sat 9:00 am To 6:00 pm EST at 1-855-HDHOLIDAY (1-855-434-6543).

PARTS LIST

- A. Body x 1
 - B. Right Hind Leg x 1
 - C. Left Hind Leg x 1
 - D. Left Leg x 1
 - E. Right Leg x 1
 - F. Head x 1
 - G. Right Antler x 1
 - H. Left Antler x 1
 - I. Polybag with Small Parts
 - J. Adapter * x 1
- * Power Adapter Spec
 Input: 100 - 240VAC 50/60Hz
 Output: 5.9V 2A

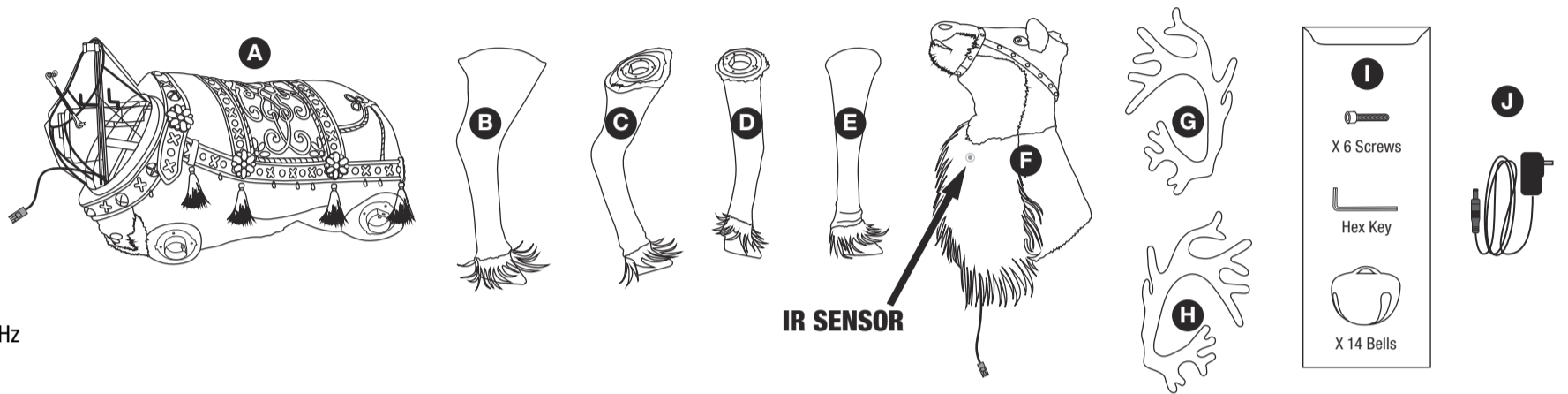

NOTE: Fit the (B, C, D, E) Legs onto the (A) Body before fastening the screws. Do not overtighten the screws.

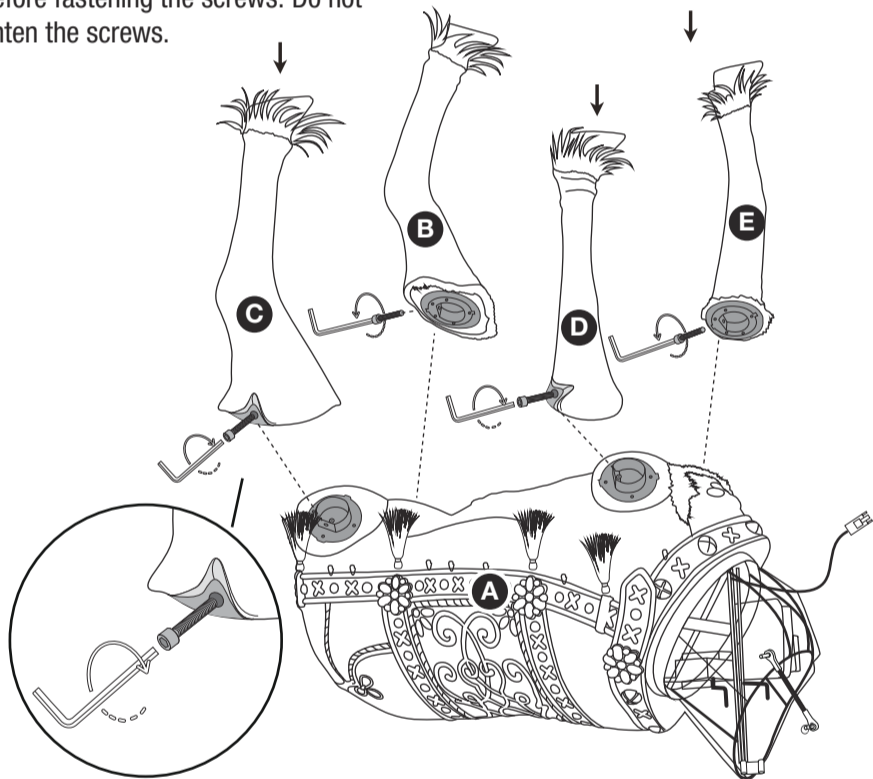

1.1

NOTE: Cotter Pins must be inserted into holes.

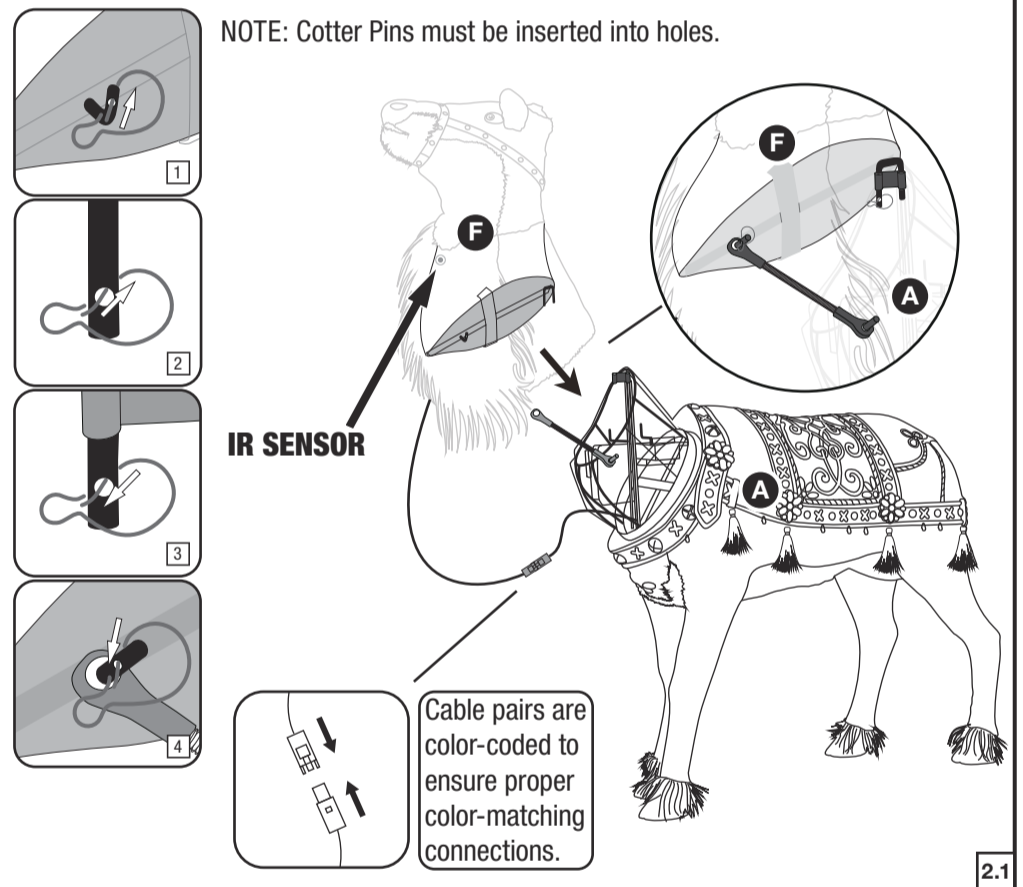

2.1

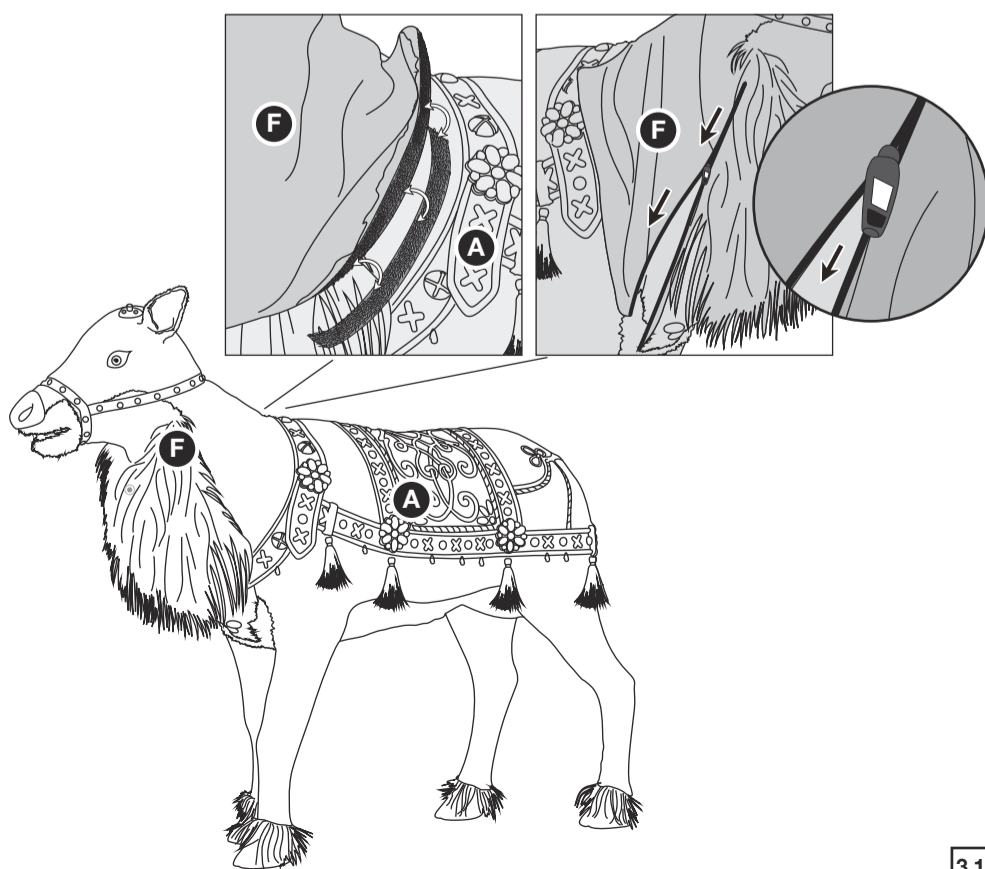

3.1

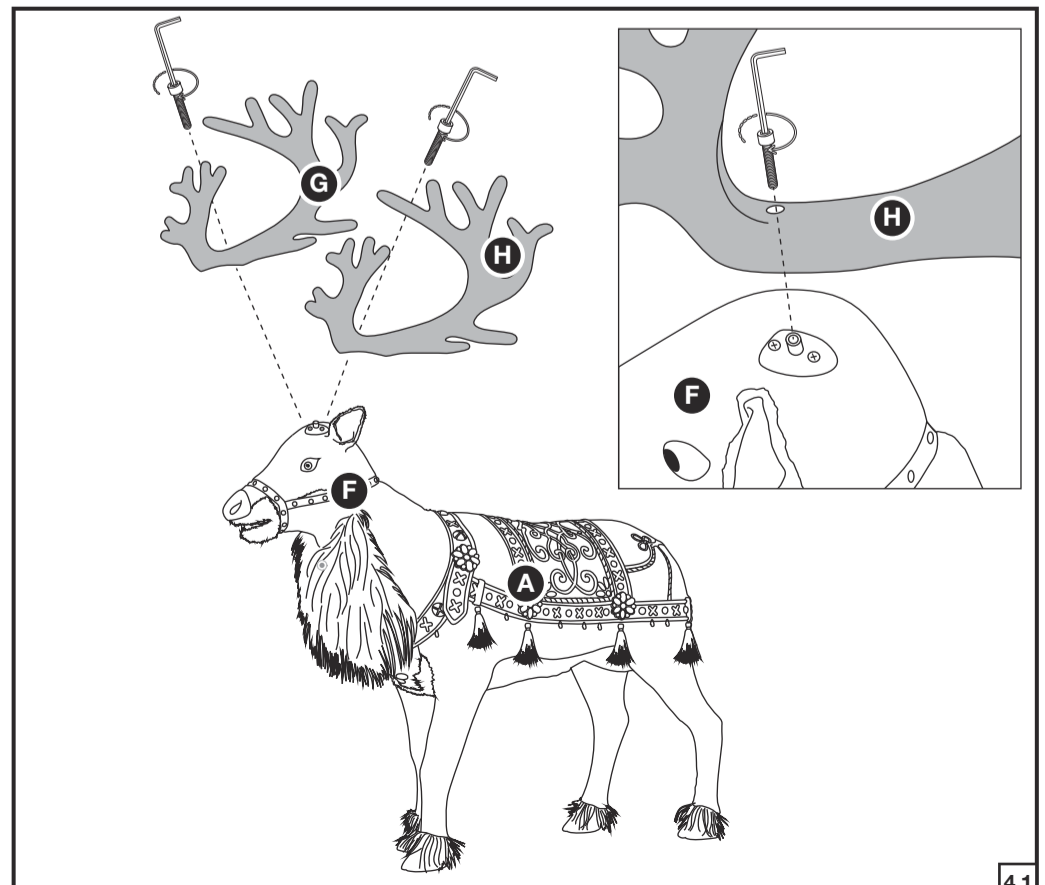

4.1

WARNING: Keep off. Do not climb onto the reindeer.

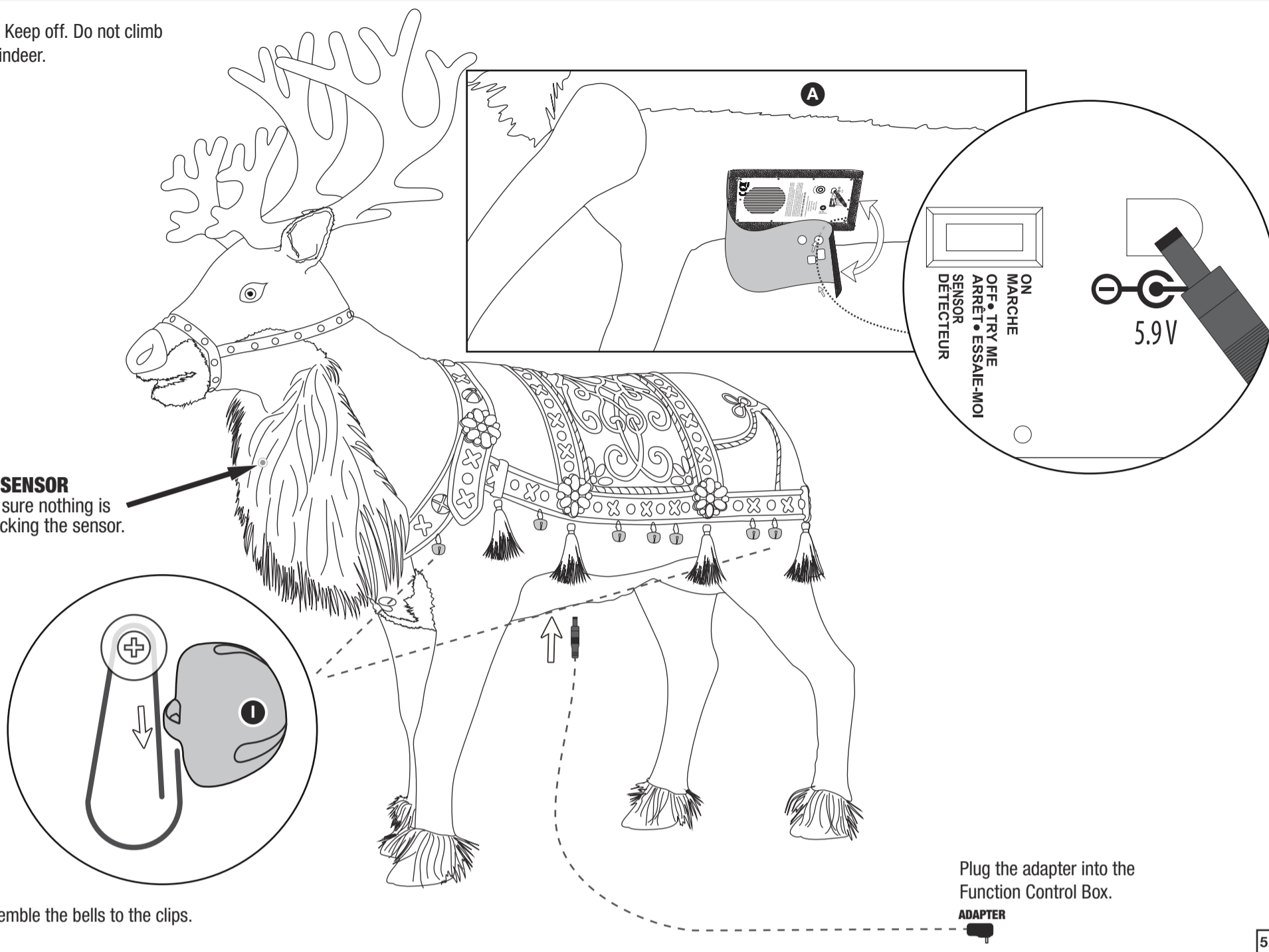

IR SENSOR
Be sure nothing is blocking the sensor.

Plug the adapter into the Function Control Box.



NOTE: Assemble the bells to the clips.

5.1

OPERATION INSTRUCTIONS:

1. Plug the power adapter into a standard power outlet and adjust the settings on the Function Control Box, located on the (A) Body, as desired.

2. Settings:

ON MARCHÉ	This switch mode will continuously operate the sound and animation of the item.
OFF • TRY ME ARRÊT • ESSAIE-MOI	This switch mode allows the item to be activated only if triggered by using a Step Here Try Me Activation Pad (Not Included). The item will operate for one audio cycle with each Try Me activation. Otherwise, the item will stay off.
SENSOR DÉTECTEUR	This switch mode will activate the sound and animation when the Infra-red (IR) sensor is activated and will operate for 1 audio-cycle with each activation. The Infra-red (IR) sensor has a range of up to 2 m/6.5 ft. and will activate when someone comes within an 80-degree angle from left-to-right, as well as from above and below.
	Raise or lower the volume using the volume control turn dial, turn all the way down to turn the volume off.

WARNING

This item is not a toy and should be used for decoration only. This item contains small parts that can be a choking hazard. Keep all plastic and wire parts away from children.

1. Please use the adapter supplied by manufacturer.
 2. Please assemble item according to instructions. Connect all wires according to matching colors.
 3. Children should be supervised by adults. Item should not be grabbed, as it becomes a tipping hazard. Keep flammables away from the adapter, as it heats up during operation.
- Please view all instructions carefully before assembling. Save this instruction sheet for future reference.

CARE AND STORAGE INSTRUCTIONS

For best performance operate your item indoors. When not in use, store this product in its original packing. Keep away from heat and moisture.

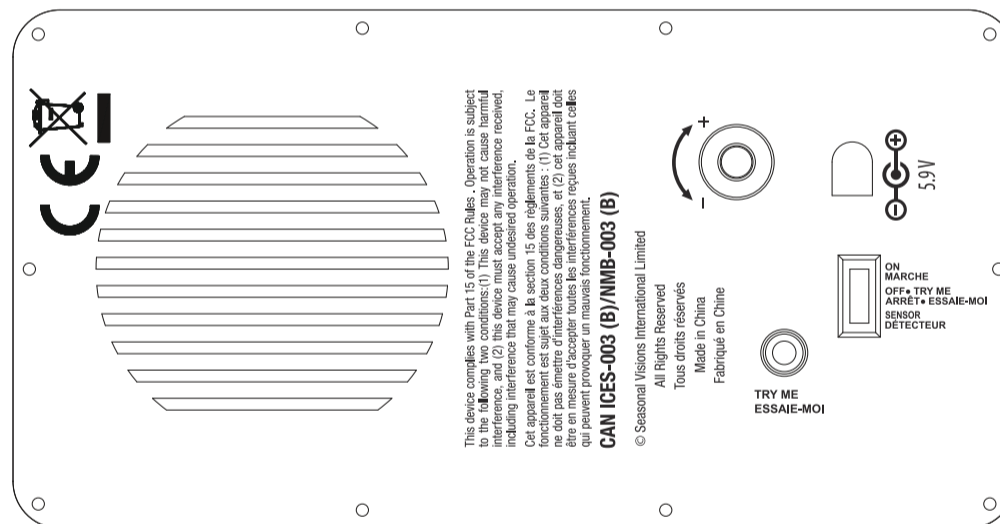

This device complies with Part 15 of the FCC Rules. Operation is subject to the following two conditions: (1) This device may not cause harmful interference, and (2) this device must accept any interference received, including interference that may cause undesired operation.

CAUTION: Changes or modifications not expressly approved by the party responsible for compliance could void the user's authority to operate the equipment.

NOTE: This equipment has been tested and found to comply with the limits for a Class B digital device, pursuant to Part 15 of the FCC Rules. These limits are designed to provide reasonable protection against harmful interference in a residential installation. This equipment generates, uses, and can radiate radio frequency energy and, if not installed and used in accordance with the instructions, may cause harmful interference to radio communications. However, there is no guarantee that interference will not occur in a particular installation. If this equipment does cause harmful interference to radio or television reception, which can be determined by turning the equipment off and on, the user is encouraged to try to correct the interference by one or more of the following measures: Reorient or relocate the receiving antenna, Increase the separation between the equipment and receiver. Connect the equipment into an outlet on a circuit different from that to which the receiver is connected. Consult the dealer or experienced radio/TV technician for help.

CAN ICES-003(B)/NMB-003(B)

© Seasonal Visions International
Emeryville, CA 94608
Tel: 855-428-3921
All Rights Reserved
MADE IN CHINA