

Instruction Manual



IMPORTANT: Please read this instruction carefully before assembly and save these instruction for future use.

Your porch tree should have following: 1 tree top, 1 bottom tree section, 1 base pot.

ASSEMBLY:

- 1) Insert the bottom tree trunk into the pot. Insert the tree top into the bottom tree section. Connect the light string plugs as shown in the diagram, making sure the connectors are inserted in the correct orientation and polarity.
- 2) Shape the branches by working from the bottom of the tree upwards. Gently pull down the branches. Straighten the branches and fan out the tips.
- 3) After shaping the tree, step back and take an overall look. Shift branches to fill any gaps. Slightly upsweep all branch tips for a uniform look.
- 4) Plug electric cord into wall outlet. Your tree is ready to be decorated and enjoyed.

STORAGE:

- 1) Unplug the tree from the wall outlet.
- 2) Store in original carton.
- 3) Do not store in direct sunlight, in a damp area, or in an area where the temperature exceeds 100°F.

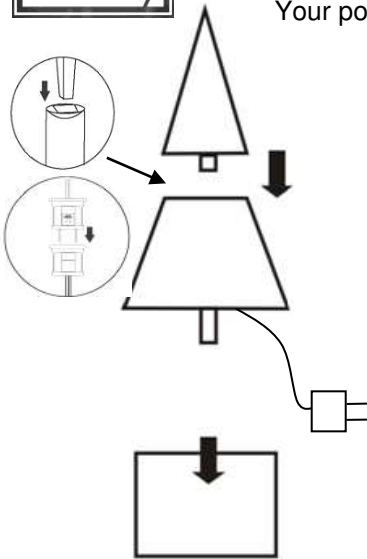

Troubleshooting

If the lights do not work:

- 1) Ensure the power outlet is working correctly. Check whether the light string plugs are connected between the top and bottom tree sections. Check whether the cord is properly plugged into the outlet.
- 2) Check that all bulbs are tightly fitted inside their respective holders.
- 3) If a bulb is not working, replace the faulty bulb as shown in the figures below. Use the replacement bulbs provided.

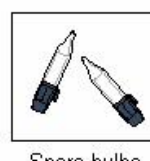

Spare bulbs

- 4) If none of the lights are working, check the fuse in light string. If the fuse is blown, replace the blown fuse following the below diagram. There is a spare fuse included for easy replacement.

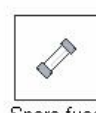
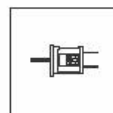
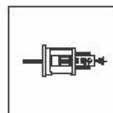
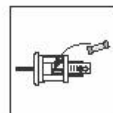
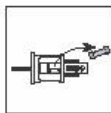
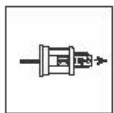

Spare fuse

CAUTION:

- 1) Read all instructions and warning tags carefully.
- 2) For indoor and covered entry.
- 3) Do not place near gas or electric heaters, radiators, fireplaces, candles or other similar sources of heat.
- 4) Place on a hard, flat, level surface. Do not place where the tree is likely to tip or wobble due to uneven flooring or thick carpeting. Do not install near fountains, bathtubs, sinks or other wet areas.
- 5) Do not use candles on the tree.
- 6) After assembling and decorating the tree, ensure that it is stable. If the topiary is unstable, attach support wires to walls and/or window frames (ensure that support wires are also secure).
- 7) Do not overload extension cords or power bars; see ratings on these devices and check the rating labels on the tree for compatibility.
- 8) Do not place in uncovered area where there is prolonged exposure to sunlight or where rain/snow accumulates in the pot or on the tree.
- 9) This is a Christmas decoration. This is not a toy. Keep out of the hands of small children.
- 10) For festive use only, not intended for consecutive use over 90 days each season.
- 11) This appliance is not intended for use by persons (including children) with reduced physical, sensory or mental capabilities, or lack of experience and knowledge, unless they have been given supervision or instruction concerning use of the appliance by a person responsible for their safety.
- 12) Children should be supervised to ensure that they do not play with the appliance.
- 13) The supply cord cannot be replaced. If the cord is damaged the appliance should be scrapped.
- 14) Unplug the product when leaving the house, when retiring for the night, or if left unattended.

Please read assembly instructions. The parts for this product have been carefully inspected and packed. If you have any questions or problems regarding this product, please call The Home Depot hotline **1-855-247-9278** for further assistance, available 7 days a week, 24 hours a day.