



Instruction Manual

Sku # 1007604493
Model: 22GR00046A

IMPORTANT: Please read this instruction carefully before assembly and save these instruction for future use.

ASSEMBLY:

Your lantern should have following: 1 top lantern, 1 metal pole, 1 base pot with decorative branches. (Fig.1)

- 1) Connect the pot, metal pole, and the top lantern as shown on the left. Connect the plugs of the light strings between the two sections, ensuring connectors are connected in the correct polarity.
- 2) To shape the topiary, straighten the branches and fan out the tips.
- 3) After shaping the topiary, step back and take an overall look. Shift branches to fill any gaps. Slightly upsweep all branch tips for a uniform look.
- 4) Plug the adaptor into wall outlet. Your topiary is ready to be decorated and enjoyed.
- 5) The clear plastic windows may shift during transportation, to put the window back in place, open the door of the lantern and slide back the plastic windows back in place.

Fig.1

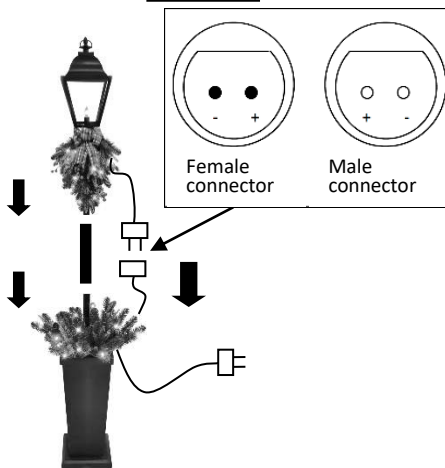

ATTENTION: In windy area, to avoid the lantern from tipping over and getting damaged, please tie the tree to a stable structure. Please also add weight to the pot by putting sand or small gravel through the opening at the top of the pot. Do NOT add water into the pot.

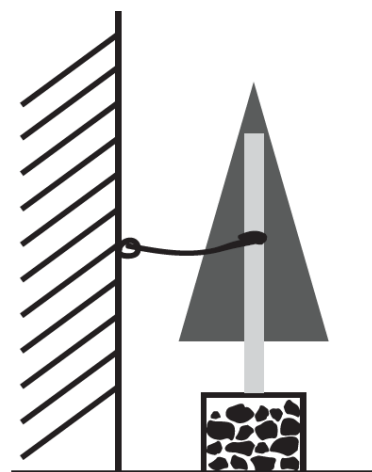

STORAGE:

- 1) Unplug the topiary from the wall outlet.
- 2) Disconnect the plugs between the sections.
- 3) Disconnect the 3 sections of the topiary.
- 4) Store in original carton.
- 5) Do not store in direct sunlight, in a damp area, or in an area where the temperature exceeds 100°F.

Troubleshooting

If the lights do not work:

- 1) Ensure the power outlet is working correctly. Check whether the cord is properly plugged into the outlet.
- 2) Check that all bulbs are tightly fitted inside their respective holders, ensure connectors are connected in the correct polarity.
- 3) If a bulb is not working, replace the faulty bulb as shown in the figures below. Use the replacement bulbs provided.

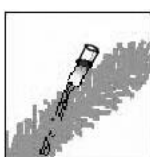
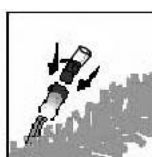

SAVE THESE INSTRUCTIONS

MADE IN CHINA

⚠ CAUTION:

- 1) Read all instructions and warning tags carefully.
- 2) For indoor and covered entry use only.
- 3) Do not place near gas or electric heaters, radiators, fireplaces, candles or other similar sources of heat.
- 4) Place on a hard, flat, level surface. Do not place where the topiary is likely to tip or wobble due to uneven flooring or thick carpeting. Do not install near fountains, bathtubs, sinks or other wet areas.
- 5) Do not use candles on the topiary.
- 6) After assembling and decorating the topiary, ensure that it is stable. If the topiary is unstable, attach support wires to walls and/or window frames (ensure that support wires are also secure).
- 7) Do not overload extension cords or power bars; see ratings on these devices and check the rating labels on the topiary for compatibility.
- 8) Do not place in uncovered area where there is prolonged exposure to sunlight or where rain/snow accumulates in the pot or on the topiary.
- 9) This is a Christmas decoration. This is not a toy. Keep out of the hands of small children.
- 10) For festive use only, not intended for consecutive use over 90 days each season.
- 11) This appliance is not intended for use by persons (including children) with reduced physical, sensory or mental capabilities, or lack of experience and knowledge, unless they have been given supervision or instruction concerning use of the appliance by a person responsible for their safety.
- 12) Children should be supervised to ensure that they do not play with the appliance.
- 13) The supply cord cannot be replaced. If the cord is damaged the appliance should be scrapped.
- 14) Unplug the product when leaving the house, when retiring for the night, or if left unattended.

Warning: Changes or modifications to this unit not expressly approved by the party responsible for compliance could void the user's authority to operate the equipment.

NOTE: This device complies with Part 15 of the FCC Rules. Operation is subject to the following two conditions: (1) this device may not cause harmful interference, and (2) this device must accept any interference received, including interference that may cause undesired operation.

This equipment has been tested and found to comply with the limits for a Class B digital device, pursuant to Part 15 of the FCC Rules. These limits are designed to provide reasonable protection against harmful interference in a residential installation. This equipment generates, uses and can radiate radio frequency energy and, if not installed and used in accordance with the instructions, may cause harmful interference to radio communications.

However, there is no guarantee that interference will not occur in a particular installation. If this equipment does cause harmful interference to radio or television reception, which can be determined by turning the equipment off and on, the user is encouraged to try to correct the interference by one or more of the following measures:

Reorient or relocate the receiving antenna.

Increase the separation between the equipment and receiver.

Connect the equipment into an outlet on a circuit different from that to which the receiver is connected.

Consult the dealer or an experienced radio/TV technician for help.

Please read assembly instructions. The parts for this product have been carefully inspected and packed. If you have any questions or problems regarding this product, please call The Home Depot hotline **1-855-247-9278** for further assistance, available 7 days a week, 24 hours a day.

Distributed by:
The Home Depot USA
2455 Paces Ferry Road, N.W.
Atlanta, GA 30339
For Assistance, Call: 1-855-HDHoliday (1-855-434-6543)

SAVE THESE INSTRUCTIONS

MADE IN CHINA