

Honeywell Omni[®] Smart Reader

13.56 MHz/125 kHz/2.4 GHz Contactless and Keypad Readers

SRD Models: 20, 20K, 40, 40K

Install Guide

PLT-06048, Rev. A.5

Supplied parts

- Omni[®] Smart Reader (1)
- Installation Guide (1)
- Flat head/countersunk 0.138-20 x 1.5" self-tapping screws (2) - for installing the reader directly to a wall (no junction box)
- Flat head/countersunk 0.138-32 x 0.375" machine screws (3) - for Imperial (US) junction box installation (2) and attaching the reader to the mounting plate (1)
- Flat head/countersunk M3.5 x 12mm machine screws (2) - for Metric (EU etc) junction box installation
- Flat head/countersunk 0.138-32 x 0.375" security screw (1) - alternative anti-tamper screw for attaching the reader to the mounting plate
- 5-pin terminal connectors, terminal strip models only (2)

Recommended parts (not supplied)

- Cable, 5-10 conductor (Wiegand or Clock-and-Data), 4 conductor Twisted Pair Over-All Shield and UL approved, Belden 3107A or equivalent (OSDP)
- Certified LPS DC power supply
- Metal or plastic junction box
- Security tool HID 04-0001-03 (for anti-tamper screw)
- Drill with various bits for mounting hardware
- Mounting hardware
- Reader spacer or adapter plates for alternate mounting scenarios. Refer to the *Reader and Credentials How to Order Guide* (PLT-02630) for available options and part numbers) at <https://www.hidglobal.com/documents/how-to-order>
- HID[®] Reader Manager™ Application is used for configuration of the reader and can be downloaded from the App Store or Google Play.



PLT-06048 A.5

© 2021 Honeywell International Inc.

1 Mount the mounting plate



ATTENTION

Observe precautions for handling
ELECTROSTATIC SENSITIVE DEVICES

IMPORTANT: If you are mounting multiple OmniSmart readers to metal stud walls, and the readers are positioned within six feet of each other, refer to the additional installation recommendations in technical bulletin PLT-05722 <https://www.hidglobal.com/PLT-05722>

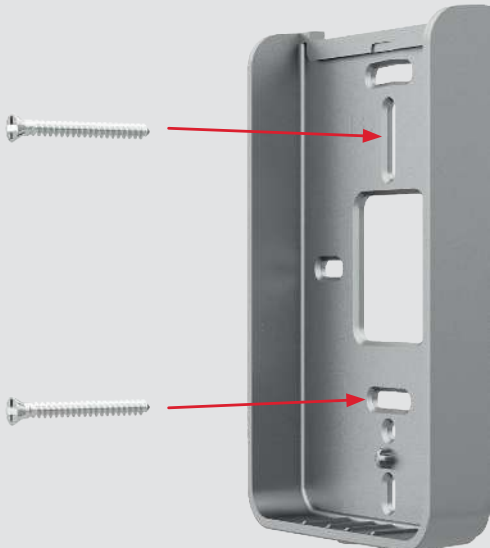

CAUTION: Install the reader on a flat, stable surface. Failure to do so may compromise the IP rating and/or tamper feature. If mounting on or near metal, a spacer is recommended for optimal read performance. Refer to the *Readers and Credentials How to Order Guide* (PLT-02630) for available options and part numbers.

CAUTION: Use the supplied screws to ensure correct fitting and to avoid damaging the reader or mounting plate. HID is not responsible for damage due to use of unapproved mounting hardware.

For Imperial (US):

Use supplied flat head/countersunk 0.138-32 x 0.375" screws.

For Metric (EU etc):

Use supplied flat head/countersunk M3.5 x 12mm screws.

2 Wire the reader

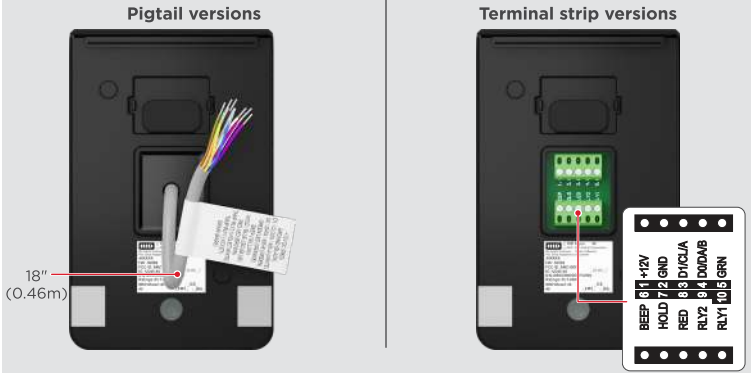

PIGTAIL	TERMINAL	DESCRIPTION
Red	1	+VDC
Black	2	Ground (RTN)
White	3	Wiegand Data 1 / Clock / RS485-A*
Green	4	Wiegand Data 0 / Data / RS485-B*
Orange	5	LED Input (GRN)
Yellow	6	Beeper Input
Blue	7	Hold Input / LED Input (BLUE)*
Brown	8	LED Input (RED)
Violet/White	9	Tamper 2 (RLY2)
Violet	10	Tamper 1 (RLY1)
Bare	—	Drain (pigtail models only)

*Dependent upon reader configuration.

Note: Wiring the reader incorrectly may permanently damage the reader.

Note: Previous OmniCLASS[®] readers had reversed RS-485 wiring (P2-7 & P2-6 - A & B). When upgrading to a OmniSmart reader, ensure proper connections as defined above.

Note: Data 0 and Data 1 wires for Wiegand may be reused for OSDP. However, standard Wiegand cable may not meet RS485 twisted pair recommendations.

Note: For OSDP cable lengths greater than 200 ft (61 m) or EMF interference, install 120Ω +/- 2Ω resistor across RS-485 termination ends.

Note: For keypad configuration, with the keypad reader operating as 26 bit emulation, enter the facility code followed by # within five seconds of power-up. The facility code must be entered as three digits (i.e., for a facility code of 10 enter 0-1-0-#). If unsuccessful, the reader LED displays solid red. Power-cycle the reader and retry entering the facility code.

HID Signo readers use facility codes between 1-255, and no default is set. Once a facility code is entered, the reader LED displays violet, then solid red. Then, power-cycle the reader. If there are two short beeps after entering a PIN, the reader facility code is not configured. In this case, power-cycle the reader and retry entering the facility code.

Note: For readers with Tamper Evident Labels, inspect your reader after first unboxing. If any seals are broken, please contact Honeywell Technical Support.

Tamper evident labels
(location may vary according
to the reader model)



3 Secure the reader to the mounting plate

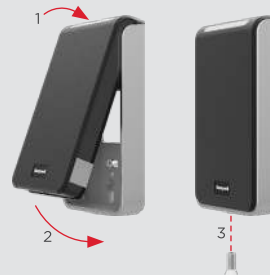

1. Hook the top of the reader on the top of the mounting plate.
2. Align the bottom of the reader with the bottom of the mounting plate.
3. Secure the reader to the mounting plate using the supplied 0.138-32 x 0.375" screw.

Security/anti-tamper screw:
0.138-32 x 0.375" screw (supplied).

Non-security/standard screw:
0.138-32 x 0.375" screws (supplied).

4 Power and test the reader



Power the reader. The reader will beep and the LED will flash.



Test the reader with a credential. The reader will beep and the LED will flash.

