

GUIA DE INÍCIO RÁPIDO QUICK START GUIDE

BAR 1300XMIK2

JBL

SUORTE ON-LINE | ONLINE SUPPORT

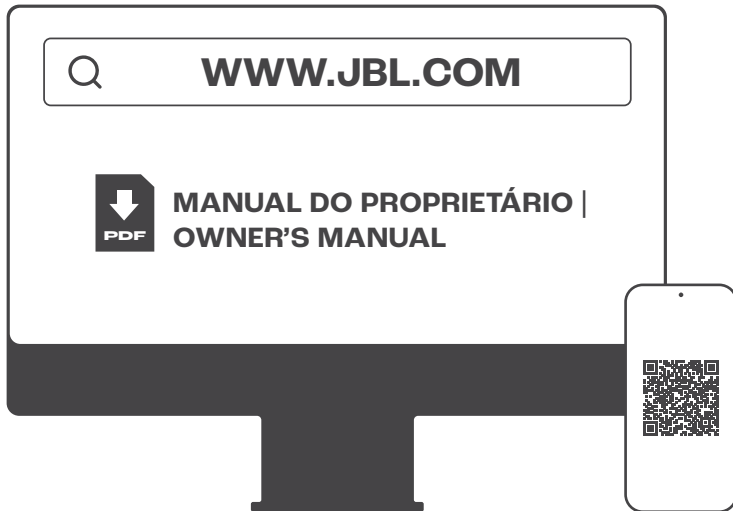

CONTEÚDO DA CAIXA | WHAT'S IN THE BOX

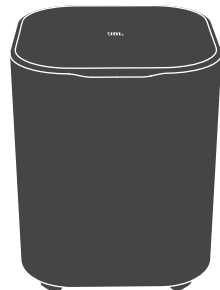

* O cabo de alimentação e o tipo de tomada variam de região para região.

* Power cord quantity and plug type vary by regions.

MONTAGEM NA PAREDE | WALL MOUNTING

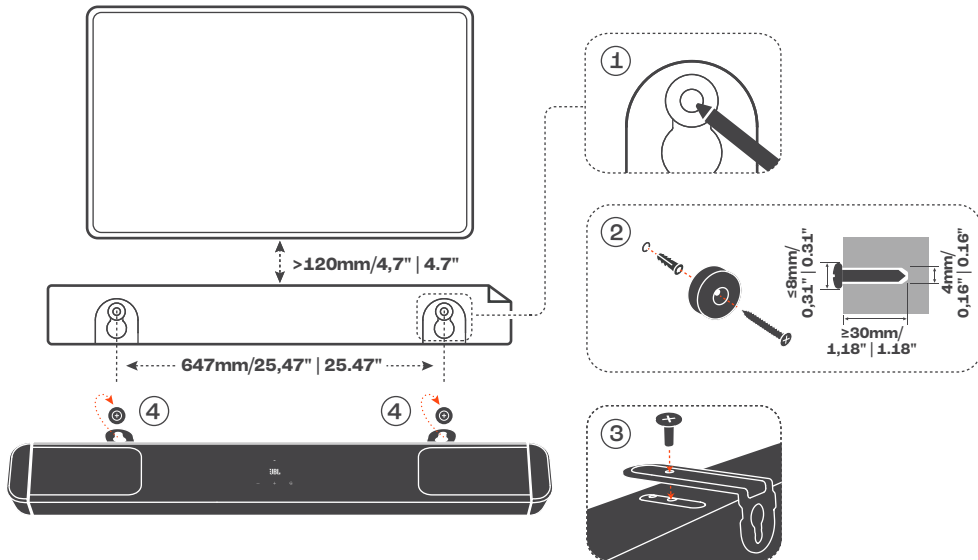

MONTAGEM NA PAREDE | WALL MOUNTING

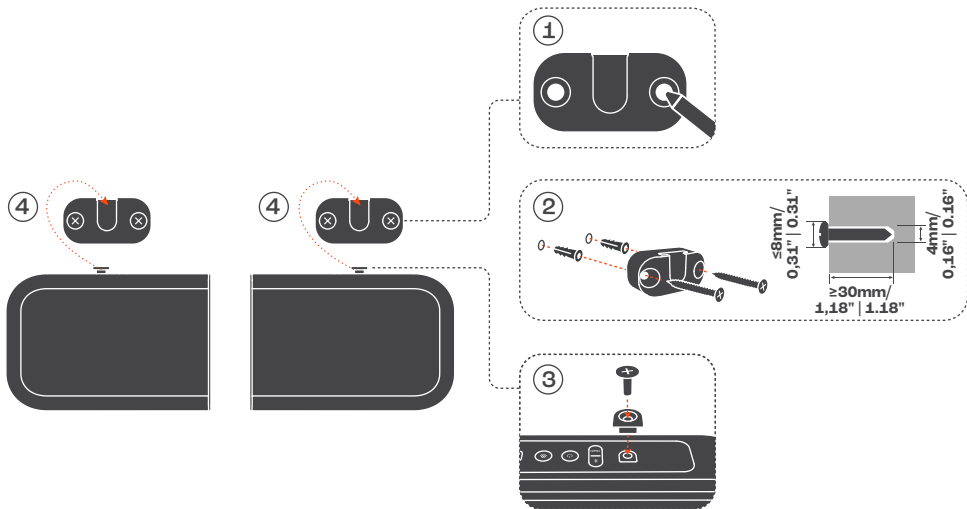

CONECTAR | CONNECT

(PARA eARC TV) (FOR eARC TV)

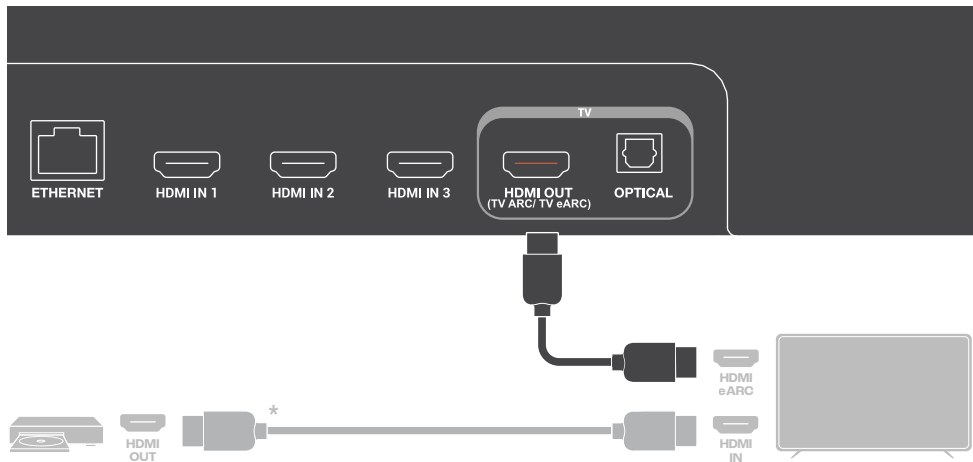

CONECTAR | CONNECT

(PARA ARC TV) (FOR ARC TV)

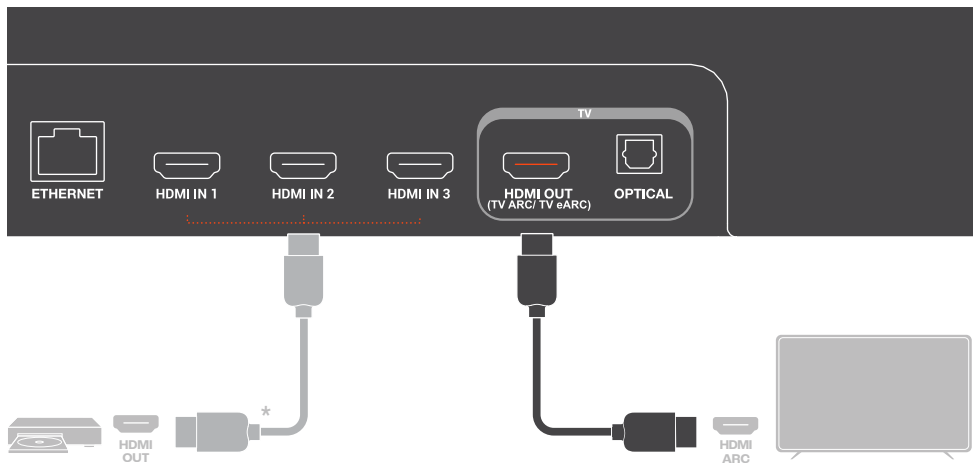

LIGAR E CARREGAR | POWER ON & CHARGE

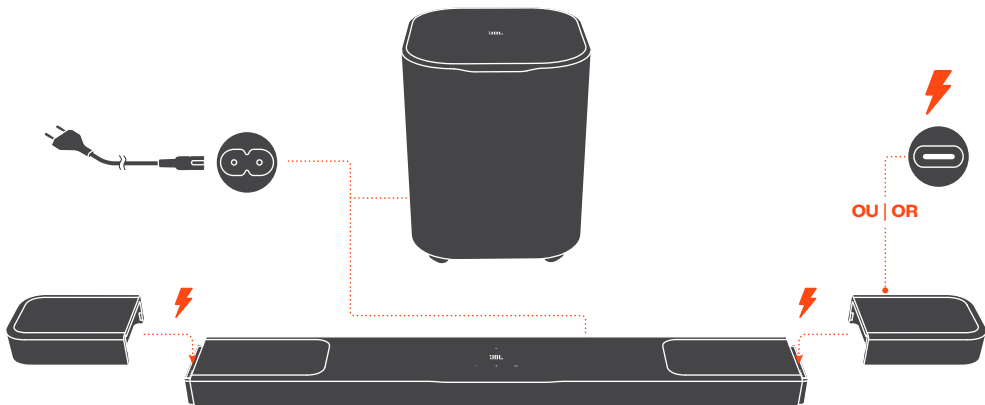

CALIBRAÇÃO DE SOM | SOUND CALIBRATION

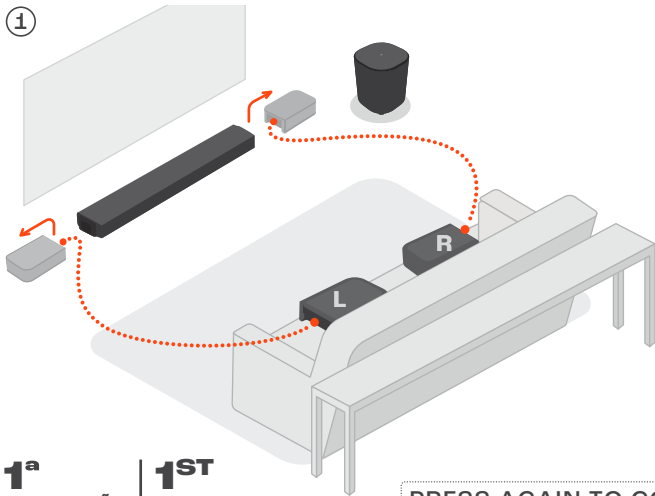

1^a
CALIBRAÇÃO

1ST
CALIBRATION



1-CALIBRATION

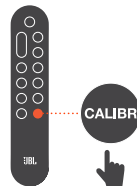

PRESS AGAIN TO CONFIRM



1-DONE

CALIBRAÇÃO DE SOM | SOUND CALIBRATION



④

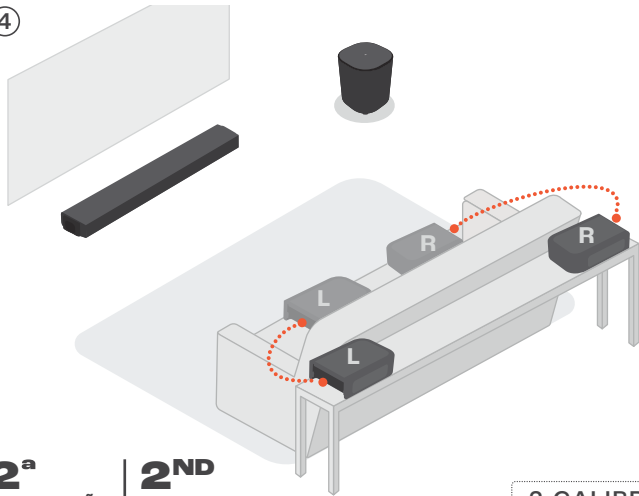

2^a
CALIBRAÇÃO

2ND
CALIBRATION

⑤



PRESS CALIBR AGAIN

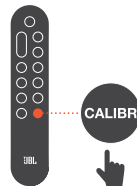

⑥



2-CALIBRATION



2-DONE

EMPARELHAMENTO BLUETOOTH |

(CAIXA DE SOM TRASEIRA)



BLUETOOTH PAIRING

(REAR SPEAKER)

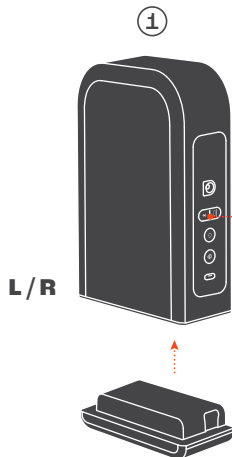

< Settings Bluetooth

Bluetooth



DEVICES

BAR 1300MK2 REAR SPK Connected ⓘ

Now Discoverable



Conectando | Connecting



Conectado | Connected

EMPARELHAMENTO ESTÉREO | (CAIXAS DE SOM TRASEIRAS)

STEREO PAIRING (REAR SPEAKERS)

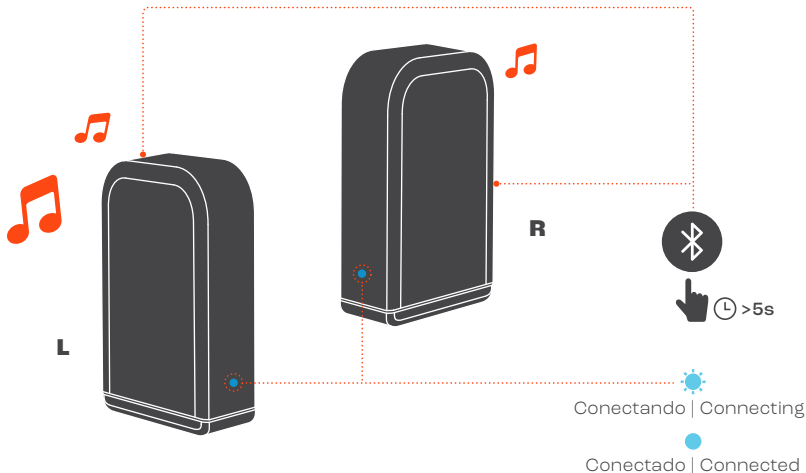

CONEXÕES COM VÁRIAS CAXAS DE SOM (CAIXAS DE SOM TRASEIRAS) | MULTI-SPEAKER CONNECTION (REAR SPEAKERS)

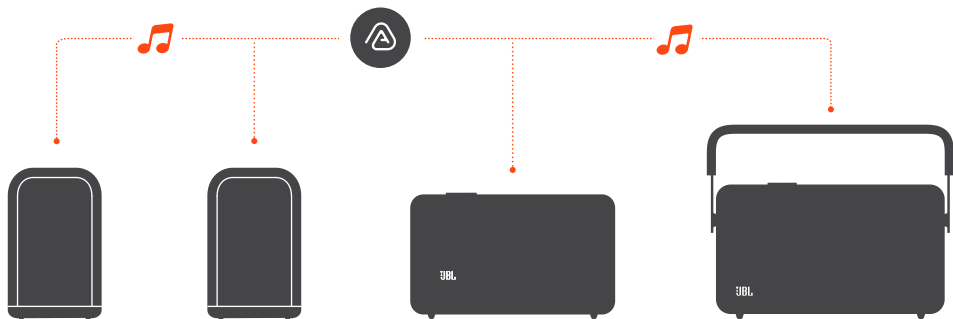

APLICATIVO | APP

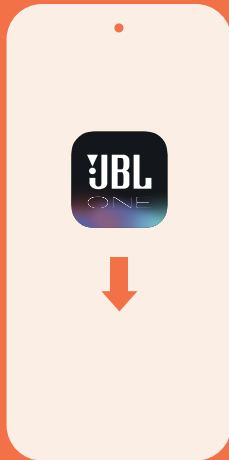

Conecte seu dispositivo Android™ ou iOS à rede Wi-Fi e siga as instruções do aplicativo para concluir a configuração da caixa de som. Connect your Android or iOS device to the Wi-Fi network and follow app instructions to complete speaker setup.



* A disponibilidade dos recursos varia entre os países e nem todos os recursos podem estar disponíveis em seu país.

* The availability of features will vary between countries and not all features may be available in your country.

ESPECIFICAÇÕES TÉCNICAS

Especificações gerais

- Modelo: BAR 1300XMK2 (barra de som)
BAR 1300XMK2 SURROUND (caixa de som removível)
BAR 1300XMK2 SUB (subwoofer)
- Sistema de som: 11.1.4 canais
- Fonte de alimentação: 100 a 240 V CA, ~ 50/60 Hz
- Potência de saída total da caixa de som (RMS a THD 1%): 392,5 W RMS
- Potência de saída da barra de som (RMS a THD 1%): 237,5 W RMS
- Potência de saída da caixa de som surround (RMS a THD 1%): 2x 40 W RMS
- Potência de saída do subwoofer (RMS a THD 1%): 75 W RMS
- Transdutor de barra de som: drivers racetrack 8x (50x75 mm), tweeters de 7x 1 pol. (25 mm), drivers de alcance total de emissão superior 4x 3 pol. (75 mm)
- Transdutor de caixa de som surround: 2 drivers racetrack (50x90mm), 1x driver de alcance total de 2 pol. (50 mm), 1x driver de alcance total de emissão superior de 3 pol. (75 mm)
- Transdutor do subwoofer: 12 pol. (311 mm)
- Consumo de energia em modo de espera da rede: < 2 W
- Temperatura de operação: 0 °C a 45 °C
- Bateria de lítio: 7,2 V, 4722 mAh
- Tempo de reprodução da caixa de som surround removível: até 10 horas (pode variar dependendo do tipo de conteúdo e do nível do volume)

Especificação HDMI

- Entrada de vídeo HDMI: 3
- Saída de vídeo HDMI (com canal de retorno de áudio aprimorado, eARC): 1
- Versão HDMI HDCP: 2.3
- Compatibilidade HDR: HDR10+, Dolby Vision

Especificações de áudio

- Resposta de frequência: 33 Hz - 20 kHz (-6 dB)
- Entradas de áudio: Óptica, Bluetooth, USB (a reprodução USB está disponível na versão dos EUA e APAC. Em outras versões, o USB é apenas para serviço.)

Especificação USB

- Entrada USB: Tipo A
- Classificação do USB: 5 V CC, 0,5 A

- Formatos de arquivo compatível: mp3
- Codec MP3: MPEG 1 Camada 2/3, MPEG 2 Camada 3, MPEG 2.5 Camada 3
- Taxa de amostragem MP3: 16 - 48 kHz
- Taxa de bits de MP3: 80 - 320 kbps

Especificação sem fio

- Versão Bluetooth: Barra principal - v5.3, caixa de som surround removível - v5.4
 - Perfil Bluetooth da barra principal: A2DP v1.3, AVRCP v1.5
 - Perfil Bluetooth da caixa de som surround removível: A2DP v1.4, AVRCP v1.6
 - Alcance de frequência do transmissor Bluetooth: 2.400 MHz - 2.483,5 MHz
 - Potência do transmissor Bluetooth: < 15 dBm (EIRP)
 - Rede Wi-Fi: IEEE 802.11 a/b/g/n/ac/ax (2,4 GHz/5 GHz)
 - Faixa de frequência do transmissor Wi-Fi de 2,4 G: 2.412 - 2.472 MHz (Banda ISM 2,4 GHz; EUA: 11 Canais, Europa e outros: 13 Canais)
 - Potência do transmissor Wi-Fi 2,4G: < 20 dBm (EIRP)
 - Faixa de frequência do transmissor Wi-Fi 5G: 5,15 a 5,35 GHz; 5,470 a 5,725 GHz; 5,725 a 5,825 GHz
 - Potência do transmissor Wi-Fi 5 G: 5,15 - 5,25 GHz < 23 dBm, 5,25 - 5,35 GHz e 5,470 - 5,725 GHz < 20 dBm, 5,725 - 5,825 GHz < 14dBm (EIRP)
 - Faixa de frequência do transmissor sem fio 5G: 5,15 a 5,35 GHz; 5,470 a 5,725 GHz; 5,725 a 5,825 GHz
 - Potência do transmissor sem fio 5G: 5,15 - 5,25 GHz <23dBm (EIRP), 5,25 - 5,35GHz e 5,470 - 5,725GHz <20dBm (EIRP), 5,725 - 5,825GHz <14dBm (EIRP)
- Observação:** Banda de 5,6 - 5,64 GHz será desativada quando enviada para Austrália/Nova Zelândia.

Dimensões

- Dimensões totais da barra de som (L x A x P): 1404 x 58 x 136 mm/55,3 pol. x 2,3 pol. x 5,4 pol.
- Dimensões da barra de som (L x A x P): 1030 x 58 x 136 mm/40,6 pol. x 2,3 pol. x 5,4 pol.
- Dimensões da caixa de som surround removível (cada) (L x A x P): 202 x 58 x 136 mm/8 pol. x 2,3 pol. x 5,4 pol.
- Dimensões do subwoofer (L x A x P): 380 x 482,5 x 380 mm/15 pol. x 19 pol. x 15 pol.
- Peso da barra de som: 5,93 kg/13 lb
- Peso da caixa de som surround removível (cada): 1,3 kg/2,8 lb
- Peso do subwoofer: 15,4 kg/34 lb
- Dimensões da embalagem (L x A x P): 1124 x 463 x 565 mm/44,3 pol. x 18,2 pol. x 22,2 pol.
- Peso da embalagem: 29,3 kg/64,6 lb

TECH SPEC

General Specifications

- Model: BAR 1300XMK2 (soundbar unit)
BAR 1300XMK2 SURROUND (detachable speaker)
BAR 1300XMK2 SUB (subwoofer unit)
- Sound system: 11.1.4 channel
- Power supply: 100 - 240 V AC, ~50/60 Hz
- Total speaker power output (RMS @THD 1%): 785 W
- Soundbar output power (RMS @THD 1%): 475 W
- Surround speaker output power (RMS @THD 1%): 2 x 80 W
- Subwoofer output power (RMS @THD 1%): 150 W
- Soundbar transducer: 8 x (50 x 75 mm) racetrack drivers, 7 x 1" (25 mm) tweeters, 4 x 3" (75 mm) up-firing full-range drivers
- Surround speaker transducer: 2 x (50 x 90 mm) racetrack drivers, 1 x 2" (50 mm) full-range drivers, 1 x 3" (75 mm) up-firing full-range drivers
- Subwoofer transducer: 12" (311mm)
- Networked standby power: < 2 W
- Operating temperature: 0 °C - 45 °C
- Lithium battery: 7.2 V, 4722 mAh
- Detachable surround speaker playtime: up to 10 hours (may vary according to content type and volume level)

HDMI specification

- HDMI video input: 3
- HDMI video output (with Enhanced Audio Return Channel, eARC): 1
- HDMI HDCP version: 2.3
- HDR pass through: HDR10+, Dolby Vision

Audio Specification

- Frequency response: 33 Hz - 20 kHz (-6 dB)
- Audio inputs: Optical, Bluetooth, USB (USB playback is available in US and APAC version. For other versions, USB is for Service only.)

USB specification

- USB port: Type A
- USB rating: 5 V DC, 0.5 A

- Supporting file formats: mp3
- MP3 codec: MPEG 1 Layer 2/3, MPEG 2 Layer 3, MPEG 2.5 Layer 3
- MP3 sampling rate: 16 - 48 kHz
- MP3 bitrate: 80 - 320 kbps

Wireless specification

- Bluetooth version: Main Bar - v5.3, Detachable surround speaker - v5.4
 - Main bar Bluetooth profile: A2DP v1.3, AVRCP v1.5
 - Detachable surround speaker Bluetooth profile: A2DP v1.4, AVRCP v1.6
 - Bluetooth transmitter frequency range: 2400 MHz - 2483.5 MHz
 - Bluetooth transmitter power: < 15 dBm (EIRP)
 - Wi-Fi network: IEEE 802.11 a/b/g/n/ac/ax (2.4 GHz / 5 GHz)
 - 2.4G Wi-Fi transmitter frequency range: 2412 - 2472 MHz (2.4 GHz ISM Band, USA 11 Channels, Europe and others 13 Channels)
 - 2.4G Wi-Fi transmitter power: < 20 dBm (EIRP)
 - 5G Wi-Fi transmitter frequency range: 5.15 - 5.35 GHz, 5.470 - 5.725 GHz, 5.725 - 5.825 GHz
 - 5G Wi-Fi transmitter power: 5.15 - 5.25 GHz < 23 dBm, 5.25 - 5.35 GHz & 5.470 - 5.725 GHz < 20 dBm, 5.725 - 5.825 GHz < 14 dBm (EIRP)
 - 5G wireless transmitter frequency range: 5.15 - 5.35 GHz, 5.470 - 5.725 GHz, 5.725 - 5.825 GHz
 - 5G wireless transmitter power: 5.15 - 5.25 GHz < 23 dBm (EIRP), 5.25 - 5.35 GHz & 5.470 - 5.725 GHz < 20 dBm (EIRP), 5.725 - 5.825 GHz < 14 dBm (EIRP)
- Note:** Band 5.6 - 5.64 GHz will be disabled when shipped to Australia / New Zealand.

Dimensions

- Total soundbar dimensions (W x H x D): 1404 x 58 x 136 mm / 55.3" x 2.3" x 5.4"
- Soundbar dimensions (W x H x D): 1030 x 58 x 136 mm / 40.6" x 2.3" x 5.4"
- Detachable surround speaker dimensions (each) (W x H x D): 202 x 58 x 136 mm / 8" x 2.3" x 5.4"
- Subwoofer dimensions (W x H x D): 380 x 482.5 x 380 mm / 15" x 19" x 15"
- Soundbar weight: 5.93 kg / 13 lbs
- Detachable surround speaker weight (each): 1.3 kg / 2.8 lbs
- Subwoofer weight: 15.4 kg / 34 lbs
- Packaging dimensions (W x H x D): 1124 x 463 x 565 mm / 44.3" x 18.2" x 22.2"
- Packaging weight: 29.3 kg / 64.6 lbs

This product contains open source software licensed under GPL. For your convenience, the source code and relevant build instruction are also available at https://harman-webpages.s3.amazonaws.com/Harman_One_OS_D_package_license_list.htm

Please feel free to contact us at:

Harman Deutschland GmbH

ATT: Open Source, Gregor Krapf-Gunther, Parkring 3

85748 Garching bei Munchen, Germany

or OpenSourceSupport@Harman.com if you have additional question regarding the open source software in the product.



This equipment is a Class II or double insulated electrical appliance.

WARNING: Please refer to the information on exterior bottom enclosure for electrical and safety information before installing or operating the apparatus.



Este produto está homologado pela Anatel, de acordo com os procedimentos regulamentados para avaliação da conformidade de produtos para telecomunicações e atende aos requisitos técnicos aplicados.

Para maiores informações, consulte o site da Anatel – www.anatel.gov.br

Este equipamento não tem direito à proteção contra interferência prejudicial e não pode causar interferência em sistemas devidamente autorizados.

Atenção: conforme lei brasileira nº 11.291, a exposição prolongada a ruídos superiores a 85dB pode causar danos ao sistema auditivo.



The Bluetooth® word mark and logos are registered trademarks owned by Bluetooth SIG, Inc. and any use of such marks by HARMAN International Industries, Incorporated is under license. Other trademarks and trade names are those of their respective owners.



The terms HDMI, HDMI High-Definition Multimedia Interface, HDMI trade dress and the HDMI Logos are trademarks or registered trademarks of HDMI Licensing Administrator, Inc.



The Wi-Fi CERTIFIED™ Logo is a registered trademark of Wi-Fi Alliance®.



Dolby, Dolby Vision, Dolby Atmos, and the double-D symbol are registered trademarks of Dolby Laboratories Licensing Corporation. Manufactured under license from Dolby Laboratories. Confidential unpublished works. Copyright © 2012–2024 Dolby Laboratories. All rights reserved.



FOR DTS PATENTS, SEE [HTTP://XPERI.COM/DTS-PATENTS/](http://XPERI.COM/DTS-PATENTS/). MANUFACTURED UNDER LICENSE FROM DTS, INC. AND ITS AFFILIATES. DTS, DTS:X, AND THE DTS:X LOGO ARE REGISTERED TRADEMARKS OR TRADEMARKS OF DTS, INC. AND ITS AFFILIATES IN THE UNITED STATES AND/OR OTHER COUNTRIES. © DTS, INC. AND ITS AFFILIATES. ALL RIGHTS RESERVED.



Google, Android, Google Home, Google Cast and other marks are trademarks of Google LLC.

Google Assistant is not available in certain languages and countries. Availability and performance of certain features, services, and applications are device and network dependent and may not be available in all areas.



Use of the Works with Apple badge means that an accessory has been designed to work specifically with the technology identified in the badge and has been certified by the developer to meet Apple performance standards.

Apple, and AirPlay are trademarks of Apple Inc., registered in the U.S. and other countries and regions.

To use AirPlay with JBL Bar 1300XMK2, the latest version of iOS, iPadOS, or macOS is recommended.



Use your phone, tablet or computer as a remote control for Spotify. Go to [spotify.com/connect](https://www.spotify.com/connect) to learn how.

The Spotify Software is subject to third party licenses found here: <https://www.spotify.com/connect/third-party-licenses>.

ROON READY

Being Roon Ready means that HARMAN uses Roon streaming technology, for an incredible user interface, simple setup, rock-solid daily reliability, and the highest levels of audio performance, without compromise.

