



WIRELESS MICROPHONE



Quick Start Guide



- EN** Before using this product, read the safety sheet carefully.
- CZ** Před použitím výrobku si pečlivě přečtěte bezpečnostní list.
- DA** Før du bruger dette produkt, skal du læse sikkerhedsarket omhyggeligt.
- DE** Lies vor der Verwendung dieses Produkts das Sicherheitsdatenblatt sorgfältig durch.
- EL** Πριν χρησιμοποιήσετε αυτό το προϊόν, διαβάστε προσεκτικά το φυλλάδιο ασφαλείας.
- ES** Antes de usar este producto, lee la hoja de seguridad atentamente.
- FI** Lue käyttöturvallisuustiedote huolellisesti ennen tuotteen käyttöä.
- FR** Avant d'utiliser ce produit, lisez attentivement la fiche de sécurité.
- HU** A termék használatba vétele előtt kérjük, gondosan olvassa át a biztonsági adatlapot.
- IT** Prima di utilizzare questo prodotto, leggere attentamente la scheda di sicurezza.
- NL** Lees het veiligheidsblad aandachtig voordat u dit apparaat gebruikt.
- NO** Før du bruker dette produktet, må du lese sikkerhetsarket nøye.
- PL** Przed użyciem produktu przeczytaj uważnie arkusz bezpieczeństwa.
- PT-BR** Antes de usar este produto, leia cuidadosamente a ficha de segurança.
- SK** Pred použitím tohto produktu si pozorne prečítajte bezpečnostný údajový list.
- SV** Läs säkerhetsbladet noggrant innan du använder den här produkten
- TR** Bu ürünü kullanmadan önce güvenli formunu dikkatlice okuyun.
- RU** Перед использованием изделия внимательно прочитайте инструкцию по безопасности.
- UK** Перш ніж використовувати цей виріб, уважно прочитайте інструкцію з техніки безпеки.
- ZH-CN** 使用本产品前, 请仔细阅读安全说明书。
- ZH-TW** 使用本產品前, 請仔細閱讀安全說明書。
- ID** Sebelum menggunakan produk ini, bacalah lembar panduan keselamatan dengan cermat.
- JP** この製品を使用する前に、安全シートを必ずお読みください。
- KO** 제품을 사용하기 전에 안전 관련 주의사항을 자세히 읽으십시오.
- MM** ဤကုန်ပစ္စည်းကို အသုံးမပြုမီ ဘေးကင်းလုံခြုံရေးအတွက် ယခုစာလွှာကို ဂရုတစိုက်ဖတ်ရှုပါ။
- قبل استخدام هذا المنتج، اقرأ صحيفة بيانات السلامة بعناية. **AR**
- לפני השימוש במוצר זה, יש לקרוא היטב את גיליון הבטיחות **HE**

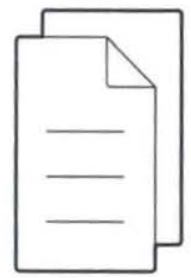
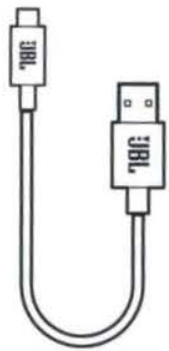
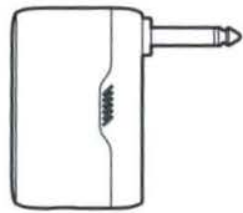
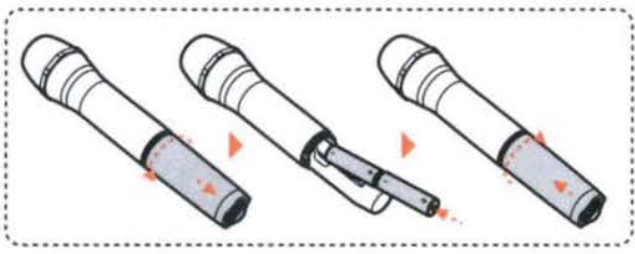
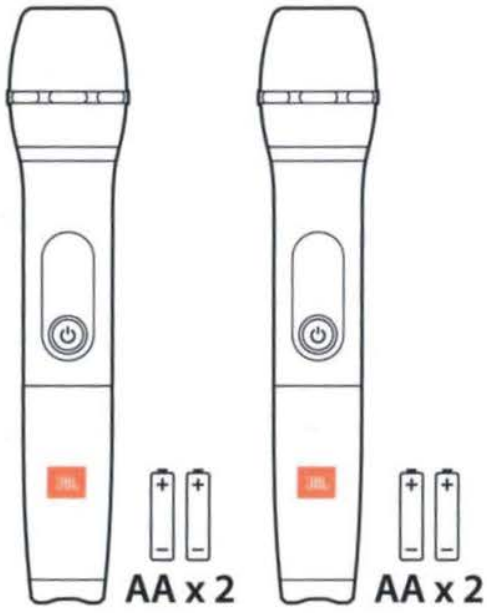

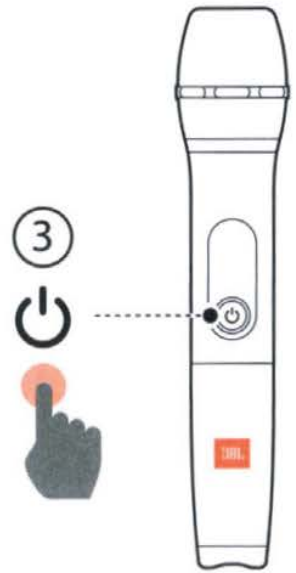
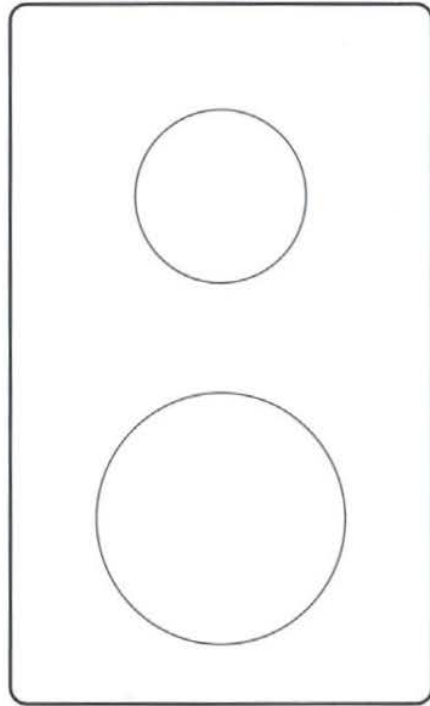
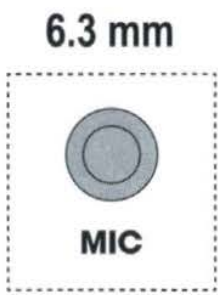

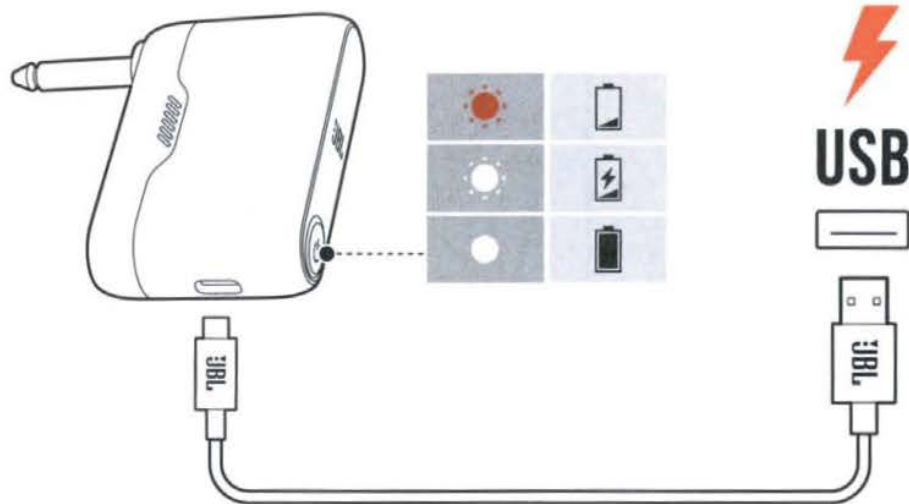

Speaker may have noise interference when sing a song while charging receiver.

To protect battery lifespan, fully charge at least once every 3 months. Battery life will vary due to usage patterns and environmental conditions.

- CZ** Při zpěvu během nabíjení přijímače může docházet k rušení přijímače hlukem.
Chcete-li chránit životnost baterie, nejméně jednou za 3 měsíce ji plně nabijte. Životnost baterie se bude lišit v závislosti na způsobu používání a podmínkách prostředí.
- DA** Højtaleren kan have støjgener, når der synges en sang, mens modtageren oplades.
For at beskytte batteriets levetid skal du oplade fuldt ud mindst en gang hver tredje måned. Batteriets levetid varierer afhængig af brugsmønstre og miljøforhold.
- DE** Der Lautsprecher kann Rauschinterferenzen zeigen, wenn ein Lied gesungen wird, während gleichzeitig der Empfänger aufgeladen wird.
Lade zum Schutz der Batterie diese mindestens einmal alle 3 Monate vollständig auf. Die Batteriebensdauer kann aufgrund von Nutzungsverhalten und Umgebungsbedingungen variieren.
- EL** Το ηχείο ενδέχεται να προκαλεί παρεμβολή θορύβου εάν γίνεται αναπαραγωγή ενός τραγουδιού κατά τη φόρτιση του δέκτη.
Για να προστατεύσετε τη διάρκεια ζωής της μπαταρίας, φορτίστε την πλήρως τουλάχιστον μία φορά κάθε 3 μήνες. Η ζωής της μπαταρίας ποικίλλει ανάλογα με τη χρήση και τις περιβαλλοντικές συνθήκες.
- ES** El altavoz puede sufrir interferencias al cantar mientras se carga el receptor.
Para proteger la duración de la batería, cárgala completamente al menos una vez cada 3 meses. La duración de la batería depende de los patrones de uso y las condiciones ambientales.

EN

General specification

- Model No.: Wireless Microphone Set
- Distance between transmitter and receiver: >10 m
- Polar pattern: Cardioid
- Frequency response: 65 Hz - 15 kHz
- Signal-to-Noise(S/N) ratio: > 60 dBA
- UHF frequency band: 470 - 960 MHz (depends on SKU) (EU 657 - 662 MHz)
- THD: < 0.5%, typical
- Transmitter transmitting power: <10 mW, typical
- Receiver input: 1/4"(6.3 mm) unbalanced
- Receiver maximum Output Level: -13 dBV, typical

- Receiver rechargeable Battery: Lithium-ion Polymer 3.7 WH (Equivalent to 3.7 V, 1000 mAh)
- Receiver charge time: <3.5 hours @5V/1A
- Receiver battery Playtime: Up to 6 hours
- Microphone battery: 4 x AA alkaline (included)

Dimensions and Weight

- Dimensions (W x H x D):
Microphone: $\Phi 50 \times 233 \text{ mm} / 1.95" \times 9.16"$;
Receiver: $70 \text{ mm} \times 80 \text{ mm} \times 20 \text{ mm} / 2.75" \times 3.14" \times 0.78"$
- Weight:
Microphone: 247 g / 0.54 lb;
Receiver: 54g / 0.12 lb

CZ

Obecné parametry

- Č. modelu: Sada bezdrátového mikrofону
- Vzdálenost mezi vysílačem a přijímačem: >10 m
- Směrnost: Kardioidní
- Frekvenční odezva: 65 Hz až 15 kHz
- Poměr signálu k šumu (S/N): > 60 dBA
- Frekvenční pásmo UHF: 470 až 960 MHz (závisí na SKU)
- THD: < 0,5 %, typické
- Vysílací výkon vysílače: <10 mW, typický
- Vstup přijímače: 1/4"(6,3 mm), nesymetrický
- Maximální výstupní úroveň přijímače: -13 dBV, typická

- Nabíjecí baterie přijímače: Lithium-iontová polymerová 3,7 WH (ekvivalent 3,7 V, 1 000 mAh)
- Doba nabíjení přijímače: <3,5 hodiny při 5 V/1 A
- Doba přehrávání přijímače: Až 6 hodin
- Baterie mikrofónu: 4x baterie AA (součástí balení)

Rozměry a hmotnost

- Rozměry (Š x V x H):
Mikrofon: $\Phi 50 \times 233 \text{ mm} / 1,95" \times 9,16"$;
Přijímač: $70 \times 80 \times 20 \text{ mm} / 2,75" \times 3,14" \times 0,78"$
- Hmotnost:
Mikrofon: 247 g / 0,54 lb;
Přijímač: 54 g / 0,12 lb



HE

מפרט כללי

- זמן פעולה של סוללת מקלט: עד 6 שעות
- סוללת מיקרופון: AA x 4 אלקליין (בלול)
- **מידות ומשקל**
- מידות (ר' x ג' x ע'): מיקרופון: 233 x 50 מ"מ / 9.16 x 1.95 אינץ'; מקלט: 20 x 80 x 70 מ"מ / 0.78 x 3.14 x 2.75 אינץ'
- משקל: מיקרופון: 247 גר'; מקלט: 54 גר'
- מס' דגם: סט מיקרופון אלחוטי
- מרחק בין משדר למקלט: יותר מ-10 מ'
- דפוס קוטבי: קרדיואידי
- תגובת תדר: 65 Hz - 15 kHz
- יחס אות לרעש (S/N): < 60 dBA
- תדרי רצועת UHF: 470 - 960MHz (תלוי ב-SKU)
- THD: > 0.5% רגיל
- הספק שידור המשדר: פחות מ-10 מגה-ואט, רגיל
- כניסת מקלט: 1/4 אינץ' (6.3 מ"מ) לא מאחזנת רמת פלט מרבית של המקלט: -13 dBV, רגיל
- סוללת מקלט נטענת: ליתיום-יום פולימר 3.7 ואט-שעה (מקביל ל-3.7 וולט, 1000 מילי-אמפר שעה)
- זמן טעינת מקלט: 3.5 שעות ב-5 וולט/1 אמפר

Remark:

This device operates on a no-interference, no-protection basis. Should the user seek to obtain protection from other radio services operating in the same TV bands, a radio licence is required. For further details, consult Innovation, Science and Economic Development Canada's Client Procedures Circular CPC-2-1-28, Voluntary Licensing of Licence-Exempt Wireless Microphones in the TV Bands.

Ce dispositif fonctionne selon un régime de non brouillage et de non protection. Si l'utilisateur devait chercher à obtenir une certaine protection contre d'autres services radio fonctionnant dans les mêmes bandes de télévision, une licence radio serait requise. Pour en savoir plus, veuillez consulter la Circulaire des procédures concernant les clients CPC 2 1 28, Délivrance de licences sur une base volontaire pour les appareils radio de faible puissance exempts de licence et exploités dans les bandes de télévision d'Innovation, Sciences et Développement économique Canada.

Types of antennas:

Spring antenna, maximum PK gain: -4.15 dBi

America:

6A: 657.027 MHz - 659.027 MHz 6B: 659.427 MHz - 661.427 MHz

Europe:

6A: 657.027 MHz - 659.027 MHz 6B: 659.427 MHz - 661.427 MHz

Беспроводная система микрофонов

Изготовитель: Харман Интернешнл Индастриз Инкорпорейтед, США, 06901
Коннектикут, г.Стэмфорд, Атлантик Стрит 400, офис 1500

Сделано в Китае

Импортер: ООО "ХАРМАН РУС СиАйЭс", Россия, 127018, г.Москва, ул. Двинцев,
д.12, к. 1

Гарантийный период: 1 год

Срок службы: 2 лет

Информация о сервисных центрах: www.harman.com/ru

Техническая поддержка: 8 (800) 700 0467

Организация, уполномоченная на принятие претензий потребителей: ООО
"ХАРМАН РУС СиАйЭс"

Товар сертифицирован

Дата изготовления устройства определяется по двум буквенным обозначениям из второй группы символов серийного номера изделия, следующих после разделительного знака «-». Кодировка соответствует порядку букв латинского алфавита, начиная с января 2010 года: 000000-МУ0000000, где «М» - месяц производства (А - январь, В - февраль, С - март и т.д.) и «У» - год производства (А - 2010, В - 2011, С - 2012 и т.д.).



Este produto está homologado pela Anatel, de acordo com os procedimentos regulamentados para avaliação da conformidade de produtos para telecomunicações e atende aos requisitos técnicos aplicados.

Para maiores informações, consulte o site da Anatel – www.anatel.gov.br

Este equipamento não tem direito à proteção contra interferência prejudicial e não pode causar interferência em sistemas devidamente autorizados.



PA_JBL_Wireless Microphone_QSG_SOP_V8



Safety Instruction and Warranty Card

PRODUCT REGISTRATION

register.jbl.com

SIGN UP & STAY TUNED

Register your product • Registriere dein produkt • Registro del producto •
Enregistrez votre produit • Registro de Produto • 製品登録 •
Registrer dit produkt • Rekisteröl tuotteesi • Rejestracja produktu •
Registrera din produkt • Registreer je product

*Product registration may not be available for all countries



SCAN ME



ENGLISH

Download the full warranty Card and safety information and other helpful information from our website: www.jbl.com/warrantyandsafetybooks

ČEŠTINA

Úplný záruční list, bezpečnostní pokyny a další užitečné informace lze stáhnout z našeho webu: www.jbl.com/warrantyandsafetybooks

DANSK

Hent det komplette garantiark og sikkerhedsoplysninger og andre nyttige oplysninger fra vores hjemmeside: www.jbl.com/warrantyandsafetybooks

DEUTSCH

Lade die vollständige Garantiekarte und Sicherheitsinformationen sowie weitere hilfreiche Informationen von unserer Website herunter: www.jbl.com/warrantyandsafetybooks

EESTI

Laadige alla täielik garantiikaart, ohutusteave ja muu kasulik teave meie veebisaidilt: www.jbl.com/warrantyandsafetybooks

ΕΛΛΗΝΙΚΑ

Κατεβάστε την πλήρη κάρτα εγγύησης και πληροφορίες ασφάλειας και άλλες χρήσιμες πληροφορίες από τον ιστότοπό μας: www.jbl.com/warrantyandsafetybooks

ESPAÑOL

Descarga la tarjeta de garantía completa, la información de seguridad y otra información útil de nuestro sitio web: www.jbl.com/warrantyandsafetybooks

SUOMI

Lataa täydellinen takuukortti ja turvallisuustiedot, sekä muut hyödylliset tiedot verkkosivuiltamme: www.jbl.com/warrantyandsafetybooks

FRANÇAIS

Téléchargez la carte de garantie et les informations de sécurité complètes ainsi que d'autres informations utiles sur notre site Web : www.jbl.com/warrantyandsafetybooks

HRVATSKI

Preuzmite punu jamstvenu karticu, sigurnosne informacije i ostale korisne informacije s našeg web mjesta: www.jbl.com/warrantyandsafetybooks

MAGYAR

Töltse le a teljes garanciakártyát, a biztonsági információkat és egyéb hasznos információkat a weboldalunkról: www.jbl.com/warrantyandsafetybooks

ITALIANO

Scarica la scheda di garanzia completa, le informazioni sulla sicurezza e altre informazioni utili dal nostro sito Web: www.jbl.com/warrantyandsafetybooks

LIETUVIŲ KALBA

Atsisiųskite visą garantijos kortelę ir saugos informaciją bei kitą naudingą informaciją iš mūsų svetainės: www.jbl.com/warrantyandsafetybooks

LATVISKI

Lejupielādējiet pilnu garantijas karti, informāciju par drošību un citu noderīgu informāciju mūsu vietnē: www.jbl.com/warrantyandsafetybooks

NEDERLANDS

Download de volledige garantiekaart en veiligheidsinformatie en andere nuttige informatie van onze website: www.jbl.com/warrantyandsafetybooks

NORSK

Last ned det komplette garantikortet, sikkerhetsinformasjon og annen nyttig informasjon fra nettstedet vårt: www.jbl.com/warrantyandsafetybooks

POLSKI

Prosimy pobrać kartę gwarancyjną, informacje o bezpieczeństwie oraz inne przydatne informacje z naszej strony internetowej: www.jbl.com/warrantyandsafetybooks

PORTUGUÊS

Descarregue por completo o Cartão de garantia e informações de segurança e outras informações úteis no nosso site: www.jbl.com/warrantyandsafetybooks

PORTUGUÊS (BRASIL)

O Cartão de Garantia, informações de segurança e outras informações úteis estão disponíveis no site www.jbl.com/warrantyandsafetybooks

ROMÂNĂ

Descărcați fișa completă de garanție, informații de siguranță și alte informații de ajutor de pe site-ul web: www.jbl.com/warrantyandsafetybooks

SLOVENŠČINA

Preosite celoten garancijski list in varnostne informacije ter druge koristne napotke z naše spletne strani: www.jbl.com/warrantyandsafetybooks

SVENSKA

Ladda ner hela garantikortet och säkerhetsinformation och annan användbar information från vår webbplats: www.jbl.com/warrantyandsafetybooks

TÜRKÇE

Komple garanti kartını ve güvenliik bilgilerini ve yardımcı bilgileri websitemizden indirin: www.jbl.com/warrantyandsafetybooks

БЪЛГАРСКИ

Изтеглете пълната гаранционна карта и информация за безопасност и друга полезна информация от нашия уебсайт: www.jbl.com/warrantyandsafetybooks

РУССКИЙ

Загрузите полностью гарантийный талон, информацию по технике безопасности и другую полезную информацию с нашего веб-сайта: www.jbl.com/warrantyandsafetybooks

简体中文

请登录我公司网站下载完整的保修卡和安全信息及其他有用信息: www.jbl.com/warrantyandsafetybooks

繁體中文

從我們的網站下載完整的保固卡和安全資訊及其他有用資訊: www.jbl.com/warrantyandsafetybooks

日本語

下記のウェブサイトから保証書、安全情報、その他の役立つ情報をダウンロードしてください: www.jbl.com/warrantyandsafetybooks

한국어

전체 품질보증서와 안전 정보를 비롯해 기타 유용한 정보를 다음 당사 웹 사이트에서 다운로드하십시오. www.jbl.com/warrantyandsafetybooks

العربية

قم بتنزيل بطاقة الضمان الكاملة ومعلومات السلامة وغيرها من المعلومات المفيدة من على موقعنا على الإنترنت: www.jbl.com/warrantyandsafetybooks

עברית

ניתן להוריד את הנוסח המלא של תעודת האחריות ומידע בנושא בטיחות, כמו גם מידע שימושי נוסף, מאתר האינטרנט שלנו: www.jbl.com/warrantyandsafetybooks



ENGLISH

IMPORTANT SAFETY INSTRUCTIONS

For all products:

1. Read these instructions.
2. Keep these instructions.
3. Heed all warnings.
4. Follow all instructions.
5. Clean only with a dry cloth.
6. Do not block any ventilation openings. Install this apparatus in accordance with the manufacturer's instructions.
7. Do not install this apparatus near any heat sources such as radiators, heat registers, stoves or other apparatus (including amplifiers) that produce heat.
8. Do not defeat the safety purpose of the polarized or grounding-type plug. A polarized plug has two blades with one wider than the other. A grounding-type plug has two blades and a third grounding prong. The wide blade or the third prong is provided for your safety. If the provided plug does not fit into your outlet, consult an electrician for replacement of the obsolete outlet.
9. Protect the power cord from being walked on or pinched, particularly at plugs, convenience receptacles and the point where they exit from the apparatus.
10. Use only attachments/accessories specified by the manufacturer.
11. Use only with the cart, stand, tripod, bracket or table specified by the manufacturer or sold with the apparatus. When a cart is used, use caution when moving the cart/apparatus combination to avoid injury from tip-over.
12. Unplug this apparatus during lightning storms or when unused for long periods of time.
13. Refer all servicing to qualified service personnel. Servicing is required when the apparatus has been damaged in any way, such as when the power-supply cord or plug is damaged, liquid has been spilled or objects have fallen into the apparatus, or the apparatus has been exposed to rain or moisture, does not operate normally or has been dropped.
14. To disconnect this apparatus from the AC mains completely, disconnect the power-supply cord plug from the AC receptacle.
15. The mains plug of the power-supply cord shall remain readily operable.
16. This apparatus is intended to be used only with the power supply and/or charging cable provided by the manufacturer.



The following instructions may not apply to waterproof devices. Refer to your device user manual or quick start guide for more waterproof instruction if any.

- Do not use this apparatus near water.
- Do not expose this apparatus to dripping or splashing, and ensure that no objects filled with liquids, such as vases, are placed on the apparatus.

WARNING: TO REDUCE THE RISK OF FIRE OR ELECTRIC SHOCK, DO NOT EXPOSE THIS APPARATUS TO RAIN OR MOISTURE.

CAUTION	
RISK OF ELECTRIC SHOCK. DO NOT OPEN.	
	THIS SYMBOL ON THE PRODUCT MEANS THERE IS UNINSULATED, DANGEROUS VOLTAGE WITHIN THE PRODUCT ENCLOSURE THAT MAY PRESENT A RISK OF ELECTRICAL SHOCK.
	THIS SYMBOL ON THE PRODUCT MEANS THERE ARE IMPORTANT OPERATING AND MAINTENANCE INSTRUCTIONS IN THIS GUIDE.

CAUTION FCC AND IC STATEMENT FOR USERS (USA AND CANADA ONLY)

This device complies with part 15 of the FCC Rules. Operation is subject to the following two conditions: (1) This device may not cause harmful interference, and (2) this device must accept any interference received, including interference that may cause undesired operation.

CAN ICES-3(B)/NMB-3(B)

FCC SDOC SUPPLIER'S DECLARATION OF CONFORMITY

HARMAN International hereby declares that this equipment is in compliance with the FCC Part 15 Subpart B.

The declaration of conformity may be consulted in the support section of our Web site, accessible from www.jbl.com

Federal Communication Commission Interference Statement

This equipment has been tested and found to comply with the limits for a Class B digital device, pursuant to Part 15 of the FCC Rules. These limits are designed to provide reasonable protection against harmful interference in a residential installation. This equipment generates, uses and can radiate radio frequency energy and, if not installed and used in accordance with the instructions, may cause harmful interference to radio communications. However, there is no guarantee that interference will not occur in a particular installation. If this equipment does cause harmful interference to radio or

television reception, which can be determined by turning the equipment off and on, the user is encouraged to try to correct the interference by one or more of the following measures:

- Reorient or relocate the receiving antenna.
- Increase the separation between the equipment and receiver.
- Connect the equipment into an outlet on a circuit different from that to which the receiver is connected.
- Consult the dealer or an experienced radio/TV technician for help.

Caution: Changes or modifications not expressly approved by HARMAN could void the user's authority to operate the equipment.

For Products That Transmit RF Energy:

(i) FCC AND IC INFORMATION FOR USERS

This device complies with Part 15 of the FCC rules and Industry Canada license-exempt RSS standard(s). Operation is subject to the following two conditions: (1) This device may not cause harmful interference; and (2) this device must accept any interference received, including interference that may cause undesired operation.

(ii) FCC/IC Radiation Exposure Statement

This equipment complies with FCC and ICSED radiation exposure limits set forth for an uncontrolled environment.

In case this equipment has to subject to FCC/IC SAR (Specific Absorption Rate) exposure test, this equipment is designed to meet the requirements for exposure to radio waves established by the FCC and ICSED. These requirements set a SAR limit of 1.6 W/kg averaged over one gram of tissue. The highest SAR value reported under this standard during product certification for use when properly worn on the body or on the head, with no separation. To meet RF exposure guidelines and reduce exposure to RF energy during the operation, this equipment should be positioned at least this distance away from the body or the head.

For radio equipment operates in 5150-5850MHz

FCC and IC Caution:

High power radars are allocated as primary users of the 5.25 to 5.35 GHz and 5.65 to 5.85 GHz bands. These radar stations can cause interference with and/or damage to LE LAN (Licence-Exempt Local Area Network) devices. No configuration controls are provided for this wireless equipment allowing any change in the frequency of operations outside the FCC grant of authorization for US operation according to Part 15.407 of the FCC rules.

IC Caution:

User should also be advised that:

- (i) The device for operation in the band 5150 - 5250 MHz is only for indoor use to reduce the potential for harmful interference to co-channel mobile satellite systems; (ii) the maximum antenna gain permitted for devices in the bands 5250 - 5350 MHz and 5470 - 5725 MHz shall comply with the e.i.r.p. limit; and
- (ii) The maximum antenna gain permitted for devices in the band 5725 - 5825 MHz shall comply with the e.i.r.p. limits specified for point-to-point and non point-to-point operation as appropriate.

Use Restriction Attention in European Union, operation is limited to indoor use within the band 5150-5350 MHz.

Correct disposal of this product (Waste Electrical & Electronic Equipment)

This symbol means the product must not be discarded as household waste, and should be delivered to an appropriate collection facility for recycling. Proper disposal and recycling helps protect natural resources, human health and the environment. For more information on disposal and recycling of this product, contact your local municipality, disposal service, or the shop where you bought this product.



This product is RoHS compliant.

This product is in compliance with Directive 2011/65/EU, and its amendments, on the restriction of the use of certain hazardous substances in electrical and electronic equipment.

REACH

REACH (Regulation No 1907/2006) addresses the production and use of chemical substances and their potential impacts on human health and the environment. Article 33(1) of REACH Regulation requires suppliers to inform the recipients if an article contains more than 0.1% (per weight per article) of any substance(s) on the Substances of Very High Concern (SVHC) Candidate List ("REACH candidate list"). This product contains the substance "lead" (CAS-No. 7439-92-1) in a concentration of more than 0.1% per weight.

At the time of release of this product, except for the lead substance, no other substances of REACH candidate list are contained in a concentration of more than 0.1% per weight in this product.

Note: On June 27, 2018, lead was added to the REACH candidate list. The inclusion of lead in the REACH candidate list does not mean that lead-containing materials pose an immediate risk or results in a restriction of permissibility of its use.

For devices with headphone jacks

WARNINGS/CAUTIONS



Do NOT use the headphones at a high volume for any extended period.

- To avoid hearing damage, use your headphones at a comfortable, moderate volume level.
- Turn the volume down on your device before placing the headphones on your ears, then turn the volume up gradually until you reach a comfortable listening level.

For Products That Include Batteries

Instructions for Users on Removal, Recycling and Disposal of Used Batteries

To remove the batteries from your equipment or remote control, reverse the procedure described in the owner's manual for inserting batteries. For products with a built-in battery that lasts for the lifetime of the product, removal may not be possible for the user. In this case, recycling or recovery centers handle the dismantling of the product and the removal of the battery. If, for any reason, it becomes necessary to replace such a battery, this procedure must be performed by authorized service centers. In the European Union and other locations, it is illegal to dispose of any battery with household trash. All batteries must be disposed of in an environmentally sound manner. Contact your local waste-management officials for information regarding the environmentally sound collection, recycling and disposal of used batteries.

WARNING: Danger of explosion if battery is incorrectly replaced. To reduce risk of fire, explosion or leakage of flammable liquid/gas, don't disassemble, crush, puncture, short external contacts, expose to temperature above 60°C (140°F), sunshine or like, expose to extremely low air pressure or dispose of in fire or water. Replace only with specified batteries. The symbol indicating 'separate collection' for all batteries and accumulators shall be the crossed-out wheeled bin shown below:



WARNING - For Products Contain Coin/Button Cell Batteries

DO NOT INGEST BATTERY, CHEMICAL BURN HAZARD. This product contains a coin/button cell battery. If the coin/button cell battery is swallowed, it can cause severe internal burns in just 2 hours and can lead to death. Keep new and used batteries away from children. If the battery compartment does not close securely, stop using the product and keep it away from children. If you think batteries might have been swallowed or placed inside any part of the body, seek immediate medical attention.

For All Products with Wireless Operation:

HARMAN International hereby declares that this equipment is in compliance with the essential requirements and other relevant provisions of Directive 2014/53/EU. The declaration of conformity may be consulted in the support section of our Web site, accessible from www.jbl.com.

HARMAN International Industries, Incorporated. All rights reserved. JBL is a trademark of HARMAN International Industries, Incorporated, registered in the United States and/or other countries. Features, specifications and appearance are subject to change without notice.



www.jbl.com

ČEŠTINA

DŮLEŽITÉ BEZPEČNOSTNÍ POKYNY

U všech výrobků:

1. Přečtěte si tyto pokyny.
2. Tyto pokyny si uschovejte.
3. Respektujte všechna varování.
4. Postupujte podle všech pokynů.
5. Čistěte pouze suchým hadříkem.
6. Neblokujte žádné větrací otvory. Instalaci spotřebiče provádějte podle pokynů výrobce.
7. Spotřebič neinstalujte v blízkosti zdrojů tepla, jako jsou radiátory, tepelné registry, kamna nebo jiná zařízení (včetně zesilovačů), které produkují teplo.
8. Nemaňte bezpečnostní účel polarizované nebo uzemněné zástrčky. Polarizovaná zástrčka je opatřena dvěma plochými kontakty, kdy jeden je širší než druhý. Uzemňovací zástrčka má dva ploché kontakty a třetí uzemňovací kolík. Pro vaši bezpečnost je k dispozici široký kontakt nebo třetí kolík. Pokud dodaná zástrčka nezapadá do vaší zásuvky, požádejte elektrikáře o výměnu zastaralé zásuvky.
9. Napájecí kabel chraňte před pošlapáním nebo skřípnutím, zejména v okolí zástrček, zásuvek a na místech, kde vystupují ze zařízení.
10. Používejte pouze příslušenství/doplňky určené výrobcem.
11. Používejte pouze vozíky, podstavce, stativy, držáky či stojky doporučené výrobcem nebo prodávané se zařízením. Při používání vozíku buďte opatrní při přemísťování kombinace vozíku/přístroje, abyste zabránili poranění převrácením.
12. Odpojte přístroj během bouřek nebo po dlouhé době nečinnosti.
13. Veškeré opravy může provádět pouze kvalifikovaný servis. Pokud byl přístroj jakýmkoli způsobem poškozen, například když je poškozen napájecí kabel nebo zástrčka, došlo k rozliti kapaliny nebo do přístroje spadly předměty, přístroj byl vystaven dešti nebo vlhkosti, nefunguje normálně nebo byl upuštěn, je vyžadována údržba.
14. Chcete-li spotřebič zcela odpojit od sítě, odpojte zástrčku napájecího kabelu ze zásuvky.
15. Síťová zástrčka napájecího kabelu musí zůstat snadno funkční.
16. Spotřebič je určen k použití pouze s napájecím a/nebo nabíjecím kabelem poskytnutým výrobcem.



Následující pokyny se nemusí vztahovat na vodotěsná zařízení. Další případné pokyny ohledně vodotěsnosti najdete v návodu k použití zařízení nebo ve stručné příručce.

- Přístroj nepoužívejte v blízkosti vody.
- Přístroj nevystavujte kapající nebo stříkající vodě a zajistěte, abyste na něj nepokládali žádné předměty naplněné kapalinami, například vázy.

VÝSTRAHA: CHCETE-LI SNÍŽIT RIZIKO POŽÁRU NEBO ÚRAZU ELEKTRICKÝM PROUDEM, NEVYSTAVUJTE SPOTŘEBIČ DEŠTI NEBO VLHKU.

VÝSTRAHA

NEBEZPEČÍ ÚRAZU ELEKTRICKÝM PROUDEM. NEOTEVÍRAT.



TENTO SYMBOL NA VÝROBKU ZNAMENÁ, ŽE UVNITŘ KRYTÝ VÝROBKU JE NEIZOLOVANÉ NEBEZPEČNÉ NAPĚTÍ, KTERÉ MŮŽE PŘEDSTAVOVAT RIZIKO ÚRAZU ELEKTRICKÝM PROUDEM.



TENTO SYMBOL NA VÝROBKU ZNAMENÁ, ŽE JSOU V TOMTO NÁVODU DŮLEŽITÉ POKYNY O PROVOZU A ÚDRŽBĚ.

UPOZORNĚNÍ A PROHLÁŠENÍ FCC A IC PRO UŽIVATELE (POUZE USA A KANADA)

Toto zařízení vyhovuje části 15 předpisů FCC. Provoz zařízení podléhá následujícím dvěma podmínkám: (1) Toto zařízení nesmí způsobovat škodlivé rušení a (2) toto zařízení musí snést jakékoli vnější rušení, včetně rušení způsobujícího nesprávnou funkci.
CAN ICES-3(B)/NMB-3(B)

PROHLÁŠENÍ O SHODĚ DODAVATELE FCC SDOC

Společnost HARMAN International tímto prohlašuje, že je toto zařízení ve shodě s částí 15, hlavou B předpisů FCC.

Prohlášení o shodě je k dispozici v sekci podpory na našem webu, která je přístupná na adrese www.jbl.com

Prohlášení o rušení federální komise pro spoje

Toto zařízení bylo testováno a shledáno vyhovujícím v souladu s omezeními pro digitální zařízení třídy B podle části 15 předpisů komise FCC. Tato omezení jsou navržena s úmyslem poskytovat rozumnou ochranu před škodlivými vlivy rušení při instalaci v domácnostech. Toto zařízení generuje, používá a může vyzařovat vysokofrekvenční energii a, pokud není instalováno a používáno v souladu s pokyny, může způsobovat škodlivé rušení rádiových komunikací. V žádném případě však není možné zaručit, že v určité konkrétní situaci k rušení

HARMAN

HARMAN International Industries, Incorporated
8500 Balboa Boulevard, Northridge, CA 91329 USA
516.255.4545 (USA only)

SSA2020-002



WARRANTY CARD / ГАРАНТИЯ И СЕРВИС / CARTÃO DE GARANTIA / 제품보증서 / 产品保修卡 / 品質保證書

EN WARRANTY CARD

SET UP INFORMATION & PRODUCT REGISTRATION

Congratulations with the purchase of your new Product. We have done our utmost to make your experience the best one possible. If you have any questions when setting up your Product and would like some helpful hints, we recommend that you visit the relevant country specific support website for your Product: www.jbl.com. There you will also find relevant contact information. If you cannot find the information you are looking for, please contact the vendor that sold the Product to you or contact the relevant JBL customer support center by electronic mail or phone.

We recommend that you register your Product via the relevant country specific website for your Product. Your registration will allow us to inform you about updates for certain products, possible new offers and new Products and/or applications. Registering is easy; just follow the instructions on the relevant country specific website for your Product.

NOTE: THIS LIMITED WARRANTY DOES NOT APPLY TO CONSUMERS IN THE EUROPEAN ECONOMIC AREA (EEA) MEMBER STATES AND THE RUSSIAN FEDERATION AS THEY ARE PROTECTED BY LOCAL CONSUMER LAW AND BENEFIT FROM LOCAL STATUTORY WARRANTIES

LIMITED WARRANTY

WHO IS PROTECTED BY THE WARRANTY

This limited warranty (the "Limited Warranty") protects only the original end-user ("you" or "your"), and is not transferable and is applicable only in the country (excluding EEA member states and the Russian Federation) in which you originally purchased your JBL Product (the "Product"). Any attempt to transfer this warranty shall immediately make this warranty void.

LIMITED WARRANTY

HARMAN International Industries, Incorporated ("HARMAN") is the manufacturer and through its local subsidiary, warrants to you that the Product (including components provided in/with the Product) will be free from defects in workmanship and materials for a period of ONE year from the date of retail purchase by you (the "Warranty Period"). During the Warranty Period, the Product (including components), will be repaired or replaced at HARMAN's option, without charge for either parts or labor OR at HARMAN's sole option, the price of the Product may be refunded, subject to depreciation based on your purchase price for the Product pro-rated over the remaining balance of the Warranty Period. Any warranty service or replacement of parts will not extend the Warranty Period.

This Limited Warranty does not cover defects which are a result of: (1) damage caused by accident, unreasonable use or neglect (including the lack of reasonable and necessary maintenance); (2) damage during shipment (claims must be presented to the carrier); (3) damage to, or deterioration of, any accessory or decorative surface; (4) damage resulting

from failure to follow instructions contained in your owner's manual; (5) damage resulting from the performance of repairs by someone other than an authorized JBL service center; (6) deterioration of component parts, the nature of which is to become worn or depleted with use, such as batteries and headphone ear pads.

Furthermore, this Limited Warranty covers only actual defects within the Product itself, and does not cover the cost of installation or removal from a fixed installation, setup or adjustments, claims based on misrepresentation by the seller, performance variations resulting from installation-related circumstances such as source quality or AC power or Product modifications, any unit on which the serial number has been effaced, modified or removed, or units used for other than home use. This Limited Warranty is valid only for JBL products purchased from an authorized dealer.

Except to the extent expressly prohibited in your jurisdiction by applicable law, all implied warranties, including fitness for a particular purpose and merchantability are hereby excluded and in no event shall HARMAN or any HARMAN subsidiary be liable for any indirect, direct, incidental, special or consequential loss or damages whatsoever (including, without limitation, other pecuniary loss) arising out of the use of or inability to use the Product, even if HARMAN and/or a HARMAN subsidiary have been advised of the possibility of such damages. To any extent that HARMAN cannot lawfully disclaim implied warranties under this Limited Warranty, all such implied warranties are limited in duration to the duration of this warranty. Some jurisdictions do not allow the exclusion or limitation of incidental or consequential damages or exclusions or limitations on the duration of implied warranties or conditions, so the above limitations or exclusions may not apply to you. This warranty gives you specific legal rights, and you may also have other rights that vary by jurisdiction.

HOW TO OBTAIN WARRANTY SERVICE

Contact the dealer who sold you this Product, or contact JBL customer support using the contact information on the relevant country specific support website for your Product to request warranty service. To validate your right to this Limited Warranty, you must provide the original sales invoice or other proof of ownership and date of purchase. Do not return your Product without prior authorization from the corresponding dealer or HARMAN. Warranty repair of the HARMAN Product must be carried out by an authorized dealer or service center. Unauthorized warranty repair will void the warranty and is performed at your sole risk.

You are also welcome to consult the relevant country specific HARMAN support website for your Product for helpful hints.

WHO PAYS FOR WHAT

This Limited Warranty covers all expenses for labor and materials required for the repair OR replacement of the Product that is found to be defective, and a reasonable return shipping charge within the country of repair. Please be sure to save the original shipping carton(s), because a charge will be made for additional cartons/packaging.

You will be charged for the cost of examining a unit that is not in need of repair (including resulting shipping costs), or for necessary repairs not covered by this Limited Warranty.

We sincerely thank you for your expression of confidence in JBL. We wish you many years of listening pleasure.