

PHILIPS

hue personal
wireless
lighting

17466/**/N7



S/N:D29847

HUE serial number

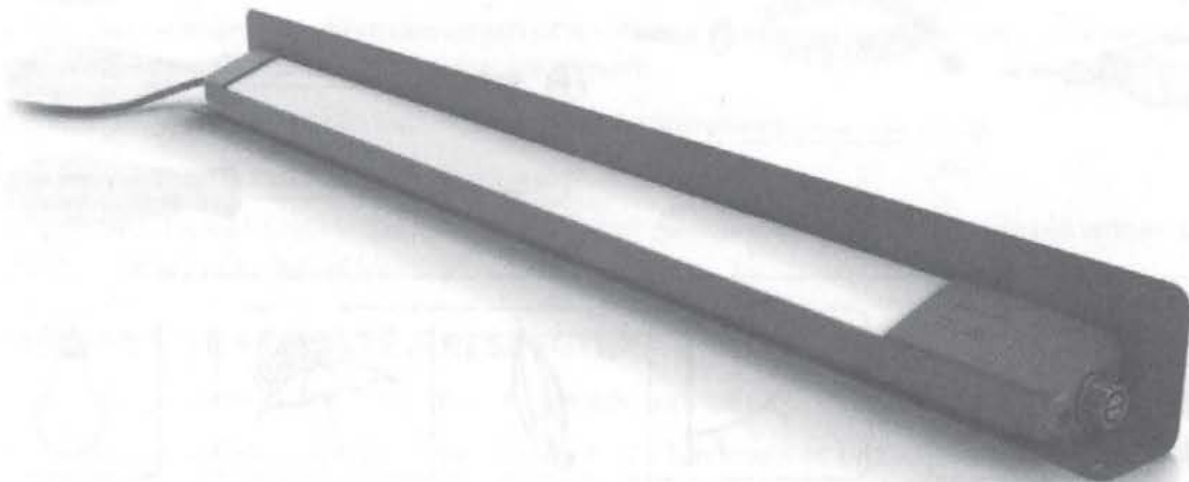

User manual
Notice d'emploi
Manual de usuario

Incl.

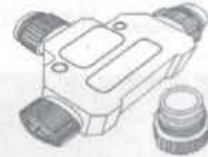

Excl.

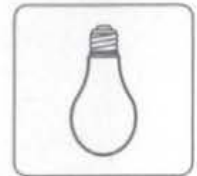
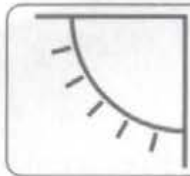
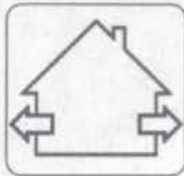
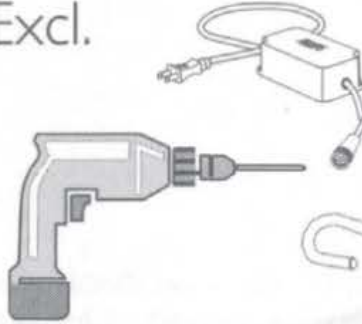

EN IMPORTANT SAFETY INSTRUCTIONS

- Product appearance may vary from image shown.
- UL Listed Landscape Lighting System. This luminaire and power supply unit is intended for installation in accordance with the National Electrical Code and local code specifications. Failure to adhere to these codes and instructions may result in serious injury and/or damage to the PSU and void the warranty. These instructions do not purport to cover all details or variations in equipment, nor to provide for every possible contingency related to installation, operation, maintenance, or mounting situation. Should specific problems occur that are not addressed by these instructions, contact your Sales Representative or distributor for assistance.
SAVE THESE INSTRUCTIONS for future reference.
- Warning: do not use an extension cord.
- The plug on the power supply unit must be connected to a GFCI protected hooded flush type cover plate receptacle marked "Wet Location" while in use.
- Protect the wire by routing it in close proximity to the light fitting, or next to a building structure such as a house or a deck.
- The landscape wire and connector can also be hidden under stone or buried under grass at a maximum depth of 6 inches (15.2 cm).
- Philips recommends a minimum depth of 4 inches when burying in the lawn to prevent damage from aerators or other lawn plugging equipment.
- Philips recommends not to bury the T-shaped connectors.
- Do not submerge luminaire or PSU in water.
- **WARNING:** Risk of Electric Shock. Do not install power supply unit or luminaires within 10 feet (3.05 m) of a pool, spa, or fountain.

FR MÉSURES DE SÉCURITÉ À RESPECTER

- L'apparence du produit peut différer de l'image montrée.
- Système d'éclairage paysager homologué UL. Ce luminaire et bloc d'alimentation est conçu pour être installé conformément au Code national de l'électricité et aux spécifications des codes locaux. Le non-respect de ces codes et instructions peut entraîner des blessures graves et/ou endommager le bloc d'alimentation et annuler la garantie. Ces instructions ne prétendent pas couvrir tous les détails ou les variations de l'équipement, ni fournir une éventualité liée à l'installation, l'opération, la maintenance ou la situation de montage. Si des problèmes spécifiques se produisent, veuillez contacter votre représentant commercial ou votre distributeur pour obtenir de l'aide. CONSERVEZ CES INSTRUCTIONS pour référence future.
- Attention: ne pas utiliser une rallonge.
- La fiche du bloc d'alimentation doit être connectée à un réceptacle de plaque de recouvrement à couvercle à capuchon protégé par GFCI marqué "Emplacement humide" pendant l'utilisation.
- Protégez le fil en l'acheminant à proximité du luminaire ou à proximité d'une structure de bâtiment comme une maison ou un pont.

- Le fil et le connecteur peuvent également être enterrés sous l'herbe à une profondeur maximale de 6 pouces (15,2 cm).
- Philips recommande une profondeur minimale de 4 pouces lors de l'enfouissement dans la pelouse pour éviter les dommages causés par les aérateurs ou d'autres équipements de branchage.
- Philips recommande de ne pas enterrer les connecteurs en forme de T.
- Ne pas submerger le luminaire ou le bloc d'alimentation dans l'eau
- **AVERTISSEMENT:** Risque de choc électrique. N'installez pas le bloc d'alimentation ou les luminaires à moins de 10 pieds (3,05 m) d'une piscine, un spa ou une fontaine.

ES

INSTRUCCIONES DE SEGURIDAD IMPORTANTES

- La apariencia del producto puede variar de la imagen mostrada.
- Sistema de iluminación de jardín listado por UL. La luminaria y la unidad de fuente de alimentación están diseñadas para su instalación de acuerdo con el Código Eléctrico Nacional y las especificaciones del código local. El incumplimiento de estos códigos e instrucciones puede provocar lesiones graves y/o daños a la fuente de alimentación y anular la garantía. Estas instrucciones no pretenden cubrir todos los detalles o variaciones en el equipo, ni prever todas las contingencias posibles relacionadas con la instalación, operación, mantenimiento o situación de montaje. Si se producen problemas específicos que no se abordan en estas instrucciones, comuníquese con su representante de ventas o distribuidor para obtener ayuda. **GUARDE ESTAS INSTRUCCIONES** para referencia futura.
- Advertencia: no use un cable de extensión.
- El enchufe de la unidad de fuente de alimentación debe estar conectado a un receptáculo de placa de cubierta tipo Flush con protección GFCI marcado como "Ubicación húmeda" mientras está en uso
- Proteja el cable conduciéndolo cerca de la luminaria, o junto a la estructura de un edificio, como una casa o tejado.
- El cable y el conector también pueden esconderse debajo de piedra o enterrarse bajo el césped a una profundidad máxima de 6 pulgadas (15.2 cm).
- Philips recomienda una profundidad mínima de 4 pulgadas cuando se entierre en el césped para evitar daños.
- Philips recomienda no enterrar los conectores en forma de T.
- No sumerja la luminaria o fuente de alimentación en agua.
- **ADVERTENCIA:** Riesgo de descarga eléctrica. No instale la fuente de alimentación ni las luminarias a menos de 10 pies (3.05 m) de una piscina, spa o fuente.

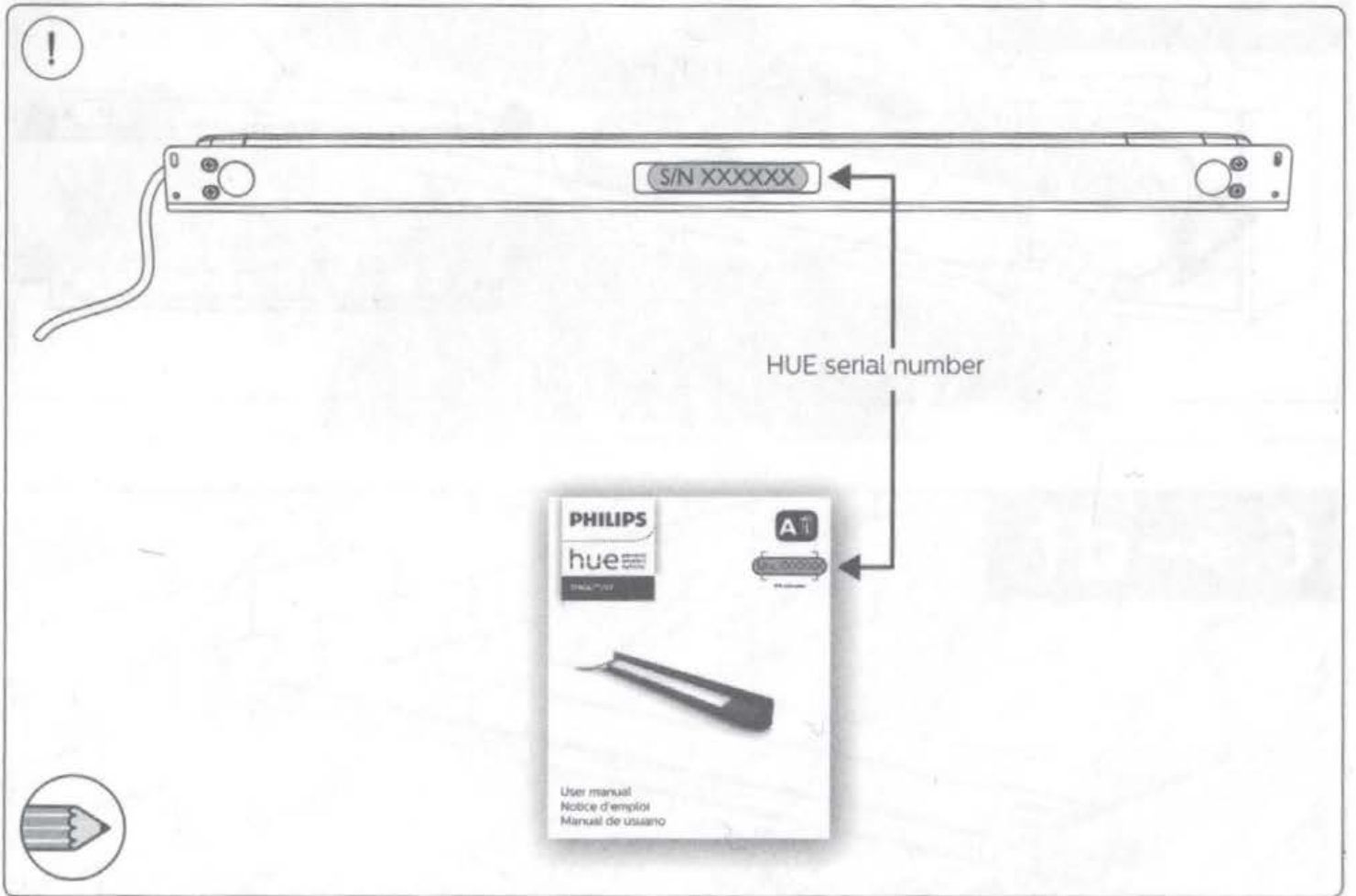

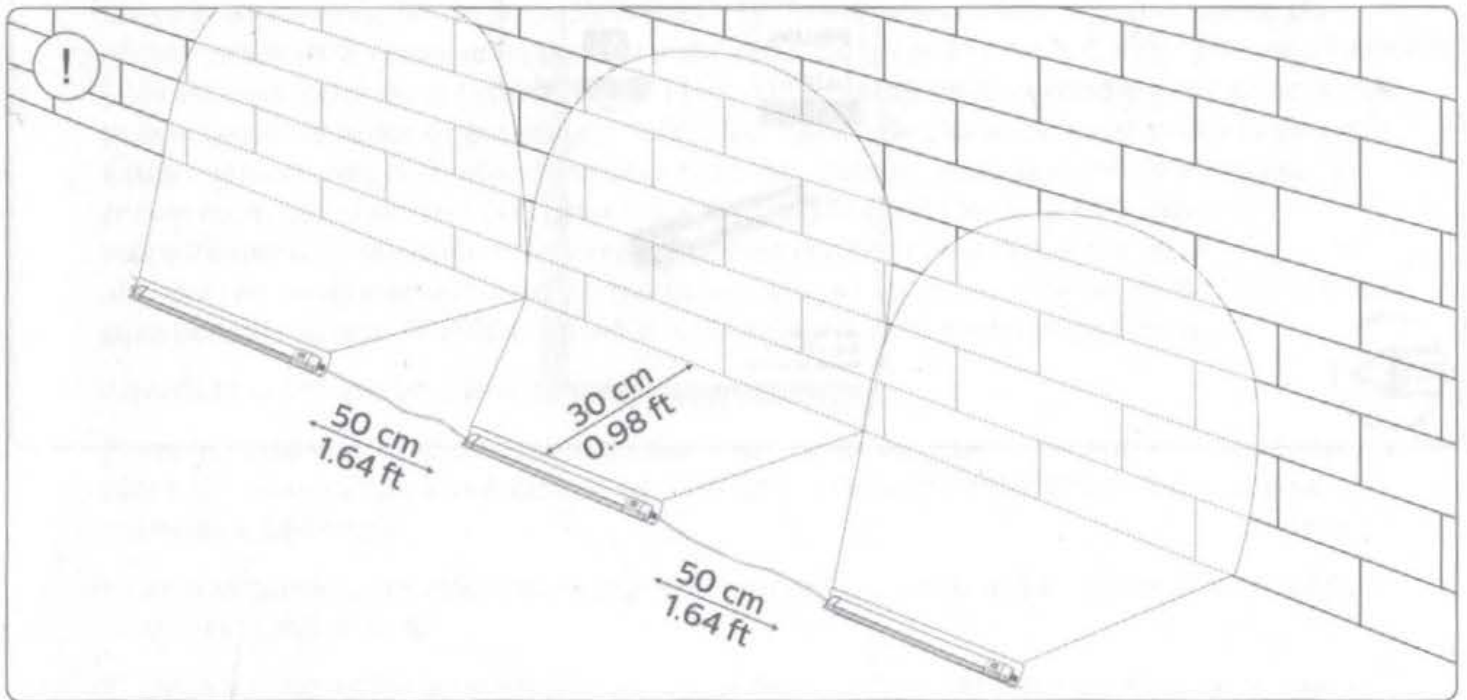
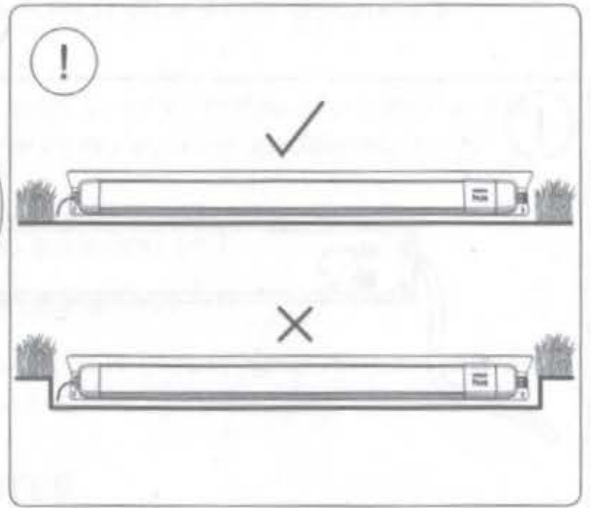
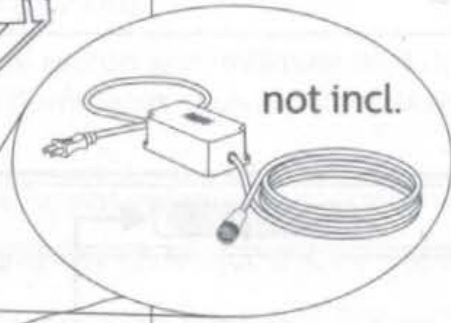
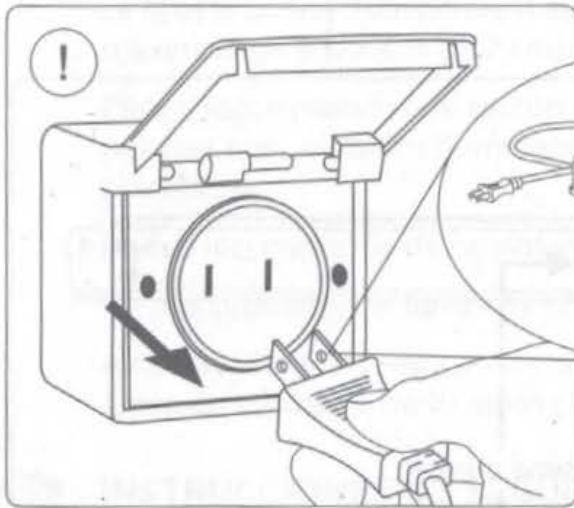

1a

1a → 2

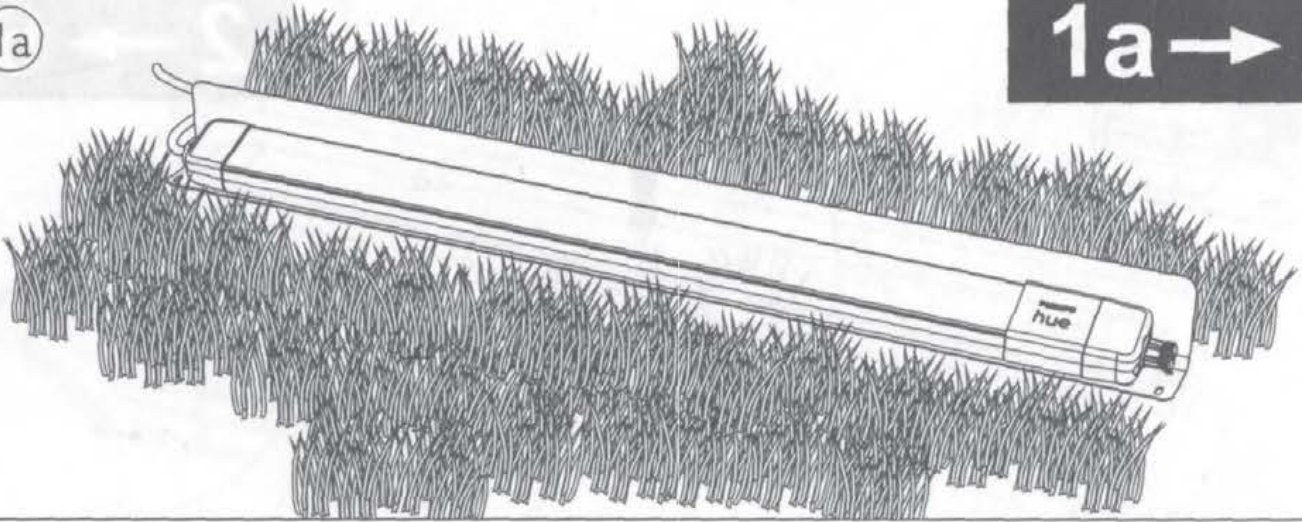

1b

1b → 3

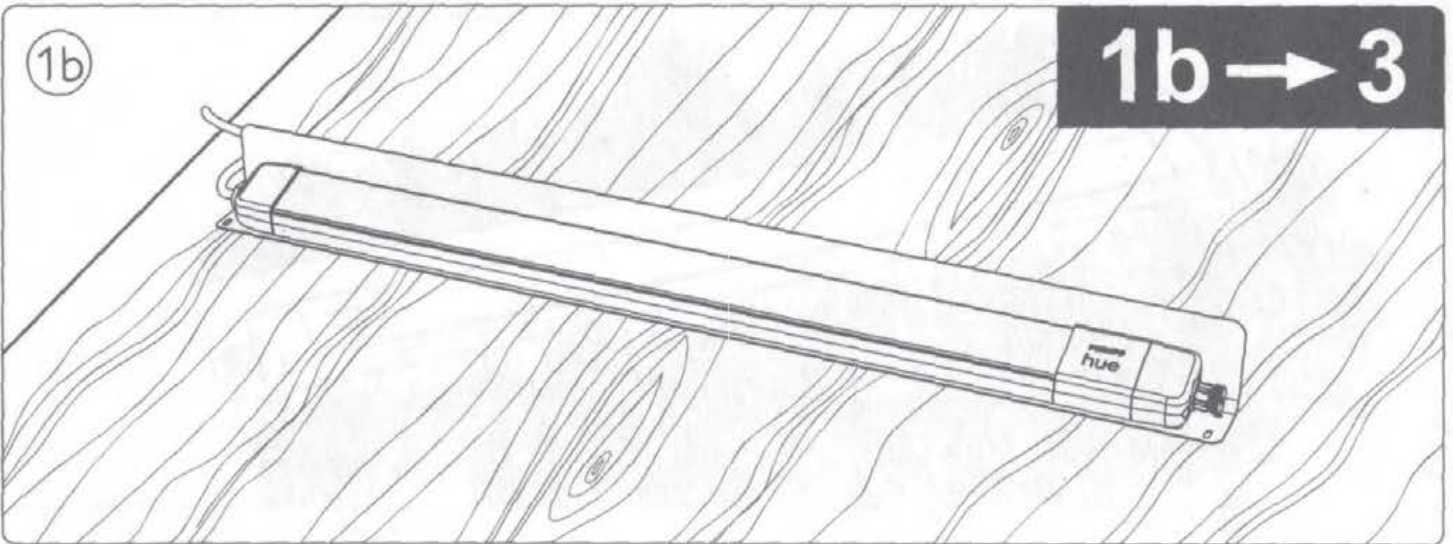

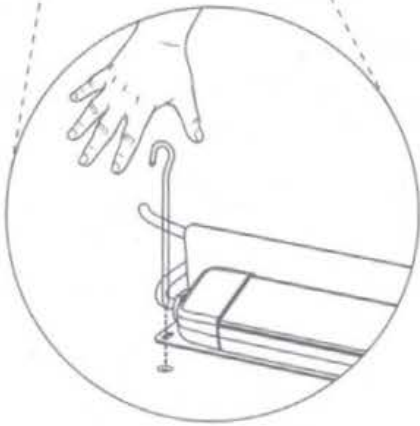
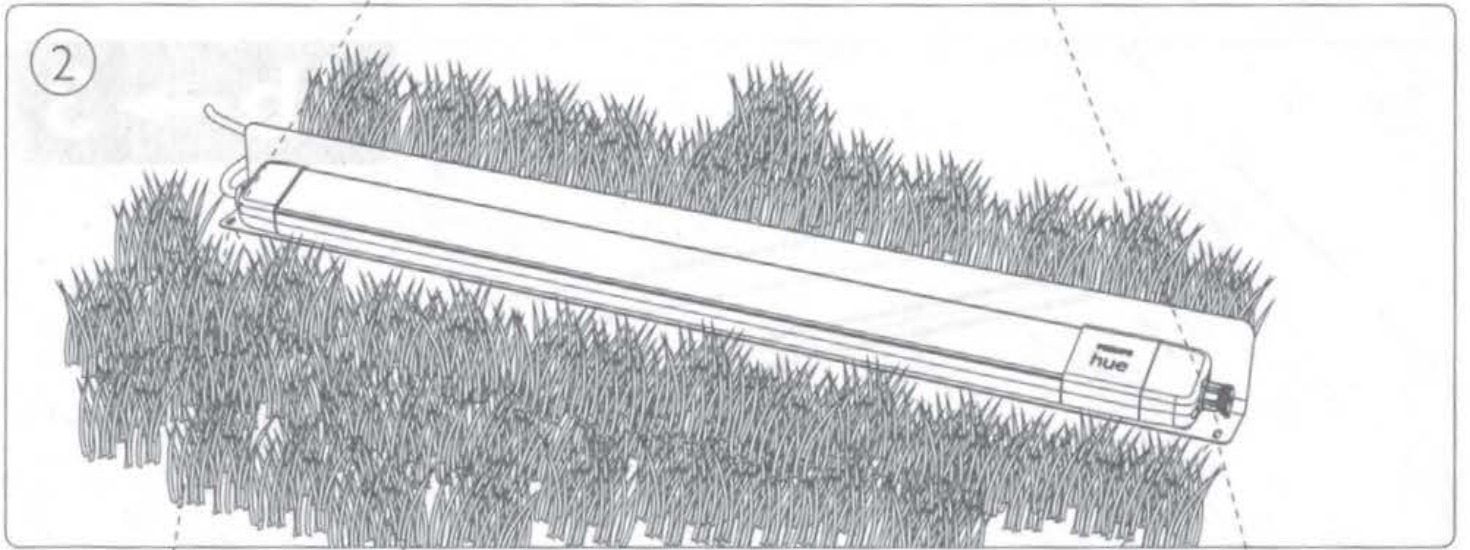
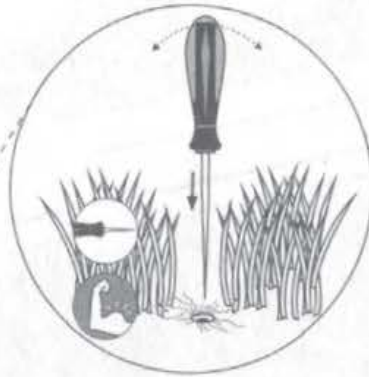

2b

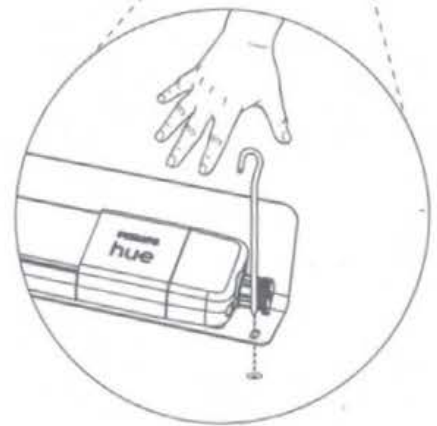

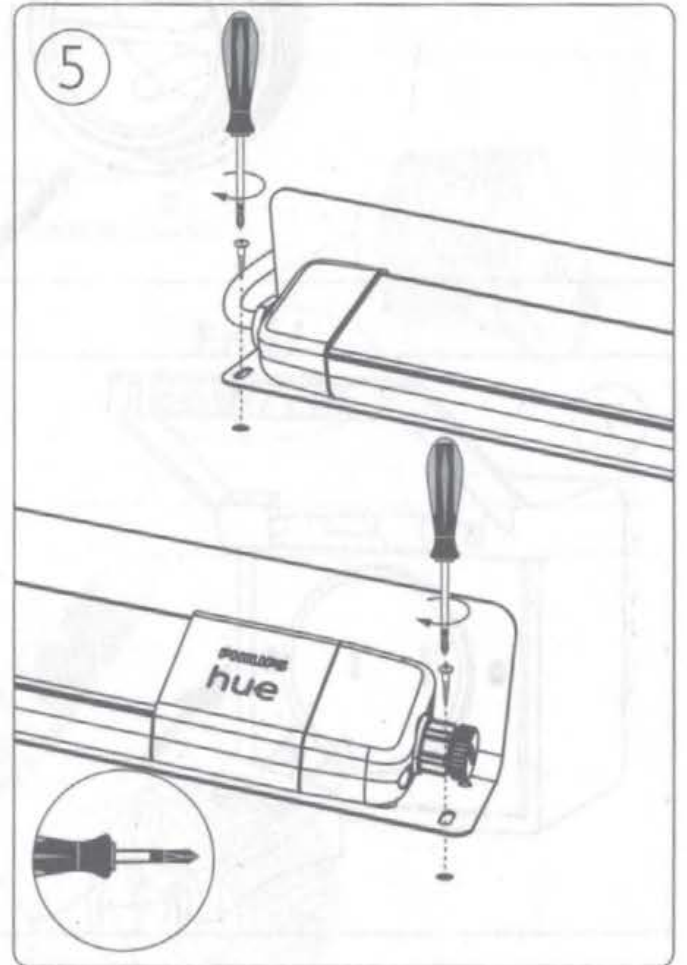
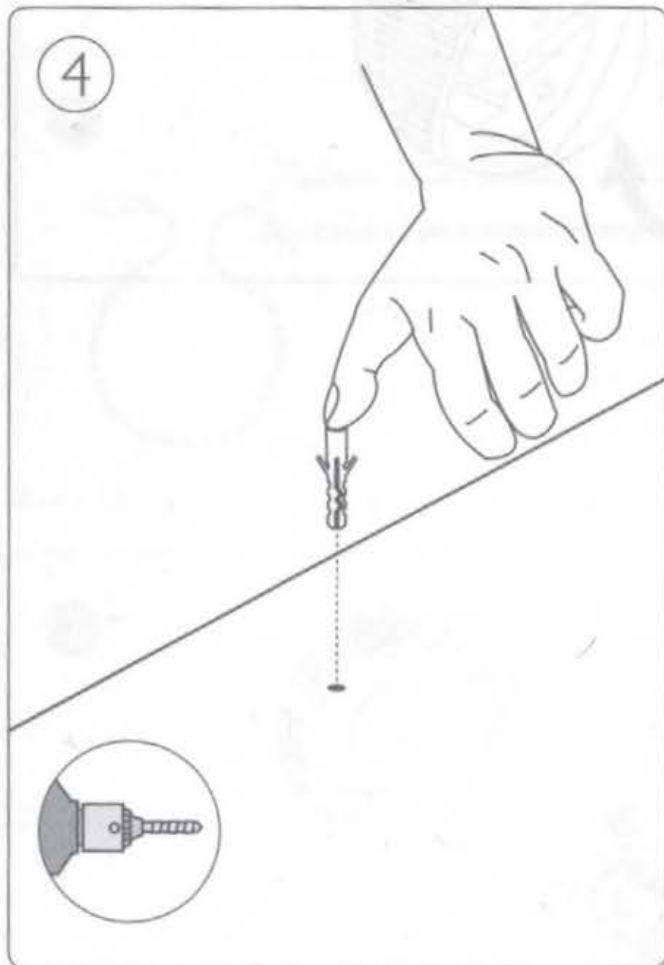
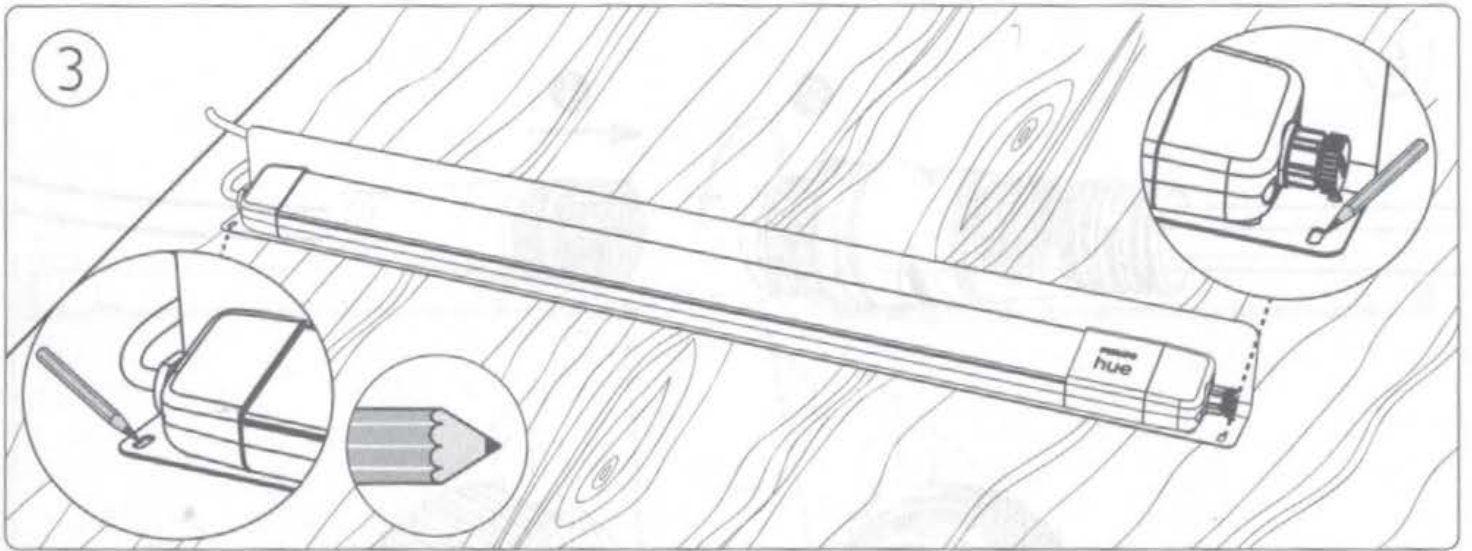

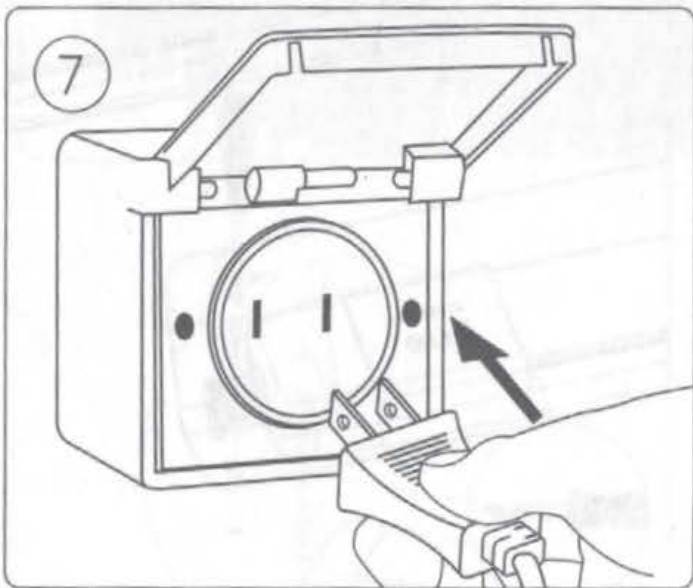
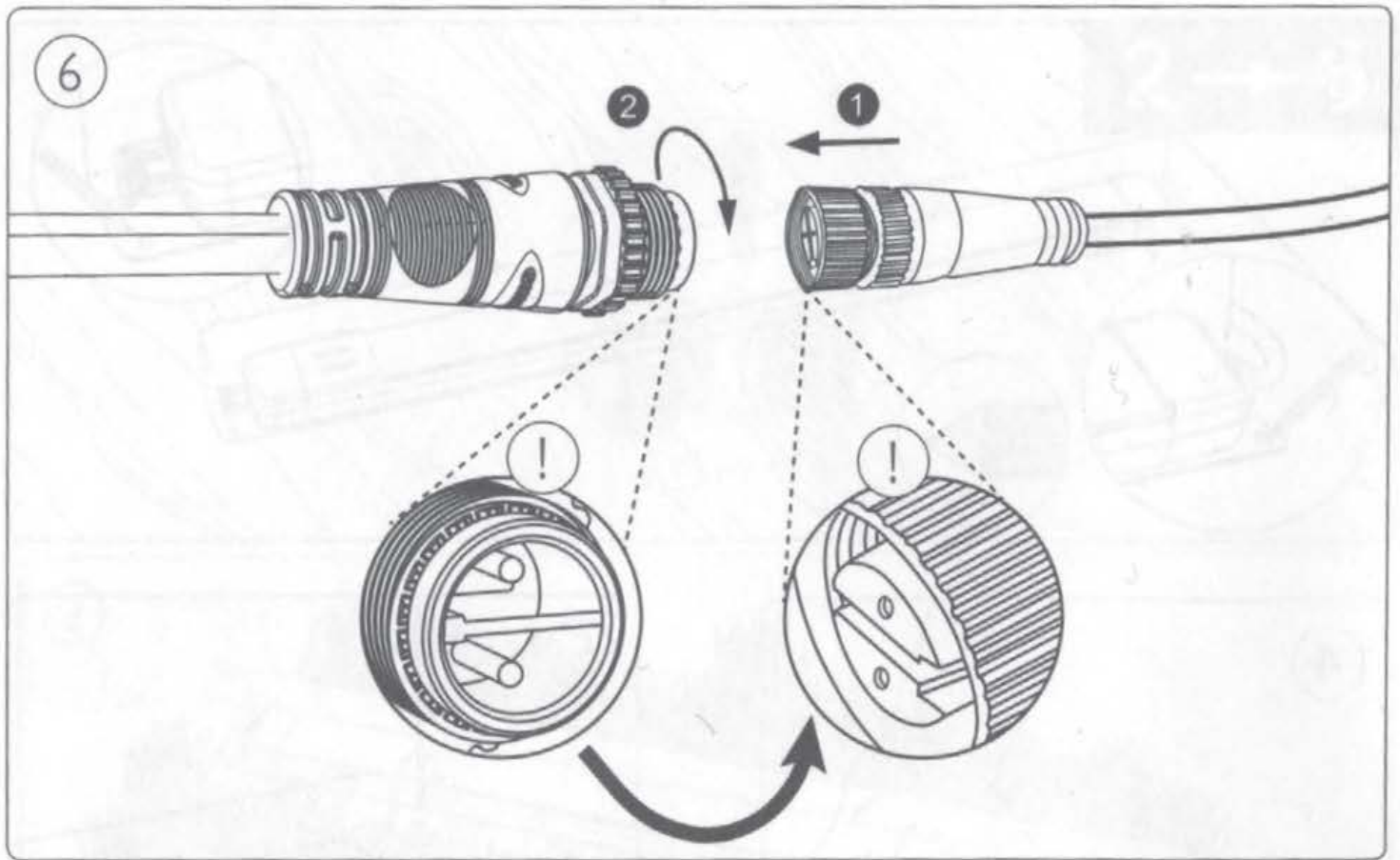

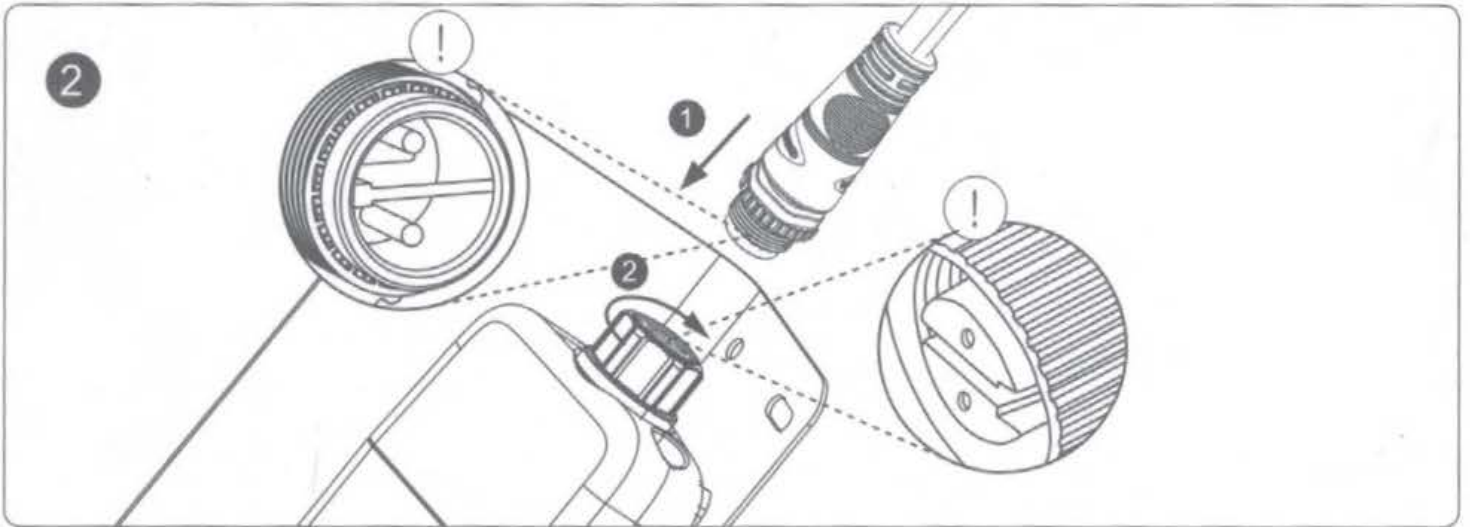
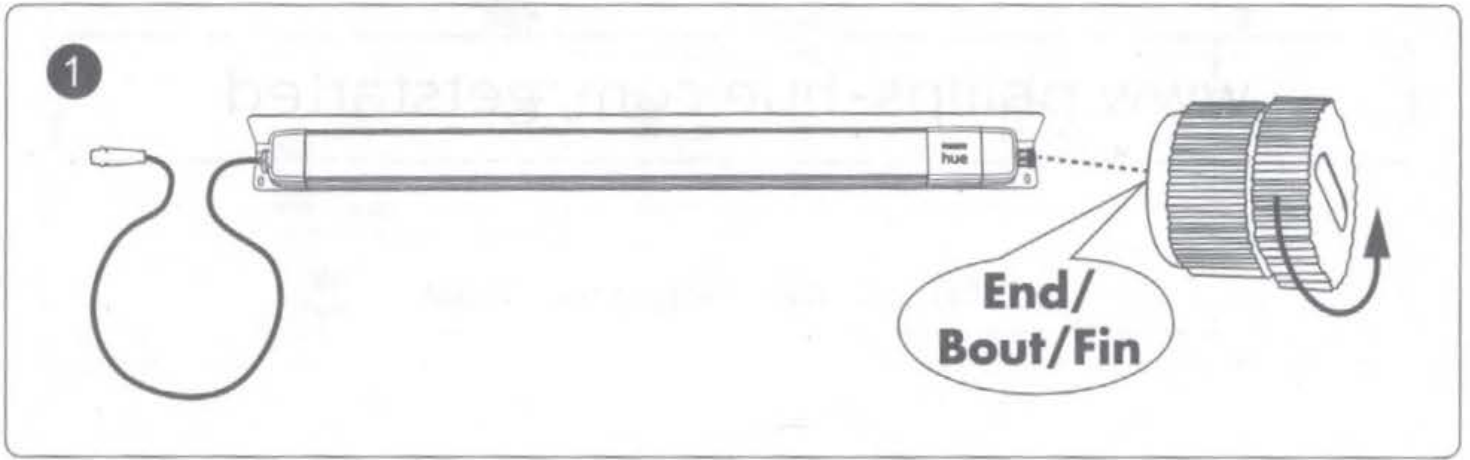
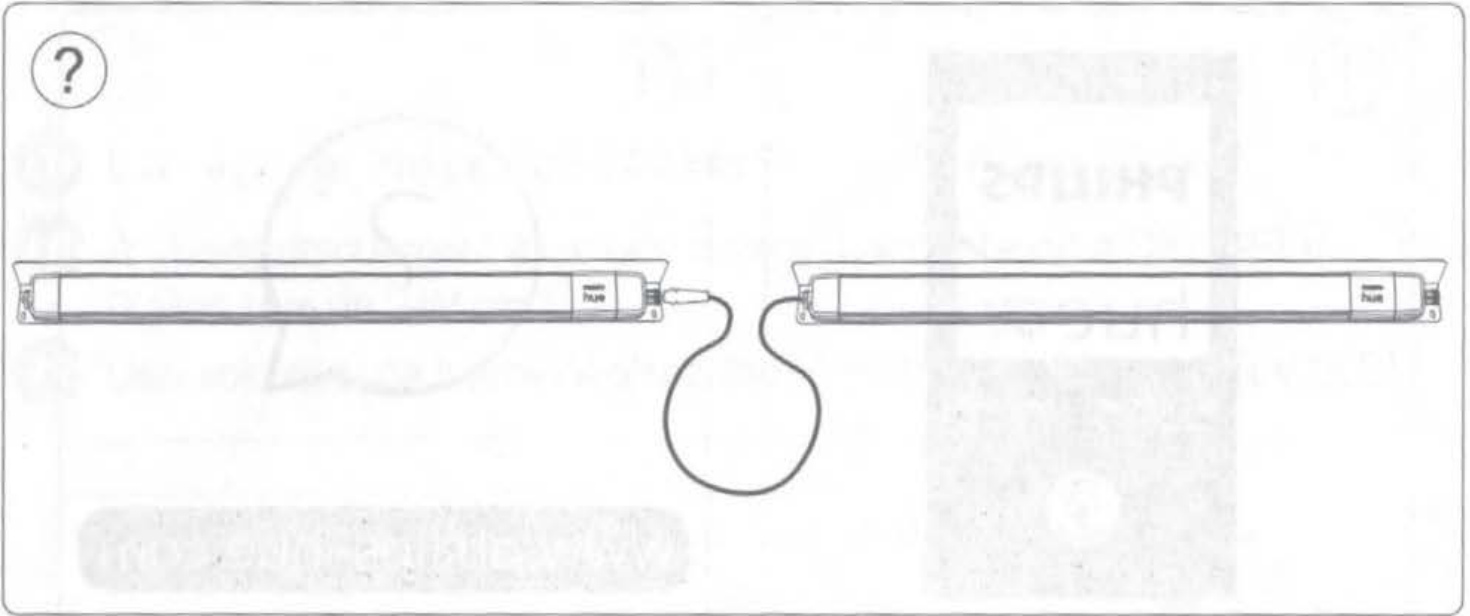



www.philips-hue.com/getstarted



- EN Use only with Philips HUE 24V === SELV LED Power Supply!
- FR À utiliser uniquement avec une source d'alimentation à DEL SELV Philips Hue de 24V === !
- ES Usar solo con una fuente de alimentación Philips Hue 24V === SELV LED!

Low Voltage system / Système basse tension / Sistema de baja tensión

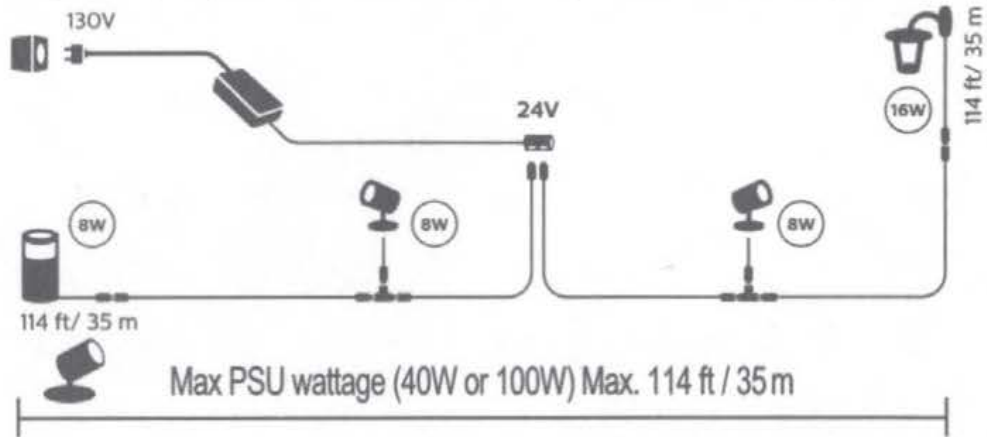



Signify North America Corporation
200 Franklin Square Drive
Somerset, NJ 08873, USA

Signify Canada Ltd./Signify Canada Ltée.
281 Hillmount Road,
Markham, ON, Canada L6C 2S3
Questions or Comments / Questions ou commentaires :
1-800-555-0050

Importado y/o distribuido en México por:
Signify Mexico S.A. de C.V.
Av. La Palma N° 6-Col. San Fernando,
La Herradura Huixquilucan
Edo. De México, C.P. 52784 - R.F.C. PME-620620-E84

Centro de contacto :
01-800-508-9000

© 2020 Signify Holding

All rights reserved

www.philips-hue.com

4404 029 13361

Last update: 08/2020

PHILIPS

hue personal
wireless
lighting

Get started

with Philips Hue

Commencez

avec Philips Hue





Install Hue fixtures/ bulbs:



Find the serial number of the product as indicated in the A manual. Write down the serial number.



Install your Hue fixture, then switch it on. Please check the A manual.



Start the Hue app and follow the instructions.



Go to the app settings menu.



Select Light set up for adding your fixtures.



Tap on the (+) icon and follow on screen instructions.

You have succeeded in pairing your Hue fixtures to the Hue bridge*.

S/N _____

For more information visit:

www.meethue.com

*Hue bridge not included in the box.

The Hue System / Le système Hue





Smart Control by Hue App /
Commande intelligente
avec l'application Hue

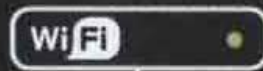

Hue Bulbs /
Hue ampoules

Hue Bridge
The heart of your Hue system /
Hue pont
le coeur du système Hue

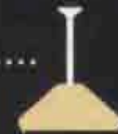

Hue Luminaires /
Hue fixtures -
luminaires

Hue accessories / accessoires



Voice control ready /
Prêt pour la
commande vocale



Hue Motion sensor /
Détecteur
de mouvement



Hue Dimmer switch /
Gradateur

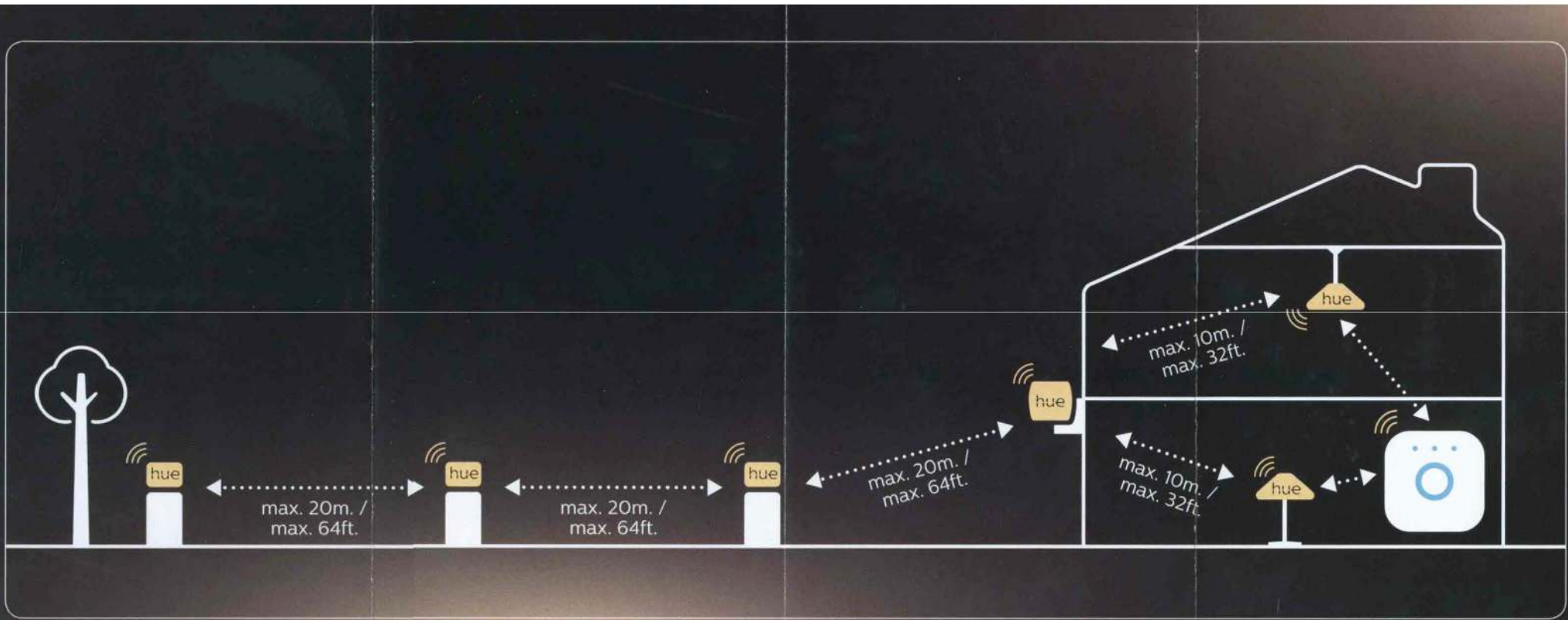



www.meethue.com

440402909441



PHILIPS

hue personal wireless lighting

Get started
with Philips Hue

Commencez
avec Philips Hue



PHILIPS

Safety instructions
Consignes de sécurité
Instrucciones de
seguridad



Signify North America Corporation
200 Franklin Square Drive
Somerset, NJ 08873, USA

Signify Canada Ltd./Signify Canada Ltée.
281 Hillmount Road,
Markham, ON, Canada L6C 2S3

Importado y/o distribuido en México por:
Signify Mexico S.A. de C.V.
Av. La Palma N° 6-Col. San Fernando,
La Herradura Huixquilucan
Edo. De México,
C.P. 52784 - R.F.C. PME-620620-E84

© 2020 Signify Holding

Questions or Comments
Questions ou commentaires
1-800-555-0050

Centro de contacto
01-800-508-9000

www.philips.com/lighting
www.philips-hue.com

4404 029 11882
Last update: 08/2020

01

02

03

04

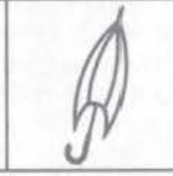
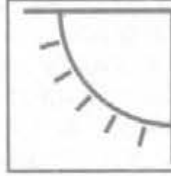
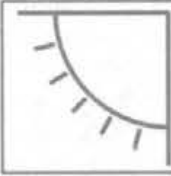

05

06

07

08

09

10

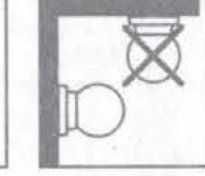
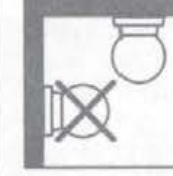
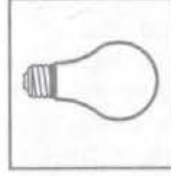
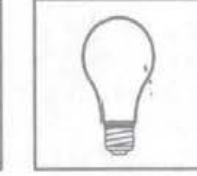
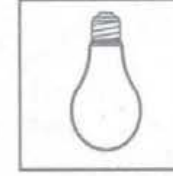
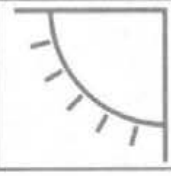

11

12

13

14

15

16

17

18

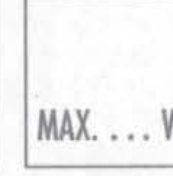
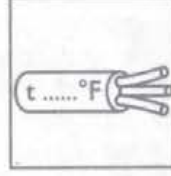
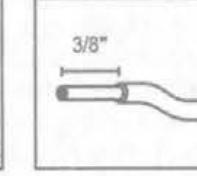
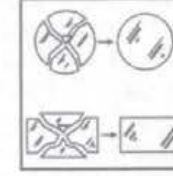
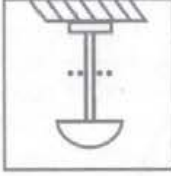
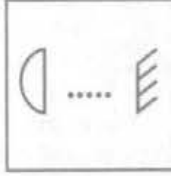
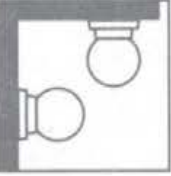

19

20

21

22

23

24

25

26

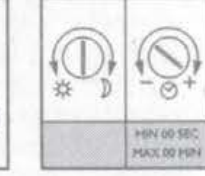
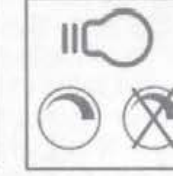
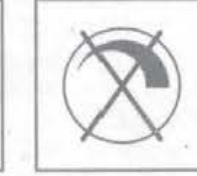
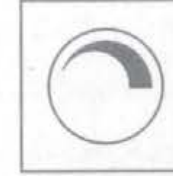
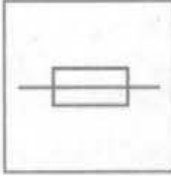

27

28

29

30

31

32

33

34

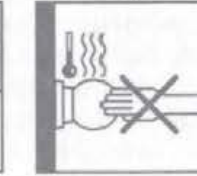
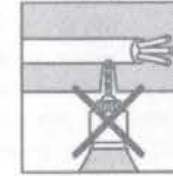
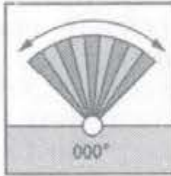
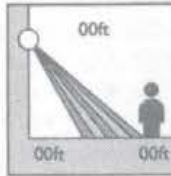

35

36

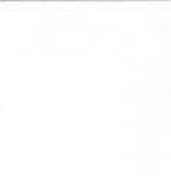

EN - SAFETY INSTRUCTIONS - PART B

The manufacturer advises the correct use of Luminaires (lighting fixtures)! Therefore always follow these instructions to ensure correct and safe installation and functioning of the luminaire and keep it for future reference. Turn off electrical power at main fuse or circuit breaker box before commencing installation, maintenance or repair. If in doubt, consult a qualified electrician or contact your retail outlet. Ensure that you always install the luminaire to the local electrical code. Certain regulations indicate that luminaires should be installed by a qualified electrician. Observe the correct color of the wiring before installation: white (N), black (L) and green or bare copper wire (Ground). Do not connect this luminaire to a non-grounded electrical system. **WARNING:** Installing this fixture in a non-grounded electrical system could allow metal parts of the luminaire to carry electrical current if any wires or wire connections become broken or loose. Under this condition, anyone coming in contact with the luminaire is subject to electric shock which could cause injury or death. Always use wire nuts/connectors rated for the correct gauge and number of wires used. **CAUTION:** Be certain that no bare wire strands are exposed outside of the wire nuts/connectors (if applicable). Be careful not to damage or cut the wire insulation (covering) during installation. Do not permit wires to contact any sharp edges. Do not remove thermal insulation pad(s). Doing so will result in increased temperatures and possible risk of fire. Maintain interior lighting with a dry cloth duster, do not use abrasives or solvents. Avoid liquid on all electrical parts. Always consider all the technical specifications of the luminaire. Verify the stated icons on the identification label on the luminaire and the icons that are shown in part A of your safety instructions. **ATTENTION:** Below you will find all the explanations with numeric reference to the icons respectively in front of these PART-B safety instructions. Applicable icons to your fixture are shown in PART-A safety instructions.

1) This product should only be installed indoors. 2) The product is suitable for outdoor usage. 3) Only suitable for dry locations. 4) Suitable for damp locations. 5) Suitable for wet locations. 6) Luminaire is suitable for base up mounting. 7) Luminaire is suitable for base down mounting. 8) Luminaire is suitable for horizontal mounting. 9) The luminaire is only suitable for fixing to the ceiling. 10) The luminaire is only suitable for fixing to the wall. 11) The luminaire is suitable for fixing to the wall and to the ceiling. 12) Always observe the minimum distance between the lamp and the surface being lit as indicated on the icon. 13) Free air space of at least 4 inches must be kept between top of shade and bottom of canopy. 14) Immediately replace a cracked or broken safety glass and use only manufacturer approved parts. 15) Strip the wire as indicated in the diagram. 16) Use heat-resistant cable for wiring the luminaire into the mains. 17) MAX. ... W: only use lamps suitable for this luminaire and keep within the maximum specified wattage. 18) This product is not suitable for children under 14 years. 19) The Luminaire has a ground conductor identified with green insulation or bare copper wire. 20) The luminaire is only suitable for a lamp with built-in safety or a low pressure lamp. An extra safety glass is not necessary. 21) The luminaire is equipped with a fuse. If the luminaire is out of order after the bulb has been replaced, the internal fuse has to be replaced. If contact with the internal wiring can be made during this operation, this should be done by a competent electrician. 22) The luminaire can be used with a dimming circuit. Consult a qualified electrician for choosing the right type (especially important for low voltage luminaires). 23) The Luminaire cannot be used with a dimming circuit. 24) The luminaire is dimmable with the supplied dimmer ONLY. Do not connect to an additional dimmer. 25) The dimmability features depend on the chosen lamp. More information on the dimmability features is available in the information pack provided with the bulb. 26) Luminaire with time and light setting options. Minimum and maximum will be shown in the icon in part A. 27) The luminaire can be placed at a maximum of 20ft height. 28) To reach an optimal working, you have to place the luminaire on the height mentioned in the icon. The maximum and minimum reach of the detector is also mentioned in the icon in part A. 29) The standard active range of vision of the detector covers the given degrees mentioned in the icon. 30) Ensure that you don't drill through electrical wires or any other obstruction in the wall or ceiling during installation! 31) This luminaire contains in some places very hot parts. 32) Product to be installed by two people. 33) To avoid corrosion, clean the luminaire a minimum of 2 times per year with a soft cloth and a neutral detergent. (4 times in coastal or industrial areas). 34) The product is for indoor use only. Do not use in wet locations, areas directly exposed to water or outdoors. 35) The product is ZigBee certified. Zigbee is an open standard for indoor wireless communication. All Philips ZigBee Certified products can be connected with other Philips ZigBee Certified products. 36) Bluetooth® enabled product. The Bluetooth® word mark and logos are registered trademarks owned by Bluetooth SIG, Inc. and any use of such marks by Signify is under license. Other trademarks and trade names are those of their respective owners. Hue Personal Wireless Lighting is a trademark owned by Signify Holding B.V. Please go to www.philips-hue.com to learn more about Hue and how to use it.

This device complies with Part 15 of the FCC Rules and with RSS of Industry Canada. Operation is subject to the following two conditions: (1) this device may not cause harmful interference, and (2) this device must accept any interference received, including interference that may cause undesired operation. This equipment has been tested and found to comply with the limits for a Class B digital device, pursuant to part 15 of the FCC Rules. These limits are designed to provide reasonable protection against harmful interference in a residential installation. This device generates, uses, and can radiate radio frequency energy and, if not installed and used in accordance with the instructions, may cause harmful interference to radio communications.

This Class B digital apparatus complies with CAN ICES-005. This digital apparatus does not exceed the class B limits for radio-noise emissions from digital apparatus as set out in the Radio Interference Regulations of the Canadian

Department of Communications.

NOTICE: Changes or modifications made to this device not expressly approved by Signify North America Corporation (USA) and Signify Canada Ltd/Signify Canada uee. (Canada) (collectively "Signify") may void the U.S. FCC and Canadian authorization to operate this device. The advanced interface module complies with FCC radiation exposure limits set forth for an uncontrolled environment. This device should be installed and operated with a minimum distance of 20 centimeters between the radiator and your body. The manufacturer is not responsible for any radio or TV interference caused by unauthorized modifications to this equipment. Such modifications could void the user's authority to operate the equipment. However, there is no guarantee that interference will not occur in a particular installation. If this device does cause harmful interference to radio or television reception, which can be determined by turning the device off and on, the user is encouraged to try to correct the interference by one or more of the following measures: Reorient or relocate the receiving antenna. • Increase the separation between the device and receiver. • Connect the device into an outlet on a circuit different from that to which the receiver is connected. • Consult the dealer or an experienced radio/television technician for help.

Wireless Specification: Wireless RF mode frequency band: 2400-2483.5 MHz • Wireless communications protocol: IEEE 802.15.4 • Operating channels Zigbee: channels 11 - 26 • Operating channels Bluetooth: channels 0-39

LIMITED WARRANTY: Signify warrants that this device's hardware components will be free from defects in material and workmanship for a period of two (2) years from the date of purchase, unless a different period is stated in or on the packaging of the product, based on up to 3 hours average working time per day/7 days per week, when used as directed (the "Warranty Period"). Notwithstanding the foregoing, the Warranty Period for all Energy Star-certified products is three (3) years from the date of purchase. This limited warranty only applies to the hardware components contained in the original packaging. This limited warranty does not apply to any software, even if packaged or sold with the hardware components. Signify does not warrant that use of this device will be uninterrupted or error-free. If this device does not conform to this limited warranty, Signify will send you, at its election, a replacement device or refund your original price upon receipt of the returned device, register receipt and proof of purchase. Please call our toll-free number, 1-800-555-0050, or write to us (address indicated on the packaging) to find out how to return the device. This limited warranty does not cover devices subject to accident, neglect, abuse, misuse or acts of God. REPLACEMENT OR REFUND IS YOUR SOLE REMEDY. EXCEPT TO THE EXTENT PROHIBITED BY APPLICABLE LAW, ANY IMPLIED WARRANTIES ARE LIMITED IN DURATION TO THE DURATION OF THIS LIMITED WARRANTY. LIABILITY FOR INCIDENTAL OR CONSEQUENTIAL DAMAGES IS HEREBY EXPRESSELY EXCLUDED. Some states and provinces do not allow exclusion of incidental or consequential damages, so the above limitation or exclusion may not apply to you. This limited warranty gives you specific legal rights, and you may also have other rights which vary from state to state and province to province. This limited warranty is subject to, and may be superseded by, our End of Support policy to the extent Signify decides to terminate support for this device in accordance with its End of Support policy, available here:

www.philips-hue.com/endofsupportpolicy

Philips and the Philips Shield Emblem are registered trademarks of Koninklijke Philips N.V. Alterations in design and technical specifications reserved.

FR - CONSIGNES DES SÉCURITÉ - PARTIE B

Le fabricant décrit l'usage approprié des luminaires (appareils d'éclairage)! Par conséquent, suivez toujours ces directives pour assurer une installation adéquate et sécuritaire, ainsi que le bon fonctionnement du luminaire, et conservez-les pour référence ultérieure. Coupez l'alimentation électrique au boîtier de fusibles ou de disjoncteurs principaux avant de commencer l'installation, l'entretien ou la réparation. En cas de doute, consultez un électricien qualifié ou communiquez avec votre détaillant. Assurez-vous de toujours installer le luminaire conformément au code électrique en vigueur dans votre localité. Certaines réglementations exigent que les luminaires soient installés par un électricien qualifié. Observez la bonne couleur des fils avant l'installation: blanc (neutre), noir (alimenté) et vert ou fil de cuivre nu (masse). Ne raccordez pas ce luminaire à un système électrique sans mise à la terre.

AVERTISSEMENT: L'installation de cet appareil d'éclairage dans un système électrique non mis à la terre peut permettre aux pièces de métal du luminaire de porter un courant électrique si l'un des fils ou l'une des connexions se casse ou devient lâche. Dans une telle situation, quiconque entrerait en contact avec le luminaire subirait un choc électrique pouvant causer des blessures et même la mort. Utilisez toujours des serre-fils/connecteurs convenant au calibre et au nombre de fils utilisés. **MISE EN GARDE:** Assurez-vous qu'aucun brin de fil nu n'est exposé à l'extérieur des serre-fils/connecteurs (le cas échéant). Prenez soin de ne pas endommager ou couper la gaine isolante (recouvrement) des fils pendant l'installation. Ne laissez pas les fils entrer en contact avec des rebords coupants. N'enlevez pas les tampons d'isolation thermique. Il s'en suivrait une augmentation de la température et un risque d'incendie. Nettoyez l'intérieur de l'appareil d'éclairage avec un chiffon à dépoussiérer, n'utilisez pas d'abrasifs ou de solvants. Évitez d'utiliser des liquides sur toutes les pièces électriques. Tenez toujours compte de toutes les spécifications techniques du luminaire. Vérifiez les pictogrammes figurant sur l'étiquette d'identification du luminaire ainsi que les pictogrammes présentés à la partie A de vos consignes de sécurité. **ATTENTION:** Vous trouverez ci-dessous toutes les explications, précédées d'un numéro de référence, relatives aux pictogrammes et aux consignes de sécurité de la partie B. Les pictogrammes applicables à votre appareil d'éclairage sont présentés dans les consignes de sécurité de la partie A.

1) Ce produit doit être installé à l'intérieur seulement. 2) Ce produit convient à un usage extérieur. 3) Convient uniquement aux endroits secs. 4) Convient aux endroits humides. 5) Convient aux endroits détrempés.