

SAMSUNG

Portable SSD

Installation Guide & Warranty Statement

English / 한국어 / Français / Español / 中文 (简体) / 中文 (繁體) / 日本語 / Deutsch / Italiano /
Nederlands / Dansk / Norsk / Suomi / Čeština / Magyar / Polski / Português / Slovenčina /
Slovenščina / Türkçe / Русский / Українська / български / Hrvatski / Română / Svenska /
Eesti keel / Lietuvių / Latviski / العربية / Ελληνικά / Indonesia / Bahasa Melayu / ไทย /
Tiếng Việt

Regulatory Compliance

Legal Disclaimer

SAMSUNG ELECTRONICS RESERVES THE RIGHT TO CHANGE PRODUCTS, INFORMATION AND SPECIFICATIONS WITHOUT NOTICE.

Products and specifications discussed herein are for reference purposes only. All information discussed herein may change without notice and is provided on an "AS IS" basis, without warranties of any kind. This document and all information discussed herein remain the sole and exclusive property of Samsung Electronics. No license of any patent, copyright, mask work, trademark, or any other intellectual property right is granted by one party to the other party under this document, by implication, estoppels or otherwise. Samsung products are not intended for use in life support, critical care, medical, safety equipment, or similar applications where product failure could result in loss of life or personal or physical harm, or any military or defense application, or any governmental procurement to which special terms or provisions may apply. For updates or additional information about Samsung products, contact your nearest Samsung office. All brand names, trademarks and registered trademarks belong to their respective owners. Copyright © 2023 Samsung Electronics Co., Ltd. All rights reserved.

How to connect*

1 USB-C®

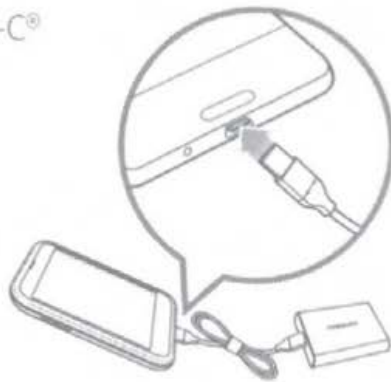

2 USB-A

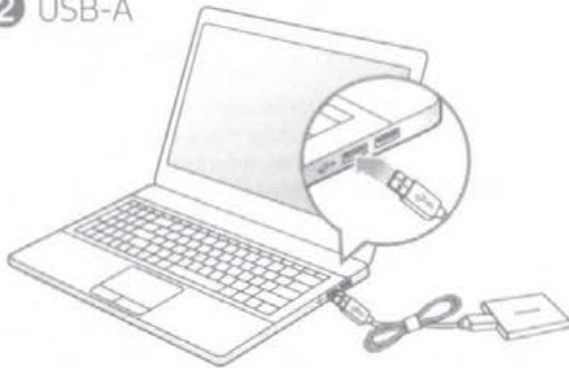

* How to connect

한국어	연결 방법	Slovenščina	Navodila za povezavo
Français	Connexion	Türkçe	Nasıl bağlanır?
Español	Cómo conectarlo	Русский	Подключение
中文(简体)	连接方式	Українська	Підключення
中文(繁體)	如何連接	Български	Как да свържете
日本語	接続方法	Hrvatski	Postupak povezivanja
Deutsch	Gerät anschließen	Română	Mod de conectare
Italiano	Come collegare	Svenska	Så ansluter du
Nederlands	Hoe te verbinden	Eesti keel	Kuidas ühendada
Dansk	Sådan opretter du forbindelse	Lietuvių	Kaip prijungti
Norsk	Hvordan koble til	Latviski	Pievienošana
Suomi	Liittäminen	العربية	كيفية الاتصال
Čeština	Postup připojení	Ελληνικά	Τρόπος σύνδεσης
Magyar	Csatlakoztatás	Indonesia	Cara menyambungkan
Polski	Jak podłączyć	Bahasa Melayu	Cara untuk menyambung
Portugués	Modo de ligação	ไทย	วิธีเชื่อมต่อ
Slovenčina	Spôsob pripojenia	Tiếng Việt	Cách kết nối

➔ <http://www.samsung.com/ssd>

Using Portable SSD

- Performance may vary depending on the user's system to which Portable SSD is connected. Even when using USB 3.2 Gen 2 connections, Portable SSD may not perform well if your system does not support UASP (USB Attached SCSI Protocol). Please make sure that your system supports UASP.
- Minimum system requirements: Windows (Windows 7 or later), Mac (OS X 10.10 or later), Android (Lollipop (Ver. 5.1) or later)
- In some operating systems, you may need to reformat your PSSD.
- Portable SSD does not contain any antivirus program. We recommend periodic inspections of your system with an antivirus program.

Connecting compatible devices

This product has been designed to be connected to a USB 3.2 Port (5Vdc, 1.5A). The use of non-complaint or incompatible devices and interface ports may result in personnel injury, damage to both devices and/or property damage. The use of incompatible USB ports or file format settings may result in poor performance or malfunction of both devices.

Impact / shock

Shock greater than 1,500 G or a drop from a height of more than 2 (for T5 EVO/T7/ T7 Touch) or 3 (T7 Shield/T9) meters may cause permanent data loss or malfunction. Disassembling or tampering with the product may result in personal injury and/or property damage.

Disassembling or tampering

The warranty is void if user disassembles, tampers with or damages products or labels. Samsung will not be responsible for any damage to the product resulting from any unauthorized modifications or repairs or replacements not performed by Samsung Electronics Service Center.

✖ No warranty is provided for any physical damage to the product including bending or deformation of the ring.

Temperature

Prolonged usage may increase device temperature. If the device feels hot to the touch, do not hold the device for a long time.

Water

Any liquid damage is not covered under warranty. If liquid comes into contact with the product, it must be completely dried before connection to avoid damage.

✖ Warranty on data

IN NO EVENT SHALL SAMSUNG'S WARRANTY EXTEND TO DATA OR OTHER INFORMATION STORED ON THE PORTABLE SSD. SAMSUNG IS NOT RESPONSIBLE FOR LOSS OF, DAMAGES TO, OR CORRUPTION OF DATA OR ANY COSTS OF RECOVERING OR REPRODUCING DATA STORED ON YOUR PORTABLE SSD.

✖ Warranty and support when password is lost

Portable SSD is equipped with advanced encryption technology whereby user data cannot be accessed if the password is lost or forgotten. In the event the password is lost or forgotten, the only solution is to have it factory reset at a service center, which will inevitably bring permanent erasure of all data. IN SUCH EVENT SAMSUNG AND ITS AGENTS ARE NOT RESPONSIBLE FOR ANY LOSS OF DATA CONTAINED ON YOUR PSSD SERVICED.

For more information, please visit <http://www.samsung.com/ssd>

For Samsung Portable-SSD Series

For the full warranty statement, please visit

<http://www.samsung.com/ssd> and <http://www.samsung.com/support>.

A. Warranty Policy

SAMSUNG warrants to the original end user customer or purchaser ("You") of this Product (including the SSD and the cable provided with the SSD) that the Product is free from defects in material and workmanship, subject to the conditions stated herein, for the shorter of: (1) a period from the date of purchase of the product in its original sealed packaging until the expiration date of the Limited Warranty Period as specified in the Product Warranty Terms & Conditions. (Refer to the entire Warranty Policy for details.) (If no proof of the date of purchase is provided, the warranty period will be considered to have started three (3) months after the date that the product was manufactured.), (2) the period ending on the date when the SSD has exceeded its TBW (Total Bytes Written) threshold as may be indicated by Samsung's Magician Software (for specific information on this threshold, please refer to the data sheet for your particular SSD product, which is available at www.samsung.com/ssd, www.samsung.com/samsungssd). Samsung will choose one of the following actions according to the terms and conditions explained in this Agreement. (1) repair or replace the Product with a new or refurbished Product of equal or greater capacity and functionality; or (2) refund the then current market value of the Product at the time the warranty claim is made to SAMSUNG if SAMSUNG is unable to repair or replace the Product. However, in the case of NTF (No Trouble Found) through a diagnosis, Your Product will be sent back to You. You should always back up any important data. This warranty is provided only to You and is not transferable.

✖ The warranty period for the enclosed cable provided with SSD is one year.

B. Warranty Limitations

The warranty stated herein shall not apply if: (i) the Product was not used in accordance with any accompanying instructions, (ii) the Product was not used for its intended function and environment, (iii) any failure or defect arose out of the presence of a third party product, software or component, whether authorized or not, (iv) any failure or defect was a result of improper installation, misuse, unauthorized repair, modification or accident, and (v) there exist any other circumstances that SAMSUNG determines is evidence of a breach of this Agreement by You. You agree that the Product shall not be used in life support systems or other applications where failure could threaten injury or life. SAMSUNG disclaims any and all liability in connection with, arising out of, or related to, any such use of the Product.

In addition, Samsung is not responsible for any cost related to the installation or uninstallation of the SSD for the purpose of upgrades or repairs and for any cost related to the data recovery as a result of such operations.

The SAMSUNG warranty also does not cover Products which SAMSUNG receives improperly packaged, altered, or physically damaged. Products will be inspected upon receipt.

For All Samsung Portable-Solid State Drive Products (Australia Only)

The content of this Warranty For All Samsung Portable-Solid State Products (Australia Only) overrides the warranty terms and conditions contained in any additional document that may be found in the packaging for these products including, but not limited to, the 'Samsung Portable – SSD Series Warranty Statement' and any relevant User Manual / Quick Guide.

WARRANTY FOR SAMSUNG PRODUCTS (AUSTRALIA ONLY) PORTABLE – SOLID STATE DRIVE

PART I GENERAL TERMS AND CONDITIONS

The Australian Competition and Consumer Act (2010) (including the Australian Consumer Law) as well as other laws in Australia guarantee certain conditions, warranties and undertakings, and give you other legal rights, in relation to the quality and fitness for purpose of Samsung products sold in Australia.

In Australia, our goods come with guarantees that cannot be excluded under the Australian Consumer Law. You are entitled to a replacement or refund for a major failure and compensation for any other reasonably foreseeable loss or damage. You are also entitled to have the goods repaired or replaced if the goods fail to be of acceptable quality and the failure does not amount to a major failure. What constitutes a major failure is set out in the Australian Consumer Law. Nothing in this Warranty purports to modify or exclude the conditions, warranties and undertakings, and other legal rights, under the Australian Competition and Consumer Act and other Australian laws. This Warranty is in addition to other rights and identifies a preferred approach to resolving warranty claims which will be quickest and simplest for all parties, subject to the exclusions, terms and conditions below.

I. Coverage and Application

- A. Samsung Electronics Australia Pty Ltd of 3 Murray Rose Avenue, Sydney Olympic Park, NSW 2127 ("Samsung") warrants that your Samsung product:
- is of acceptable quality;
 - does not have a latent defect.
- B. For the purpose of this Warranty, a "Samsung product" is a product which:
- was manufactured by or on behalf of Samsung; and
 - bears a trade mark owned or used by Samsung (generally "SAMSUNG"); and
 - was sold by an Authorised Reseller or Distributor of Samsung; and
 - was purchased in Australia;
 - but does not include any hardware or software which is packaged or sold with a Samsung product unless that is itself a Samsung product or, that item is incorporated into the Samsung product or, in the case of software, pre-loaded onto the Samsung product at the time of sale.

II. Warranty Period

- A. The period during which this Warranty is in effect will depend upon the Samsung product to which it relates. In all cases the commencement date for the period is the actual day of purchase, as reflected on the Authorised-Reseller's or Distributor's invoice / receipt provided to you. The period during which each Samsung product which is the subject of this Warranty is covered by this Warranty is identified in Part II of this Warranty, however you may have statutory rights outside of this period.

III. Warranty Claim

- A. If you consider that the Samsung product which you have purchased is not of acceptable quality, has a latent defect, or is otherwise not compliant with the conditions, warranties, undertakings, and legal rights given to you under Australian Law (for example, it appears faulty, or does not work at all or properly), you can make a claim under this Warranty.
- B. Except where an International Product Warranty has been provided with your Samsung product, warranty service will only be provided in the specific country where the Samsung product was originally purchased. For example, if you have purchased the Samsung product within Australia, warranty service will be limited to Australia only.
- C. If you purchased this product in Australia and wish to make a claim under this Warranty, you should:

contact 1300 362 603:

visit the nearest Samsung Customer Service Plaza; or
visit www.samsung.com/au.

PRODUCT ONLINE REGISTRATION

You can register your product online at www.samsung.com/au. While registration is not necessary to make a claim under this Warranty, it may assist Samsung to process any claim which you may make more quickly.

- A. When you make any claim under this Warranty it is essential that you provide a copy of your proof of purchase of the Samsung product, whether in person, by email or by fax. A claim under this Warranty is not formally made unless and until that proof of purchase is provided. This does not detract from your statutory rights.
- B. You will not be able to gain the benefit of this Warranty without making a claim. A claim must be made within the Warranty Period. This Warranty does not cover any defects not notified to Samsung within the Warranty Period, although you may have statutory rights outside of the Warranty Period.
- C. If, following receipt of a claim under this Warranty, Samsung or its agent determine that your claim in respect of a Samsung product is valid (having regard to the terms of Part II of this Warranty), and:
- (a) if the failure to comply with the warranty is not a major failure or a failure of substantial character, Samsung or its agent will either replace the Samsung product with the same or similar product or refund you the cost of a replacement, in each case depending upon what is reasonable in the circumstances and with regard to Samsung's statutory obligations and at no cost to you. Goods may be replaced by refurbished goods of the same type with equal or greater capacity and functionality; or
 - (b) if the failure to comply with the warranty is a major failure or a failure of substantial character, you may reject the goods or require Samsung to pay you compensation for any reduction in the value of the goods below the price paid or payable by you for the goods. The standard Samsung warranty periods are set out by product type in the table in Part II of this Warranty, although each claim is assessed on its own merits and you may have statutory rights outside of the Warranty Period. If Samsung provides you with either a replacement or refund, you immediately transfer ownership in the original Samsung product or part to Samsung. Any such resolution by Samsung of a claim under this Warranty by you does not otherwise detract from any other statutory rights which you might have in the circumstances, including your right to monetary compensation for a valid claim.
- D. If, following receipt of a claim under this Warranty, Samsung or its agent determine that your claim in respect of a Samsung product is invalid, Samsung may charge you for any labour, parts or transport costs incurred by Samsung or its agent in assessing your claim.

IV. Warranty Transferability

- A. This warranty is provided only to you and is not transferable, however, subsequent owners may have statutory rights to a remedy if the Product is faulty. Please keep your proof of purchase documentations, such as the original sales receipt or the relevant credit card statement. Proof of purchase is required to obtain warranty performance.
- B. In cases of authorised product or part replacement of the original purchased Samsung product, the replacement Samsung product will be subject to the remainder of the original Warranty Period. You may have statutory rights in respect of a replacement product or part outside of this period.

V. Carry-In Repairs

- A. If you wish to make a claim in relation to a Samsung product which you can reasonably transport to the nearest Samsung Customer Service Plaza or to an authorised repair service centre (as directed when you first make the claim under this Warranty), please bring, or send, that Samsung product to the nearest Samsung Customer Service Plaza or authorised service centre for assessment, the cost of which will be borne by Samsung if your claim is determined to be valid pursuant to Part I of this Warranty. Whenever possible, the product should be returned in its original carton and packaging or alternatively in packaging suitable to prevent damage to the product. Samsung will not accept responsibility for damage to the product during this transport caused by unsuitable or inadequate packing.
- B. If you believe that it is not reasonable for you to bring or send the Samsung product to a Samsung Customer Service Plaza or an authorised repair service centre, Samsung will liaise with you to determine the best way in which to inspect the Samsung product the subject of the claim under this Warranty.

VI. Warranty Exclusions

- A. This section identifies what is excluded under this Warranty.
- B. For the avoidance of any doubt, any and all warranties or conditions which are not guaranteed under the Australian Competition and Consumer Act or the Australian Competition and Consumer Regulations 2010 and which are not expressly included in this Warranty as additional warranties or conditions are excluded.
- C. This Warranty does not extend to:
- loss caused by normal wear and tear, fire, water (liquid spillage or ingress), theft, vermin or insect infestation;
 - Products that are not used for their intended function;
 - any failure or defect that arises out of the presence of a third party product, software or component, whether authorized or not;
 - any failure or defect resulting from improper installation, misuse, unauthorized repair, modification or accident;
 - any alterations, modifications, or physical damage of the Product, including but not limited to, deep scratches;
 - any alterations, modifications, or removal of any Samsung labels or barcodes on the Product;
 - Products with opened PSSD casing;
 - Products that have been tampered with or are missing tape seal or serial number;
 - cost and expenses relating to Product overhaul/assembly and data recovery for repairs and replacements; and
 - Products which have been received improperly packaged, altered or physically damaged.
- D. This Warranty does not cover damage caused by:
- misuse or abusive use of the Samsung product, including physical abuse;
 - incorrect operation or not following the operation instructions (as stated in the Product Operation Manual or manufacturer's instructions provided with the Samsung product);
 - improper installation;
 - incorrect or improper maintenance or failure to maintain the Samsung product;

- failure to clean or improper cleaning of the product;
 - incorrect voltage or non-authorized electrical connections;
 - adverse external conditions such as power surges and dips, thunderstorm activity, acts of God, acts of terrorism, damage caused by vermin, or any other act or circumstance beyond Samsung's control;
 - exposure to excessive heat, moisture or dampness;
 - exposure to abnormally corrosive conditions;
 - use of non-authorized/non-standard, defective or incompatible parts;
 - password setting/ resetting and computer virus; and
 - repair, modification or other work carried out on the Samsung product other than by Authorised Samsung Service Personnel.
- E. This Warranty does not cover Samsung products purchased in an auction.
- F. If the Samsung product you are using has been rented or leased by you, and you consider a claim might be made under this Warranty, you should refer the matter to the rental or leasing company immediately and they will handle the matter.
- G. This Warranty does not cover Samsung products which, at the time you consider a claim might be made under this Warranty, do not bear the original manufacturer's factory-applied serial number in its original form (for instance where it or the sticker bearing it has been removed, wiped out, rubbed off, or altered).
- H. This Warranty does not cover the loss of any data howsoever caused. You shall be responsible for backing up and protecting data against loss, damage or destruction. Please note that the replacement of goods will result in loss of data.
- I. This Warranty does not cover any defects not notified to Samsung within the Warranty Period, however, you may also have statutory rights outside of the Warranty Period.

PART II PRODUCT WARRANTY PERIODS AND SPECIAL CONDITIONS

- A. You agree that the Product shall not be used in life support systems or other applications where failure could threaten injury or life. SAMSUNG disclaims any and all liability in connection with, arising out of, or related to, any such use of the Product.
- B. This part of the Warranty identifies Samsung's preferred approach to resolving warranty claims.
- C. This part identify the periods under which a claim may be made under this Warranty. However, you may also have statutory rights outside of these periods.
The Warranty Period for Samsung SSD is the shorter of:
(I) a period Three (3) years for the T5, T5 EVO, T7, T7 Touch, T7 Shield and Five (5) years for the T9
(II) the period ending on the date when the SSD has exceeded its TBW (Total Bytes Written) threshold as may be indicated by Samsung's Magician Software (for specific information on this threshold, please refer to the data sheet for your particular SSD product, which is available at www.samsung.com/au/consumer/pc-peripherals/solid-state-drive)
The Warranty Period will end earlier if the SSD has exceeded its TBW (Total Bytes Written) threshold as may be indicated by Samsung's Magician Software (for specific information on this threshold, please refer to the data sheet for your particular SSD product, which is available at www.samsung.com/au/ssd/)
To the extent permitted by law and subject to the non-excludable rights under the Australian Consumer Law this is your exclusive remedy for any breach of this Agreement.
- D. SAMSUNG also recommends that all data on the Product should be backed up before being sent to SAMSUNG. This Warranty does not cover the loss of any data howsoever caused. You shall be responsible for backing up and protecting data against loss, damage or destruction. In the case of replacements, ownership of the original Product will be transferred to SAMSUNG and SAMSUNG will not return original Product to You.
- E. Service centre Information
For Service centre Information, please visit www.samsung.com/ssd.

* The warranty period for the enclosed cable provided with SSD is one year.

Certifications



Waste Electrical and Electronic Equipment

This symbol on the product or on its packaging indicates that this product must not be disposed of with your other household waste. Instead, it is your responsibility to dispose of your waste equipment by handing it over to a designated collection point for the recycling of waste electrical and electronic equipment. The separate collection and recycling of your waste equipment at the time of disposal will help to conserve natural resources and ensure that it is recycled in a manner that protects human health and the environment. For more

information about where you can drop off your waste equipment for recycling, please contact your local city office, your household waste disposal service, or the shop where you purchased the product.

For correct disposal of this product, please visit <http://www.samsung.com/weee.pdf>

FOR INDIA ONLY
For more information on safe disposal and recycling visit our website. www.samsung.com/in/support or contact our Helpline numbers-
1800 40 SAMSUNG(7267864)
1800 5 SAMSUNG(7267864)
This product is RoHS compliant.

PKG Materials

Check the information on how to properly dispose of this packaging by accessing the dedicated page via the following link (<https://www.samsung.com/it/sustainability/environment/environment-data/>) to be inserted in your browser

Français

Déchet d'équipements électrique et électronique

La présence de ce symbole sur le produit ou sur son emballage indique qu'il ne doit pas être jeté avec les déchets ménagers ordinaires. Il est donc de votre responsabilité de mettre au rebut ce composant en le remettant à un point de collecte désigné pour le recyclage des équipements électriques et électroniques. Le tri et le recyclage séparés de vos équipements usagés lors de leur mise au rebut permettent de préserver les ressources naturelles et de s'assurer que ces équipements sont recyclés dans le respect de la santé humaine et de l'environnement. Pour plus d'informations sur les points de recyclage de vos déchets d'équipements électroniques, veuillez communiquer avec le service de recyclage de votre municipalité, les services de collecte des ordures ménagères ou rapprochez-vous du revendeur auprès duquel vous avez acquis le produit. Pour en savoir plus sur la mise au rebut correcte de ce produit, rendez-vous sur le site <http://www.samsung.com/weee.pdf>

Español

Residuos de aparatos eléctricos y electrónicos

Este símbolo en el producto o en su embalaje indica que este producto no debe desecharse junto con los residuos domésticos. En su lugar, es su responsabilidad desechar el equipo en un punto de recogida designado para el reciclaje de aparatos eléctricos y electrónicos.

La recogida y el reciclaje por separado de su equipo en el momento de la eliminación le ayudarán a conservar los recursos naturales y a garantizar que se recicla de una manera que proteja la salud y el medio ambiente. Para obtener más información sobre dónde puede dejar el equipo para su reciclaje, póngase en contacto con la oficina local pertinente, el servicio de recogida de basuras de su localidad o la tienda en la que adquirió el producto. Para una eliminación correcta de este producto, visite <http://www.samsung.com/weee.pdf>

Deutsch

Korrekte Entsorgung von Altgeräten

Das Symbol der durchgestrichenen Abfalltonne auf Rädern auf einem Elektro- oder Elektronikgerät, der Verpackung, Gebrauchsanweisung oder dem Garantieschein weist darauf hin, dass das Elektro- oder Elektronikgerät nicht im unsortierten Siedlungsabfall (Hausmüll) entsorgt werden darf, sondern einer getrennten Sammlung zugeführt werden muss. Sie sind verpflichtet, dieses Gerät und Zubehöerteile einer vom Hausmüll getrennten Erfassung zuzuführen. Altbatterien und Altakkumulatoren, die nicht vom Altgerät umschlossen sind, sowie Lampen, die zerstörungsfrei aus dem Altgerät entnommen werden können, sind vor der Abgabe an einer Erfassungsstelle zerstörungsfrei vom Altgerät zu trennen.

Vertreiber von Elektro- oder Elektronikgeräten, einschließlich des Lebensmitteleinzel-, Fernabsatz- und Versandhandels, sind ab einer bestimmten Verkaufs-, Lager- bzw. Versandflächengröße gesetzlich grundsätzlich zur unentgeltlichen Rücknahme von Altgeräten verpflichtet, wenn Sie bei dem Vertreiber ein neues Gerät kaufen oder es sich um ein kleines Altgerät handelt, das bestimmte Maße nicht überschreitet. Nähere Informationen und Einzelheiten zu diesen Rücknahmemöglichkeiten und -pflichten erhalten Sie von dem jeweiligen Vertreiber.

Endnutzer einschließlich privater Nutzer wenden sich an ihren öffentlich-rechtlichen Entsorgungsträger, um in Erfahrung zu bringen, wo sie das Altgerät für eine umweltfreundliche Entsorgung zurückgeben können. Gewerblichen Endnutzern stehen zusätzliche herstellerspezifische Möglichkeiten zur Rückgabe zur Verfügung, die sie direkt beim Hersteller erfragen können.

Bitte löschen Sie vor Abgabe an einer Erfassungsstelle selbstständig alle personenbezogenen Daten auf Ihrem Gerät.

Italiano

Rifiuti di apparecchiature elettriche ed elettroniche (RAEE)

Questo simbolo riportato sul prodotto o sulla sua confezione indica che il prodotto non deve essere smaltito con i rifiuti domestici. L'utente è invece tenuto a smaltirlo consegnandolo a un punto di raccolta designato per il riciclo delle apparecchiature elettriche ed elettroniche. La raccolta separata e il riciclaggio delle apparecchiature aiutano a conservare le risorse naturali e garantiscono che il riciclaggio avvenga in modo da proteggere la salute umana e l'ambiente. Per ulteriori informazioni sui punti di raccolta delle apparecchiature destinate al riciclaggio, contattare le autorità locali, il servizio di raccolta dei rifiuti domestici o il punto vendita dove si è acquistato il prodotto. Per il corretto smaltimento di questo prodotto, visitare <http://www.samsung.com/weee.pdf>

Materiali della confezione

Verifica le informazioni su come smaltire correttamente questo imballaggio accedendo alla pagina dedicata tramite il seguente link (<https://www.samsung.com/it/sustainability/environment/environment-data/>) attraverso il tuo browser

Registration, Evaluation, Authorization and Restriction of Chemicals

For information on Samsung's environmental commitments and product specific regulatory obligations e.g. REACH visit: <https://www.samsung.com/uk/sustainability/environment/environment-data/>



FEDERAL COMMUNICATION COMMISSION (FCC) STATEMENT

This device complies with Part 15 of the FCC Rules.

Operation is subject to the following two conditions:

- (1) This device may not cause harmful interference, and
- (2) this device must accept any interference received, including interference that may cause undesired operation.

Unique Identifier: Check the label on the product.

Responsible Party: Samsung Electronics America QA Lab
19 Chapin Rd. Building D Pine Brook NJ 07058
Tel: 1-800-SAMSUNG (1-800-726-7864)

Caution: Any changes or modifications not expressly approved by the party responsible for compliance could void the user's authority to operate the equipment.

Note: This equipment has been tested and found to comply with the limits for a Class B digital device, pursuant to part 15 of the FCC Rules. These limits are designed to provide reasonable protection against harmful interference in a residential installation. This equipment generates, uses and can radiate radio frequency energy and, if not installed and used in accordance with the instructions, may cause harmful interference to radio communications. However, there is no guarantee that interference will not occur in a particular installation. If this equipment does cause harmful interference to radio or television reception, which can be determined by turning the equipment off and on, the user is encouraged to try to correct the interference by one or more of the following measures:

- Reorient or relocate the receiving antenna.
- Increase the separation between the equipment and receiver.
- Connect the equipment into an outlet on a circuit different from that to which the receiver is connected.
- Consult the dealer or an experienced radio/TV technician for help.

Innovation, Science and Economic Development Canada ICES-003 Compliance

This Class B digital apparatus complies with Canadian ICES-003. Cet appareil numérique de la classe B est conforme à la norme NMB-003.

CAN ICES-3 (B)/NMB-3(B)



KC (Korea Certification)

1. 식별부호: 제품 라벨 별도 표기
2. 상호명: 삼성전자(주)
3. 제조자/제조국가: 삼성전자(주)/대한민국
4. 제조연월: 라벨 별도 표기
5. 모델명: 라벨 별도 표기



Séparez les éléments avant de trier



Points de collecte sur www.quefairedemesdechets.fr
Privilégiez la réparation ou le don de votre appareil !

Region or Country	Service Center Name	Address	Tel.
한국 (Korea)	시머스 (주)	수원점 : 경기도 수원시 영통구 중부대로 448번길 97 삼성테크노 112호 용산점 : 서울시 용산구 청파로 20길 34 선인상가 21동 3층 211호	삼성전자 : 1588-3366 시머스 : 070-8250-2646
USA	Total Tech Solutions, Inc.	49 Commerce Road, Carlstadt, NJ 07072	1-800-SAMSUNG (1-800-726-7864)
E.U. (Europe)	Hanaro Europe BV	Florijn 8, 5751 PC Deurne, The Netherlands	DE: 06196 77 555 77 UK: 0330-SAMSUNG (726-7864) NL: 0900-SAMSUNG (726-7864) BE: 022 01 24 18 CH: 0800-SAMSUNG (726-7864) AT: 0800-SAMSUNG (726-7864) For other countries : 00800-8010-8011
中国 (China)	碧真(北京)数码技术有限公司	北京市顺义临空经济核心区裕华路28号 综合楼 A202室	三星客服 : 400-810-5858 SSD客服 : 400-652-8008
Australia	Samsung Electronics Australia	3 Murray Rose Avenue, Sydney Olympic Park NSW 2127	1300-362-603

三星电子株式会社

© 2023 Samsung Electronics Co., Ltd. 版权所有。
所有品牌和产品名称均为其各自企业的注册商标。
本手册的设计和內容如有更改，恕不另行通知。
有关更多的信息和完整的保修声明，
请访问 <http://www.samsung.com/portable-ssd>

SAMSUNG ELECTRONICS CO., LTD.

Copyright © 2023 Samsung Electronics Co., Ltd. All rights reserved.
All brand and product names are trademarks of their respective companies.
Design and contents of this manual are subject to change without notice.



VA54200201