

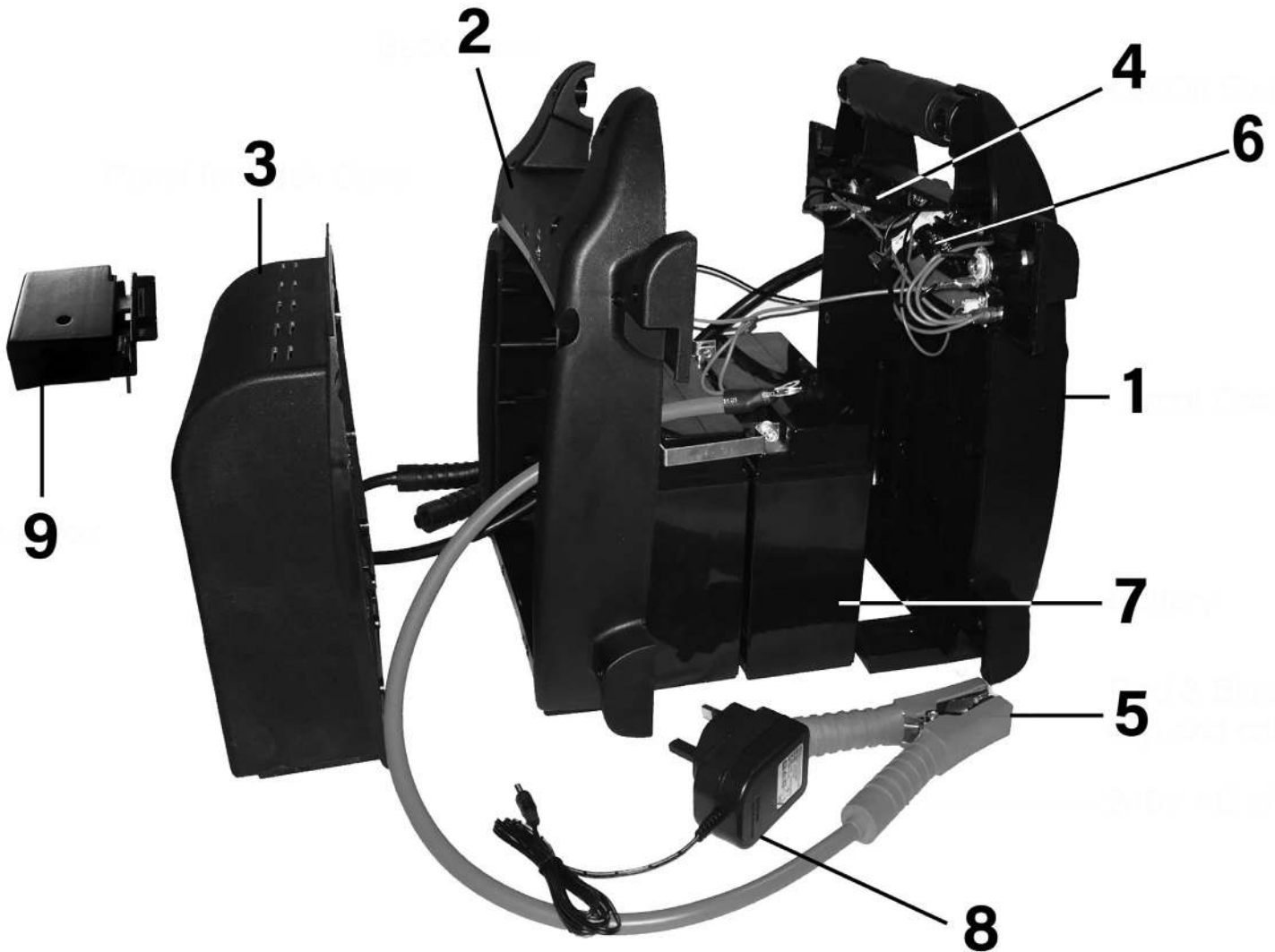

Parts Information:
**RoadStart® 12V Emergency 8-Cylinder
 Jump Starter 5L
 Model No: RS103B.V2**



Item	Part No.	Description
1	RS103B.01	Front Case
2	RS103B.02	Back Case
3	RS103B-V2-03	Panel, Fuse Box
4	RS1B.04	Switch, On/Off, Rotary (c/w Fixing Nuts)
5	RS105B-V2-05	Positive & Negative Clamp Assembly
6	RS1B.06	PCB, Circuit Board, 65 x 50mm (c/w Micro Switch x 2)

Item	Part No.	Description
7	RS103B.B	2 x Battery,12V, 19Ah/228Wh (Lead Acid)(160 x 180 x 150mm)
8	RS1B.CHARGER	Mains Charger UK 15V DC 0.8A 5mm Pin Jack
9	RS105B-V2-FB	Fuse Box
--	RS105B-V2-FUSE	Fuse (Not Shown)

NOTE: It is our policy to continually improve products and as such we reserve the right to alter data, specifications and component parts without prior notice. There may be alternative versions of this product, please contact us should you require this information.

IMPORTANT: No liability is accepted for incorrect use of product. Spare parts must be fitted by a competent person

WARRANTY: Guarantee is 12 months from purchase date, proof of which will be required for any claim.

Jack Sealey Ltd t/a Sealey Group, Kempson Way, Suffolk Business Park, Bury St Edmunds, Suffolk, IP32 7AR UK
Jack Sealey (EU) Ltd t/a Sealey Group, Farney Street, Carrickmacross, Co. Monaghan, A81 PK68 Ireland
 Tel: 01284 757500 · Email: sales@sealey.co.uk · Web: www.sealey.co.uk