

Item # 1009941256  
Model # 133A008OYS

---

# ASSEMBLY/USE CARE INSTRUCTIONS

---

## DOHERTY SOFA

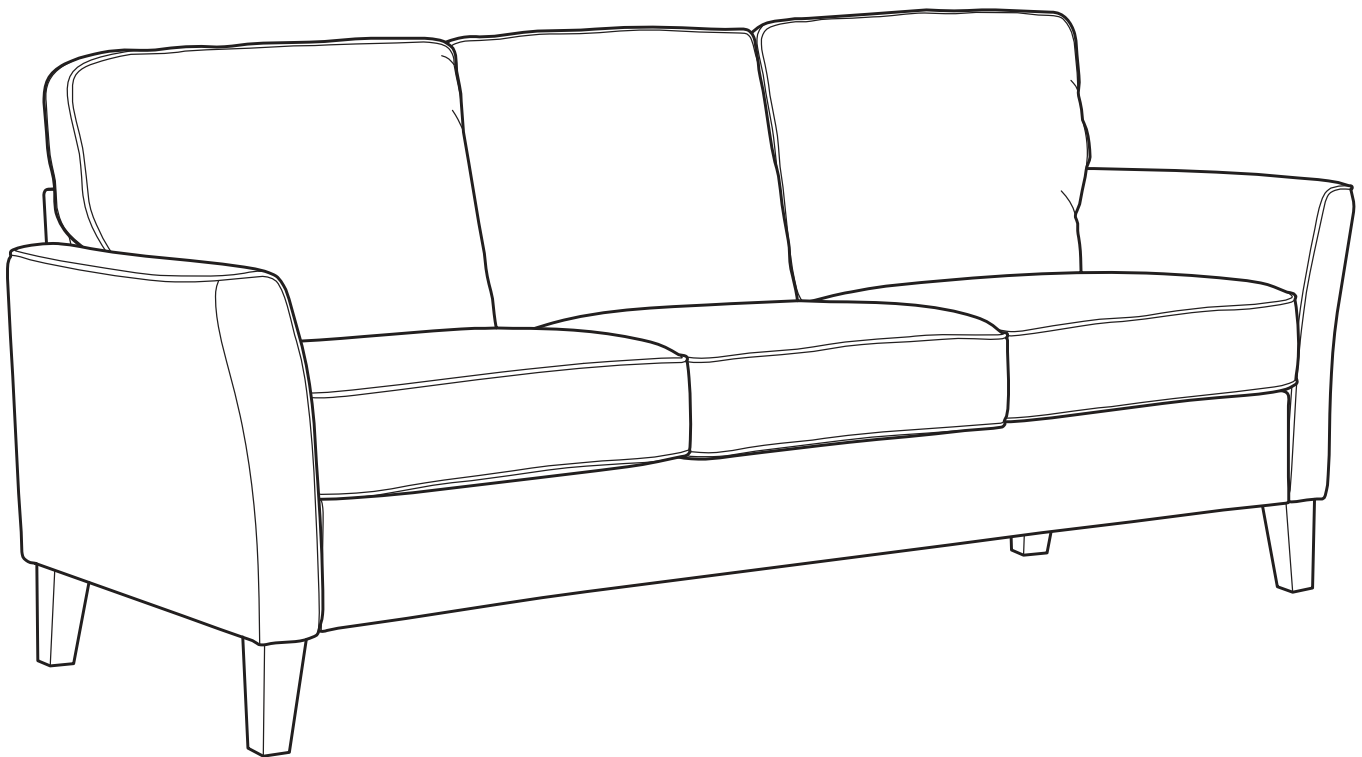

---

### **THANK YOU**

*We appreciate the trust and confidence you have placed in our product through the purchase of this DOHERTY SOFA. We strive to continually create quality products designed to enhance your home. Visit us online to see our full line of products available for your home improvement needs. Thank you for choosing DOHERTY SOFA!*

# Table of Contents

Table of Contents .....	2	Pre-assembly (continued) .....	5
Safety Information .....	2	Package Contents .....	5
Warranty .....	3	Assembly – 1 .....	6
1 Year Warranty .....	3	Assembly – 2 .....	7
What is Covered .....	3	Assembly – 3 .....	8
What is Not Covered .....	3	Assembly – 4 .....	9
Pre-assembly .....	4	Assembly – 5 .....	10
Planning Assembly .....	4	Maintenance .....	11
Tools Required .....	4	Care and Cleaning .....	11
Hardware Included .....	4	Troubleshooting .....	11
		Table .....	11

# Safety Information



## DANGER

- Keep small parts away from children during assembly.
- Read and follow instructions carefully.



## WARNING

- Read these instructions carefully and keep in a safe place.
- **TO GUARANTEE THE SAFE USE OF THIS PRODUCT, FOLLOW THE WARNINGS, GUIDELINES AND RECOMMENDATIONS IN THIS MANUAL.**
- Adult assembly required. We recommend a team of 2 for handling and assembly.
- Small parts may present choking hazard prior to assembly.
- Do not stand, step or climb on unit.



## CAUTION

- Do not use power tools to assemble your furniture. Power tools may strip or damage parts/product.
- Do not overtighten connectors (screws, bolts, etc.). Overtightening can lead to product damage.
- Be sure to check all packing materials carefully for small parts that may have come loose inside the carton during shipment. If parts are missing, contact the store to obtain any missing parts.
- **DO NOT USE SUBSTITUTE PARTS.**
- This product should only be used on a flat, level surface.
- Product is designed to hold on three average adults. Exceeding this limit may damage the product or cause injury to the user.
- This product is designed for home use and not intended for commercial use.

# Warranty

---

## 1 YEAR WARRANTY

### WHAT IS COVERED

We guarantee this product to be free of manufacturing defects to the original purchaser for one year from original date of purchase.

Our products carry a one-year limited warranty pursuant to the terms set forth herein. This warranty is valid only to the original purchaser with proof of purchase, and constitutes the original purchaser's sole and exclusive remedy. Pursuant to this warranty. We warrant that all products sold pursuant to this Agreement shall be free of any defects in parts and workmanship if used under normal operating conditions.

**THIS IS THE ONLY WARRANTY MADE BY US. IT IS MADE EXPRESSLY IN LIEU OF ALL IMPLIED WARRANTIES OF MERCHANTABILITY OR FITNESS FOR ANY PARTICULAR PURPOSE.**

Should any parts or workmanship prove defective, we will, at our discretion, either repair or replace the product at no charge (parts only) to the original purchaser for the duration of the product's full warranty.

At all times, we reserve the right to substitute materials with that of a similar quality if the original material is not available. We will not be responsible for any freight charges incurred in repairing or replacing products.

### WHAT IS NOT COVERED

This warranty does not cover commercial use, acts of nature, and abusive use.

**WE DO NOT WARRANT DAMAGE DUE TO MISUSE OR NEGLIGENCE.** This remedy is the original purchaser's **SOLE AND EXCLUSIVE REMEDY** under the Contract of Sale, and in no event shall consequential damages be recovered by the original purchaser. This warranty gives you specific legal rights, and you may also have rights which vary from state to state.

# Pre-assembly

## PLANNING ASSEMBLY

Ensure you have all parts and hardware required before you start the assembly.

Placing all parts on a clean cloth is recommended to prevent damaging the parts.

Put all hardware or small part in one place to avoid you missing or losing them during assembly.



**NOTE:** You can prepare other tools or equipment that is deemed necessary besides those listed below.

## TOOLS REQUIRED



Safety goggles



Gloves

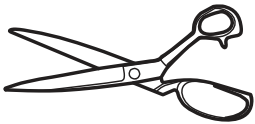

Scissors

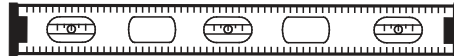

Level

## HARDWARE INCLUDED



**NOTE:** Hardware not shown to actual size.



AA

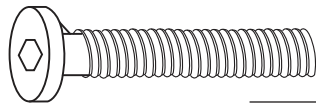

BB

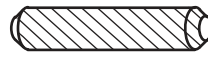

CC

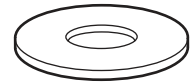

DD

Part	Description	Quantity
AA	Allen Wrench M5 x 50 x 100mm	1
BB	Bolt $\varnothing 5/16''$ x 100mm	4
CC	Wood Plug M10 x 40mm	4
DD	Washer $\varnothing 5/16''$ x 19mm	4

# Pre-assembly (continued)

## PACKAGE CONTENTS

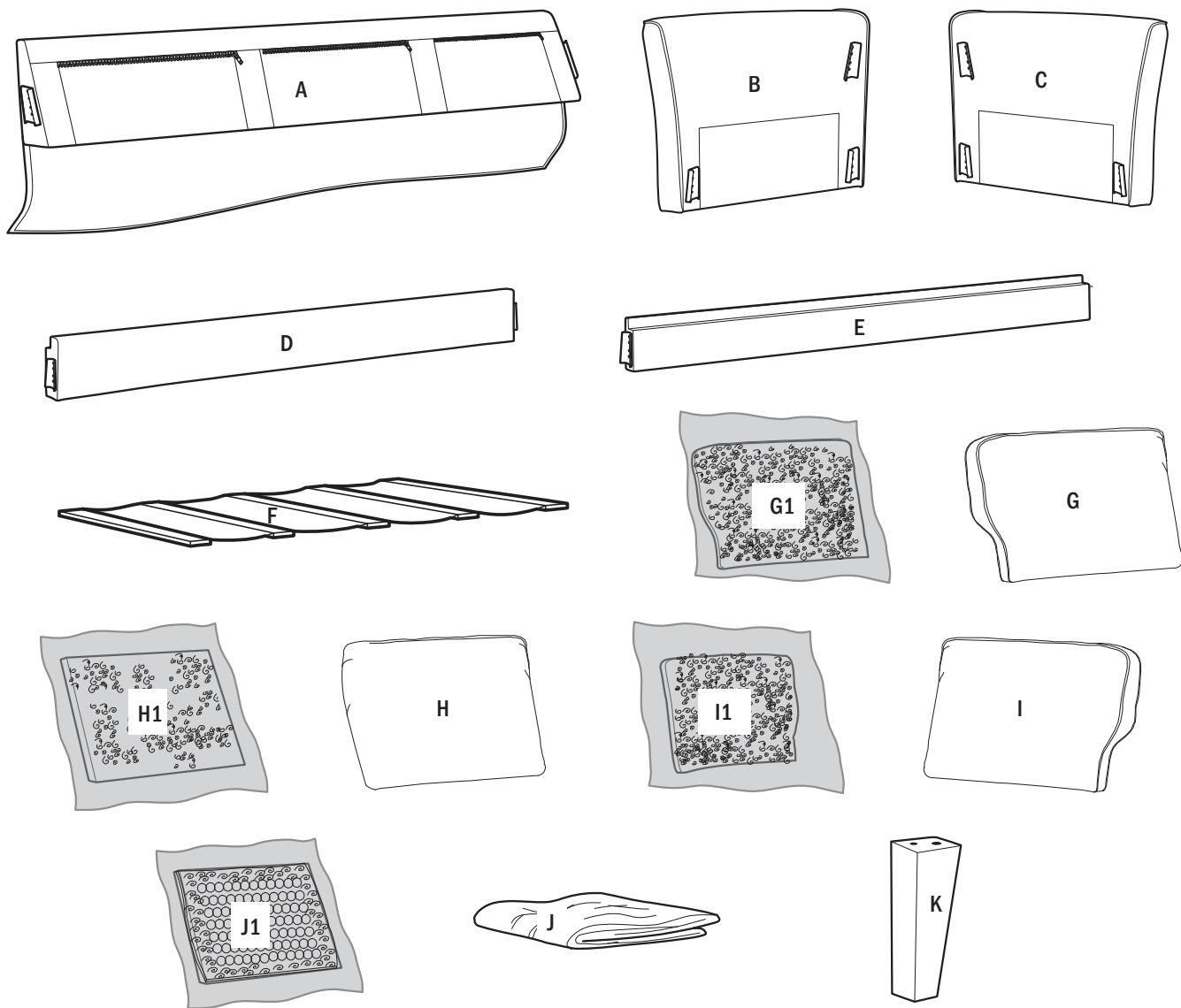

Part	Description	Quantity
A	Back Deck	1
B	Left Facing Arm	1
C	Right Facing Arm	1
D	Front Rail	1
E	Back Rail	1
F	Slats	2
G1	Left Facing Back Cushion	1

Part	Description	Quantity
G	Left Facing Back Cushion Cover	1
H1	Centre Back Cushion	1
H	Centre Back Cushion Cover	1
I1	Right Facing Back Cushion	1
I	Right Facing Back Cushion Cover	1
J1	Seat Cushion	3
J	Seat Cushion Cover	3
K	Leg	4

# Assembly

## 1 Opening the compressed pack cushion

- Prepare part G1, H1, I1 and J1
- Carefully cut the plastic bag one by one. First open the outer bag then the inner bag.
- Put aside to let it expand.



**NOTE:** When cutting the plastic bag, ensure that you're not accidentally cut the cushions.

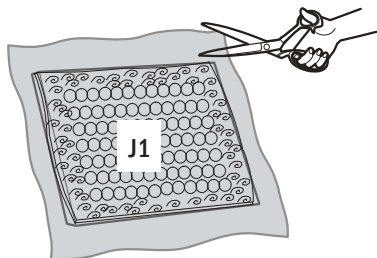
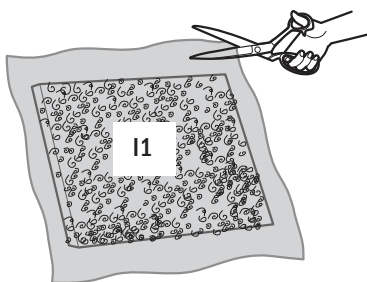
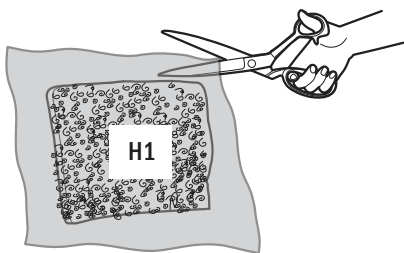
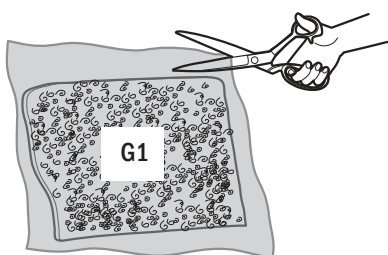

## 2 Fixing the leg

- Lay down part B and part C as shown in the diagram on a clean surface cloth, ensuring no debris or anything that can damage the product.
- Fix the legs (part K) as shown.

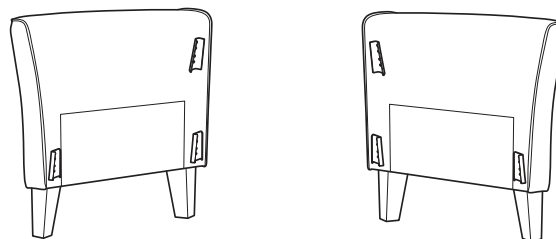
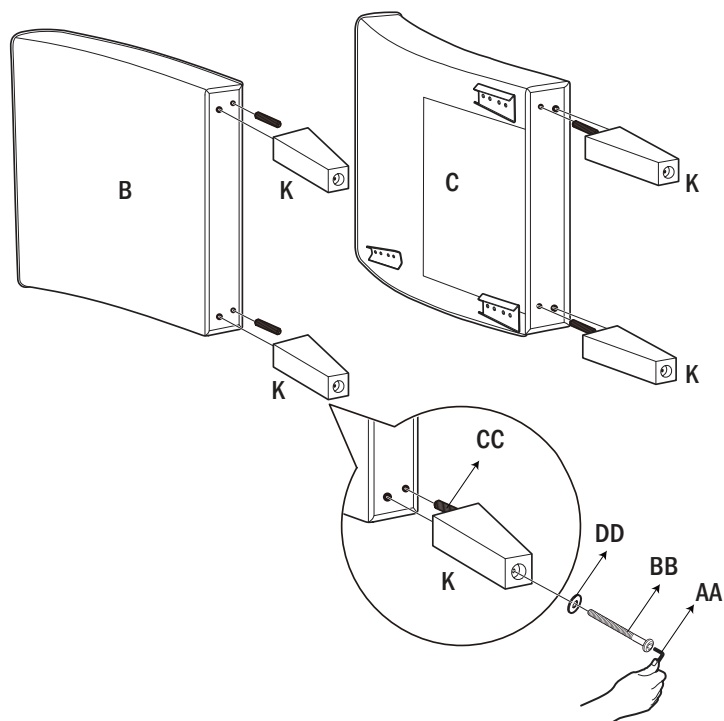

## Assembly (continued)

### 3 Attaching the rails to the arms

- Prepare part D and part E.
- First, ensure both arms are aligned before locking in the metal bracket on part E to a bracket on the arms.
- Do the same for part D, as shown in the diagrams below.



**NOTE:** Two people must do it simultaneously to ensure all brackets are perfectly attached.

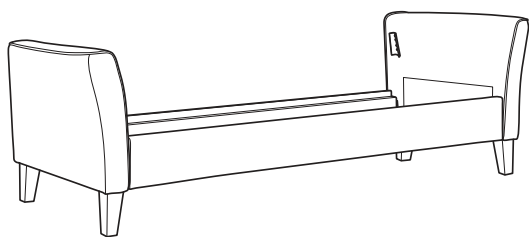
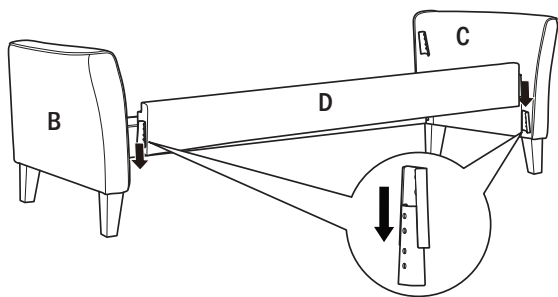
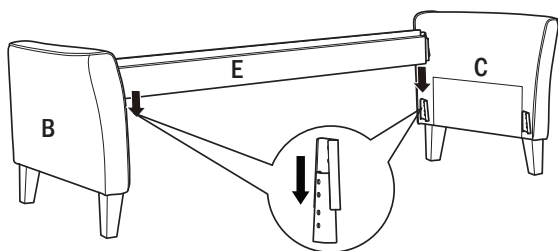

### 4 Attaching back deck and slats

- Prepare part A and two sets of part F.
- Ensure both arms are aligned before locking in the metal bracket on part A to a bracket on the arms.
- Secure the back cover as shown
- And lay down the slats (part F) on to ledger strip.



**NOTE:** Two people must do it simultaneously to ensure all brackets are perfectly attached.

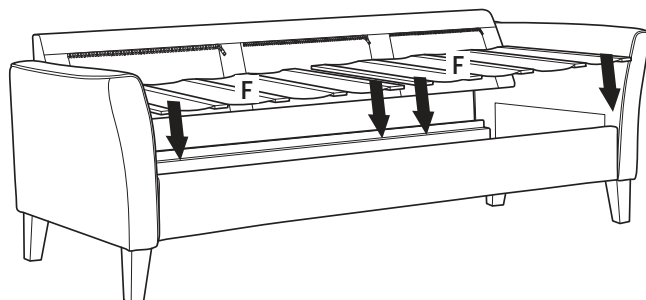
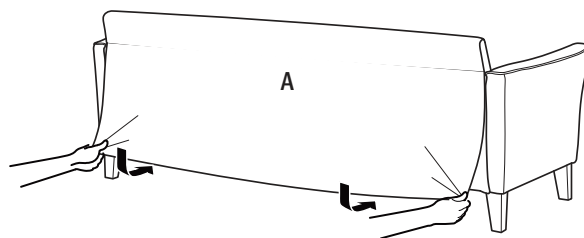
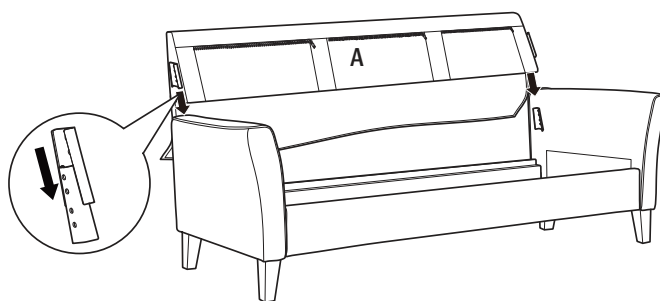

## Assembly (continued)

### 5 Filling in the compressed cushion to the part G cover

- Prepare part G1 that have already expanded.
- Unfold the left facing back cushion cover (part G), and unzip the zipper
- Slip in the cushion and secure by close the zipper as shown.



**NOTE:** Ensure the cushion goes through to all space by slightly pushing it in.  
To remove unwanted wrinkles, steam the covers before placing the cushions inside. Steam the inside of the cover on low heat (110°F). DO NOT iron the fabric on the side with pile.

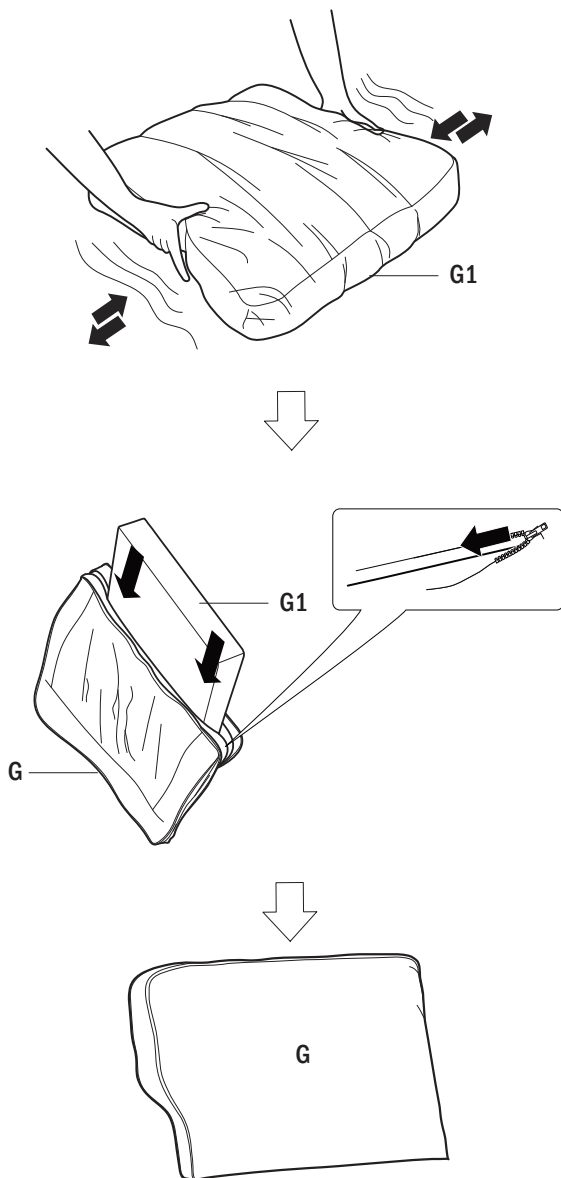

### 6 Filling in the compressed cushion to the part H cover

- Prepare part H1 that have already expanded.
- Unfold the centre back cushion cover (part H), and unzip the zipper
- Slip in the cushion and secure by close the zipper as shown.



**NOTE:** Ensure the cushion goes through to all space by slightly pushing it in.  
To remove unwanted wrinkles, steam the covers before placing the cushions inside. Steam the inside of the cover on low heat (110°F). DO NOT iron the fabric on the side with pile.

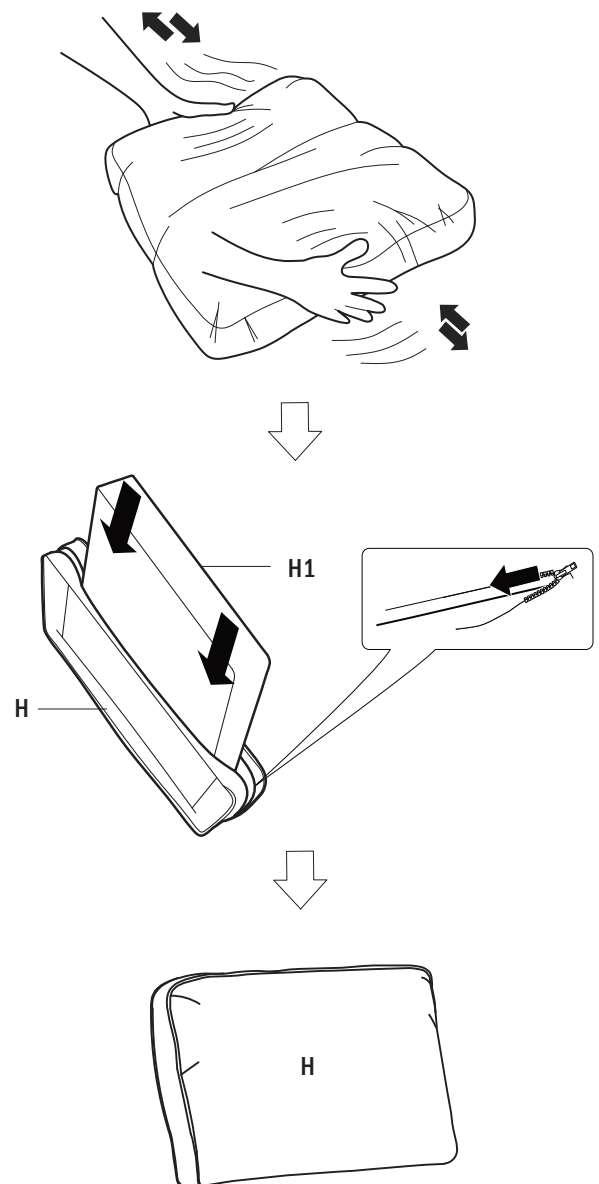

## Assembly (continued)

### 7 Filling in the compressed cushion to the part I cover

- Prepare part I1 that have already expanded.
- Unfold the right facing back cushion cover (part I), and unzip the zipper.
- Slip in the cushion and secure by close the zipper as shown.



**NOTE:** Ensure the cushion goes through to all space by slightly pushing it in.

To remove unwanted wrinkles, steam the covers before placing the cushions inside. Steam the inside of the cover on low heat (110°F). DO NOT iron the fabric on the side with pile.

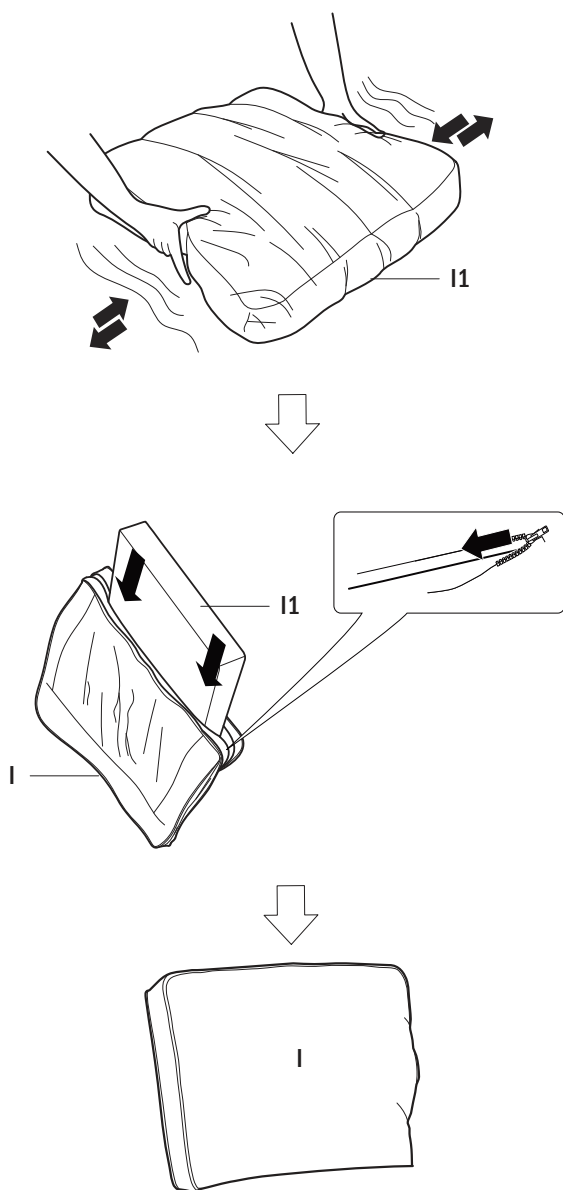

### 8 Filling in the compressed cushion to the part J cover

- Prepare part J1 that have already expanded.
- Unfold the seat cushion cover (part J), and unzip the zipper.
- Slip in the cushion and secure by close the zipper as shown.



**NOTE:** Ensure the cushion goes through to all space by slightly pushing it in.

To remove unwanted wrinkles, steam the covers before placing the cushions inside. Steam the inside of the cover on low heat (110°F). DO NOT iron the fabric on the side with pile.

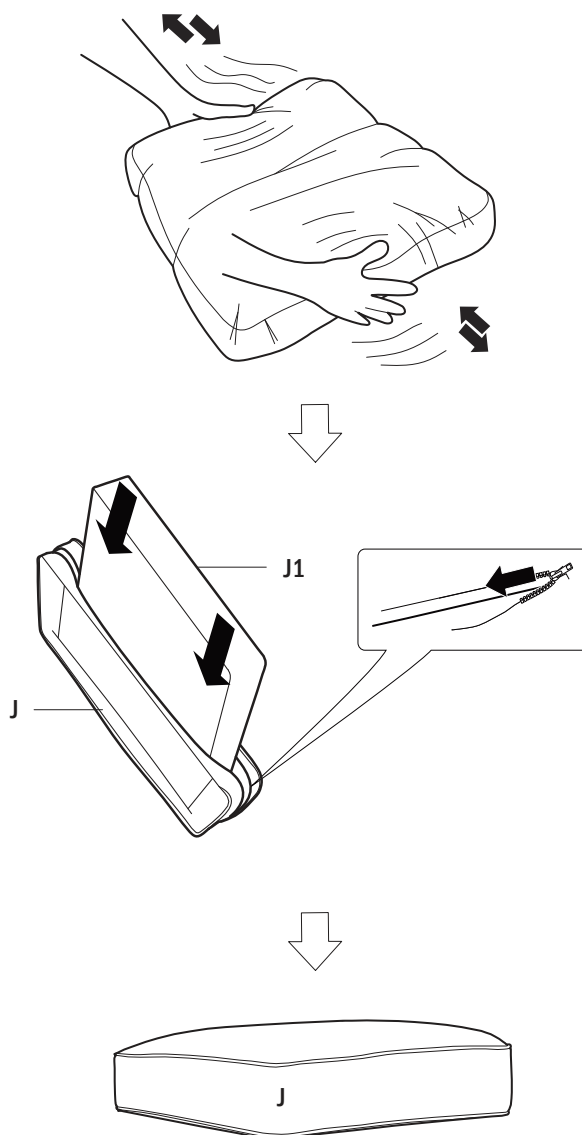

## Assembly (continued)

### 9 Make the seat and back cushion expand evenly

- To expand the cushion evenly, we should push and stretch the cushion as shown.



**NOTE:** Seat and back cushions may take 3-4 days to fully expand, which will allow wrinkles and indentations caused by packing to fade.



### 10 Attaching the back cushions

- Prepare all of the back and seat cushion (part G, H, I and J)
- Lay down part J on to slats then,
- Secured the back cushions use the zipper provided as shown in the diagram.



**NOTE:** Ensure the zipper head is fully lock in before you zipped it up to avoid breaking the zipper.

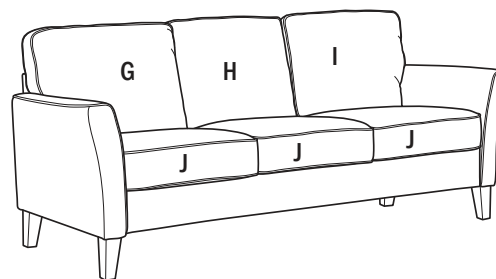
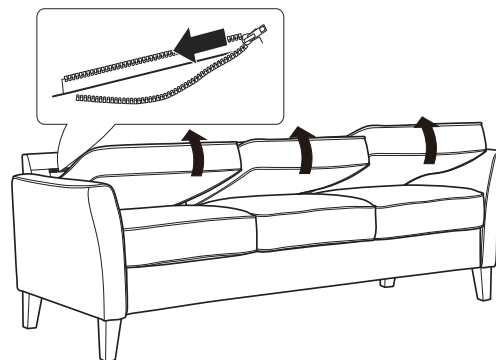
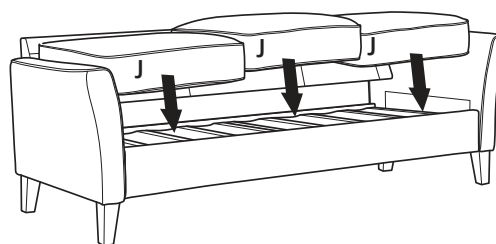

## Maintenance

- To keep your DOHERTY SOFA looking its best, dust frequently and gently with a soft, non-abrasive cloth. Do not use harsh chemicals or abrasive cleaners as they can damage and ruin your sofa. Regularly vacuuming will reduce the amount of dust and debris in the fibers and keep your DOHERTY SOFA neat and clean. Therefore, prolong the life of your sofa by regularly vacuuming low suction. If pilling occurs, we recommend a simple battery-operated pilling tool to remove them.

## Care and Cleaning

- Spot cleaning. Treat spills and stains as soon as possible. Gently scrape off any dirt or mop any liquid from the surface.
- Always apply cleaning agents to a clean cloth first, not directly to the surface of the fabric. This method will help prevent stains from funneling into the textures or patterns of the fabric.
- Use a water-based upholstery cleaner, then wipe with a slightly damp cloth and pat dry. For best results, consider cleaning entire fabric panels this way.
- Avoid heat. Do not place your DOHERTY SOFA near heating vents or heating items to avoid moisture buildup and possible burn marks and burns.
- Avoid direct sunlight. UV rays will fade any colored fabrics, so keep them out of direct sunlight whenever possible.

## Troubleshooting

**TABLE**

Step	Problem	Possible reason	Solution
1	The non-woven fabric is tearing apart.	Accidentally cut the non-woven while cutting the plastic bag.	Call customer service for replacement. Additional cost may occur.
3 & 4	The back frame or rails keeps falling or not aligned.	The bracket is not fully lock-in.	Detach the back frame or rails, then fix it back. Ensure you hold the arm while moving the items.