

# **VEVOR**

**Affordable. Reliable. Home Improvement.**

**Entry Door Knobs**

**Instruction Manual**

**MODEL: 209BK-MB-6PK、 587ET-SS-1PK**

# VEVOR

Affordable. Reliable. Home Improvement.

## Entry Door Knobs

**MODEL: 209BK-MB-6PK**



**MODEL: 587ET-SS-1PK**



★ The picture is for reference only, please refer to the actual.

This is the original instruction, please read all manual instructions carefully before operating. VEVOR reserves a clear interpretation of our user manual. The appearance of the product shall be subject to the product you received. Please forgive us that we won't inform you again if there are any technology or software updates on our product.



Warning-To reduce the risk of injury, user must read instructions manual carefully.

## Installation tools

### Tools Required for Replacement Installation

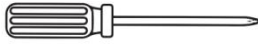

Phillips Screwdriver

### Extra Tools Required for New Installation



Measuring Tape

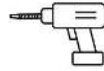

1" Hole Boring Bit

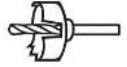

2 1/8" Hole Boring Saw

Additional tools(if needed): chisel, hammer, pencil, safety glasses.

## Installation Instructions

### (1) Drill Holes

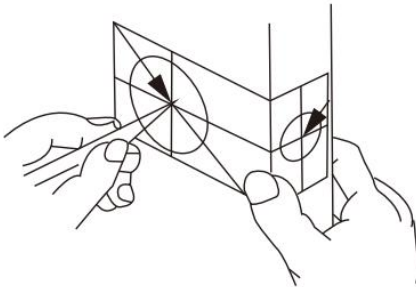

- Fold the template at the dotted line and tape the template to the interior side of the door at 34 to 48 inch Height.
  - Measure the thickness of the door and mark the middle point of the door thickness.
  - Mark the (60 or 70mm) hole center for the backset.
- Note:** Make sure the two dots are at the same height.

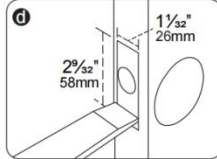
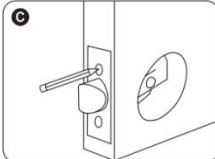
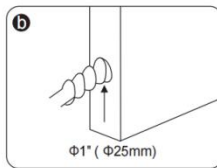
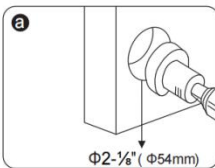

- Drill a Dia. (54mm) hole for the lock body.
- Drill a Dia. (25mm) hole for the latch.
- Insert the latch into the hole and mark the outline of the faceplate.
- Chisel a (3mm) deep hole for the faceplate.

## (2) Installation Instructions

### 1. Install the latch

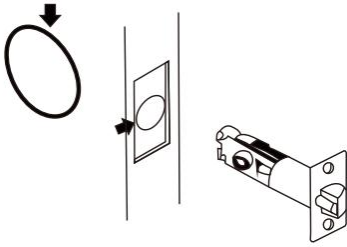

1. Install deadbolt latch in "up" position into door hole.
2. Insert and secure with screws.

### 2. Install Striking Plate

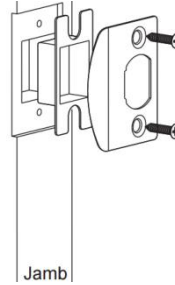

- Striking Plate against strike as illustrated, preventing forcing when door is closed.

### 3. Install Outside Knob Unit

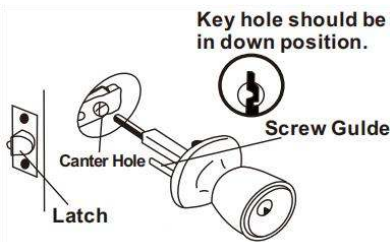

- Install outside knob unit with screw guides, locking bar and spindle engaged into latch as illustrated.

### 4. Install Inside Knob Unit.

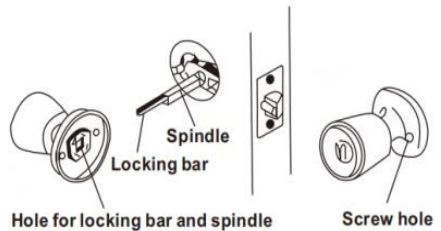

1. Engage screw guides, locking bar and spindle into inside unit..
2. Insert screws and tighten securely.

## Note

### (1) Instructions For Adjustable Latch

For the adjustable latch, latch hole should be 1"(25mm)dia, and according to centers of drilled 2-1/8"(54mm)dia, lockset hole. For either 2-3/8"(60mm) or 2-3/4"(70mm) backset. The method of adjustment is illustrated below:

①The turning wheel is pushed fully to the left for 2-3/8"(60mm) backset.

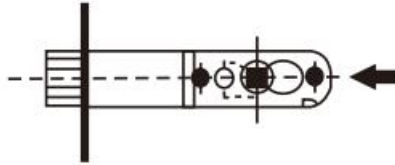

②The turning wheel is pushed fully to the right for 2-3/4"(70mm) backset.

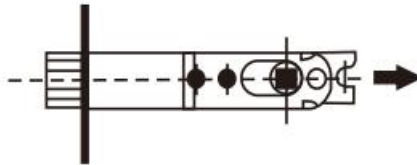

★ During the adjustment as above, Keeping two teeth of the turning wheel to forward first.

## Maintenance

- 1.Do not strike with force to avoid damage to the latch and door frame.
- 2.If there is dirt, use a dry cloth to remove, do not scrub with chemicals such as dishwashing liquid. Otherwise, it will destroy the protective film of exposed parts and cause fading.
- 3.Periodically (half a year or once a year) or when the key is not smoothly inserted and removed, graphite powder (pencil powder) can be added in the keyhole to lubricate.

## Product Parameter

<b>Model</b>	<b>209BK-MB-6PK</b>	<b>587ET-SS-1PK</b>
<b>Adjustable latch</b>	<b>2-3/8 to 2-3/4</b>	<b>2-3/8 to 2-3/4</b>
<b>Door Thickness</b>	<b>1-3/8 to 1-3/4</b>	<b>1-3/8 to 1-3/4</b>
<b>Colour</b>	<b>Black</b>	<b>Silvery</b>
<b>Material</b>	<b>201 Stainless Steel Zinc Alloy Zinc-Coated copper</b>	<b>201 Stainless Steel Zinc Alloy Zinc-Coated copper</b>

**Sanven Technology Ltd.**

**Address: Suite 250, 9166 Anaheim Place, Rancho Cucamonga,  
CA 91730**

