

## My 1st Gym Kit



**VTech understands that a child's needs and abilities change as they grow and with that in mind we develop our toys to teach and entertain at just the right level...**

## **vtech** Baby

**Toys that will stimulate their interest in different textures, sounds and colours**

### **I am...**

...responding to colours, sounds and textures

...understanding cause and effect

...learning to touch, reach, grasp, sit-up, crawl and toddle

*Birth-36 months*



## **Pre-School**

**Interactive toys to develop their imagination and encourage language development**

### **I want...**

...to get ready for school by starting to learn the alphabet and counting

...my learning to be as fun, easy and exciting as can be

...to show my creativity with drawing and music so my whole brain develops

*3-6 years*



## **Electronic Learning Computers**

**Cool, aspirational and inspiring computers for curriculum related learning**

### **I need...**

...challenging activities that can keep pace with my growing mind

...intelligent technology that adapts to my level of learning

...National Curriculum based content to support what I'm learning at school

*4-10 years*



To learn more about this and other VTech® products, visit [www.vtech.co.uk](http://www.vtech.co.uk)

# INTRODUCTION

**My 1st Gym Kit by VTech®** is a great way for little ones to get their groove on. The music player, textured fitness ball, water bottle, sport towel and dumbbell support physical development, as well as encourage role play. The number buttons on the interactive phone introduce the four fitness objects, numbers and colours. The LED button play melodies and encourages your little one to get moving.

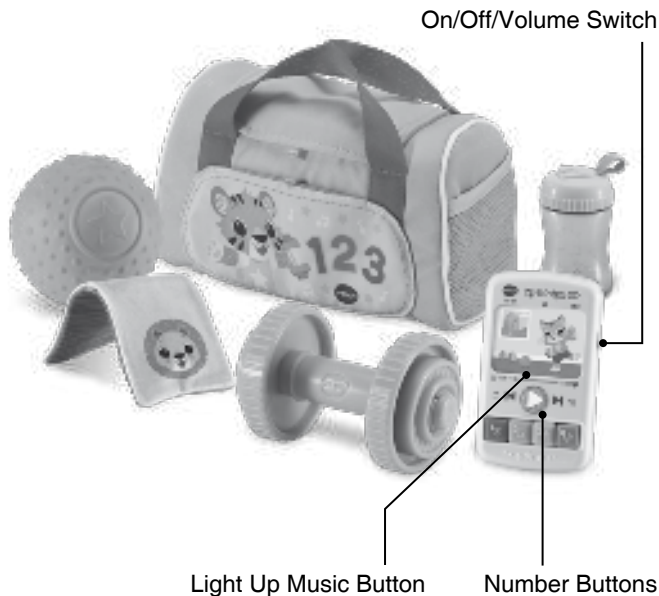

# INCLUDED IN THE PACKAGE

- My 1st Gym Kit
- Music Player
- Textured Fitness Ball
- Water Bottle
- Sport Towel
- Dumbbell
- Parent's Guide

## WARNING

All packing materials, such as tape, plastic sheets, packaging locks, removable tags, cable ties, cords and packaging screws are not part of this toy, and should be discarded for your child's safety.

## NOTE

Please keep this Parent's Guide as it contains important information.

### Removing the Packaging Locks:

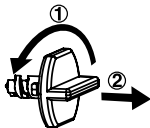

- ① Rotate the packaging locks anticlockwise 90 degrees.
- ② Pull out the packaging locks and discard.

## NOTE

Please cut and discard the cable ties that attach the **My 1st Gym Kit** to the box. The cable ties are not part of this toy and should be discarded for your child's safety.



# GETTING STARTED

## Battery Removal and Installation

1. Make sure the unit is turned **OFF**
2. Find the battery cover located on the back of the music player. Use a screwdriver to loosen the screw and then open the battery cover.
3. If used batteries are present, remove these batteries from the unit by pulling up on one end of each battery.
4. Install 2 new AAA batteries following the diagram inside the battery box. (The use of new alkaline batteries is recommended for maximum performance).
5. Replace the battery cover and tighten the screw to secure.

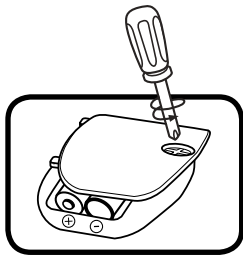

### **WARNING:**

Adult assembly required for battery installation.  
Keep batteries out of reach of children.

### **IMPORTANT: BATTERY INFORMATION**

- Insert batteries with the correct polarity (+ and -).
- Do not mix old and new batteries.
- Do not mix alkaline, standard (carbon-zinc) or rechargeable batteries.
- Only batteries of the same or equivalent type as recommended are to be used.
- Do not short-circuit the supply terminals.
- Remove batteries during long periods of non-use.
- Remove exhausted batteries from the toy.
- Dispose of batteries safely. Do not dispose of batteries in fire.

### **RECHARGEABLE BATTERIES:**

- Remove rechargeable batteries from the toy before charging.
- Rechargeable batteries are only to be charged under adult supervision.
- Do not charge non-rechargeable batteries.

## Disposal of batteries and product



The crossed-out wheellie bin symbols on products and batteries, or on their respective packaging, indicates they must not be disposed of in domestic waste as they contain substances that can be damaging to the environment and human health.

The chemical symbols Hg, Cd or Pb, where marked, indicate that the battery contains more than the specified value of mercury (Hg), cadmium (Cd) or lead (Pb) set out in Battery Directive (2006/66/EC).



The solid bar indicates that the product was placed on the market after 13th August, 2005.

Help protect the environment by disposing of your product or batteries responsibly.

VTech® cares for the planet.

Care for the environment and give your toy a second life by disposing of it at a small electricals collection point so all its materials can be recycled.

In the UK:

Visit [www.recyclenow.com](http://www.recyclenow.com) to see a list of collection points near you.



In Australia & New Zealand:

Check with you local council for kerbside collections.

## PRODUCT FEATURES

### 1. On/Off/Volume Switch

To turn the unit **On**, slide the **On/Off/Volume Switch** to the **Low volume**

 or the **High volume**  position.

You will hear a phrase and a song.

To turn the unit **Off**, slide the **On/Off/Volume Switch** to the **Off**  position.

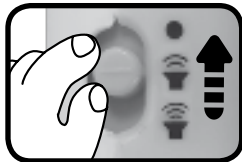

## 2. Automatic Shut-Off

To preserve battery life, the **Music Player** will automatically shut after each audio response. The unit can be turned on again by pressing any button or by sliding the **On/Off/Volume Switch**.

## NOTE

This product is in Try-Me mode in the packaging. After opening the package, turn the **Music Player** off and on again to proceed with normal play. If the unit powers down or if the light fades out during play, please install a new set of batteries.

## ACTIVITIES

### 1. Number Buttons

Press the **Number Buttons** to learn about fitness tools, numbers and colours.



### 2. Light Up Music Button

Press the **Light Up Music Button** to hear upbeat songs and music for exercising and relaxing music for cooling down. The light will flash with the sounds.



## MELODY LIST

1. Keep Moving
2. Stay on Beat
3. Let's Go!
4. One, Two, Buckle My Shoe
5. Pat-a-Cake

6. Pease Porridge Hot
7. Row, Row, Row Your Boat
8. Skip to my Lou
9. Teddy Bears' Picnic
10. Bingo
11. The Alphabet Song
12. The Bear Went Over the Mountain
13. Three Little Kittens
14. The Wheels on the Bus
15. Bicycle Built for Two
16. Boys and Girls Go Out to Play
17. Baby Bunting
18. A-Tisket, A-Tasket
19. Did You Ever See a Lassie?
20. Green Grass Grew All Around

## **SONG LYRICS**

### **Song 1**

Jumping, grooving and dancing.  
Rolling, moving and spinning.  
Will all help you stay healthy,  
And keep you energised!

### **Song 2**

One, raise your hands up.  
Two, wiggle your feet out.  
Three and four, move about.  
Exercising with you is fun!

### **Song 3**

One and two and three and four.  
Move your body, go, go, go!

# CARE & MAINTENANCE

1. Keep the unit clean by wiping it with a slightly damp cloth.
2. Keep the unit out of direct sunlight and away from any direct heat sources.
3. Remove the batteries if the unit will not be in use for an extended period of time.
4. Do not drop the unit on hard surfaces and do not expose the unit to moisture or water.

# CONSUMER SERVICES

Creating and developing **VTech®** products is accompanied by a responsibility that we at **VTech®** take very seriously. We make every effort to ensure the accuracy of the information, which forms the value of our products. However, errors sometimes can occur. It is important for you to know that we stand behind our products and encourage you to call our Consumer Services Department with any problems and/or suggestions that you might have. A service representative will be happy to help you.

## **UK Customers:**

Phone: 0330 678 0149 (from UK) or +44 330 678 0149 (outside UK)

Website: [www.vtech.co.uk/support](http://www.vtech.co.uk/support)

## **Australian Customers:**

Phone: 1800 862 155

Website: [support.vtech.com.au](http://support.vtech.com.au)

## **NZ Customers:**

Phone: 0800 400 785

Website: [support.vtech.com.au](http://support.vtech.com.au)

# PRODUCT WARRANTY/ CONSUMER GUARANTEES

## **UK Customers:**

Read our complete warranty policy online at [vtech.co.uk/warranty](http://vtech.co.uk/warranty).

## **Australian Customers:**

### VTECH ELECTRONICS (AUSTRALIA) PTY LIMITED – CONSUMER GUARANTEES

Under the Australian Consumer Law, a number of consumer guarantees apply to goods and services supplied by VTech Electronics (Australia) Pty Limited. Please refer to [vtech.com.au/consumerguarantees](http://vtech.com.au/consumerguarantees) for further information.

**Visit our website for more  
information about our products,  
downloads, resources and more.**

***www.vtech.co.uk***  
***www.vtech.com.au***

